

Brushless DC Motor - 22 mm Ø



B22E24BZ040

5.2 Watts Peak Power

Global Motion Products

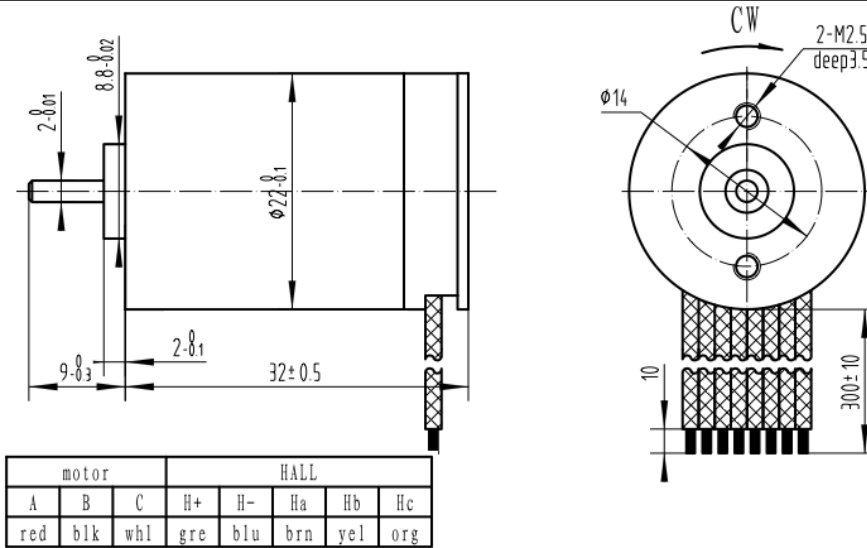

Dimensions in mm
Not to Scale

Nominal voltage	24.0 Volts
No-load speed	16,000 rpm
Stall torque	13.7 mNm
No-load current	0.090 Amps
Peak Output power	5.2 Watts

Torque constant	13.09 mNm/A
Terminal resistance	23.00 Ohms
Back-EMF constant	1.37 V/krpm
Winding inductance	1.000 mH

Slope of speed/torque curve	1,171.5 rpm/mNm
Maximum Efficiency	50 %
Motor Constant	2.73 mNm/Sqrt Watt

Commutation Type	Electronic - Hall Effect
------------------	--------------------------

Radial Load Rating	24.0 N	Radial Play	0.015 mm	Max Temperature	85 °C
Radial Load Distance	7 mm	Thrust Play	0.200 mm	Min Temperature	-35 °C
Axial Load	24.00 N	Magnet Type	NdFeB	Max Winding Temp	125 °C
Press Fit Force - Max	60.00 N	Bearing Type	Ball Bearings	Mass	91 grams
Gearbox Options	Planetary P22 Series				
Encoder Options	Contact GMP				
Options - Other	Windings, special shafts, sensorless version, lubrication, connectors.				

Global Motion Products

Distributed by:

Precision Motion Distributors: (925) 803-9565

Technical Support: (760) 451-2723

http://www.gmpwebsite.com Email: info@gmpwebsite.com

RoHS Compliant

A - January 2011

Specifications Subject to change without notice