

Gearmotor - Coreless - 6 mm Ø

A06••••DC10

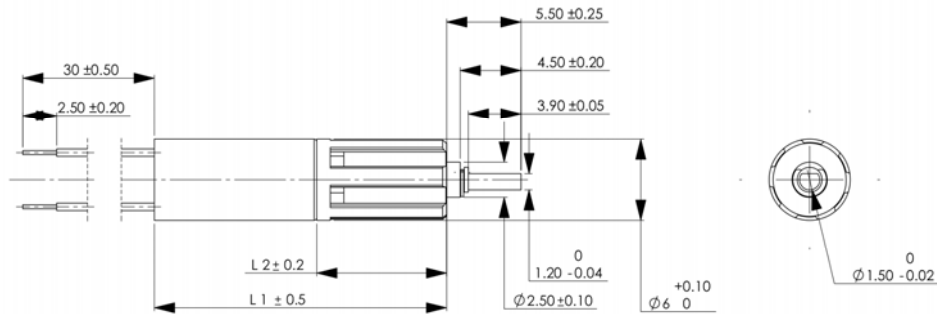

Global Motion Products



Ratio	Voltage Volts	Efficiency %	No Load Speed rpm	No Load Current Amps	Rated Torque mNm	Length L1 mm	Mass grams	Direction of Rotation*	Order Part Number
5:1	3.0 Volts	90 %	1,946 rpm	0.010 Amp	0.39 mNm	22.60 mm	2.0 grams	Same	A060005DC10
26:1	3.0 Volts	80 %	378 rpm	0.010 Amp	1.57 mNm	24.40 mm	2.1 grams	Same	A060026DC10
136:1	3.0 Volts	70 %	74 rpm	0.010 Amp	5.88 mNm	26.20 mm	2.2 grams	Same	A060136DC10

Bearing Type POM Sleeve

Options: Gears, Compound Gears, Worm Gear on Output Shaft. Connector on Leads. Shaft Material.

* Rotational Sense of Gearbox Output Shaft to Motor Shaft

Global Motion Products

Distributed by:

Precision Motion Distributors: (925) 803-9565

Technical Support: (760) 451-2723

<http://www.gmpwebsite.com> Email: info@gmpwebsite.com

RoHS Compliant

A - January 2011

Specifications Subject to change without notice