

Gearmotor - 8 x 10 mm

A10••••DM00

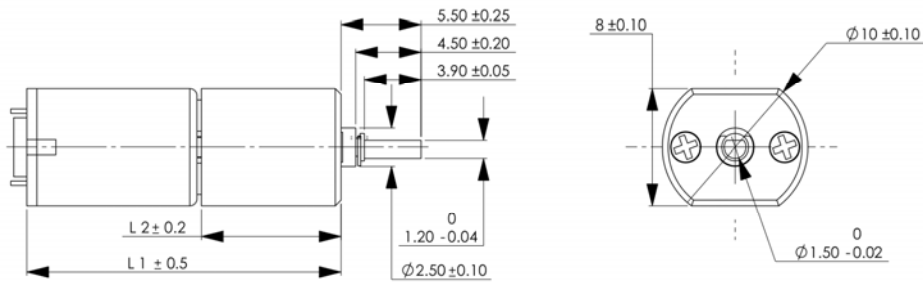

Global Motion Products



Not to Scale
Dimensions in millimeters (mm)

Ratio	Voltage Volts	Efficiency %	No Load Speed rpm	No Load Current Amps	Rated Torque mNm	Length L1 mm	Mass grams	Direction of Rotation*	Order Part Number
5:1	3.0 Volts	80 %	2,697 rpm	0.080 Amp	0.49 mNm	20.60 mm	3.7 grams	Same	A100005DM00
26:1	3.0 Volts	80 %	524 rpm	0.080 Amp	7.85 mNm	20.60 mm	3.8 grams	Same	A100026DM00
136:1	3.0 Volts	70 %	99 rpm	0.090 Amp	24.52 mNm	22.50 mm	3.9 grams	Same	A100136DM00

Bearing Type POM Sleeve

Options: Gears, Compound Gears, Worm Gear on Output Shaft. Connector on Leads. Shaft Material.

* Rotational Sense of Gearbox Output Shaft to Motor Shaft

Global Motion Products

Distributed by:

Precision Motion Distributors: (925) 803-9565

Technical Support: (760) 451-2723

<http://www.gmpwebsite.com> Email: info@gmpwebsite.com

RoHS Compliant

A - January 2011

Specifications Subject to change without notice