

# Gearmotor - 8 x 10 mm

A10••••DM10

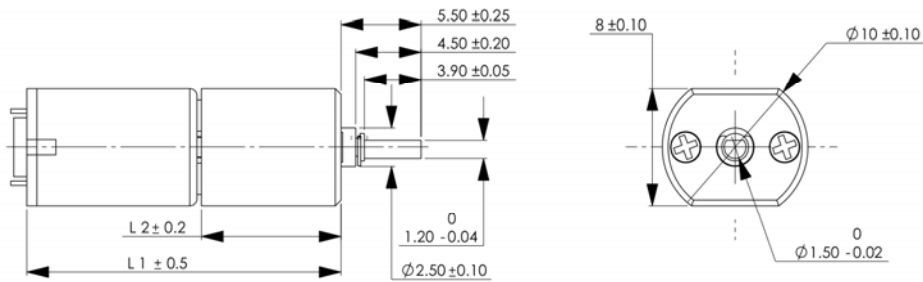

Global Motion Products



Not to Scale  
Dimensions in millimeters (mm)

Ratio	Voltage Volts	Efficiency %	No Load Speed rpm	No Load Current Amps	Rated Torque mNm	Length L1 mm	Mass grams	Direction of Rotation*	Order Part Number
5:1	3.0 Volts	80 %	1,194 rpm	0.045 Amp	1.47 mNm	24.60 mm	4.9 grams	Same	A100005DM10
26:1	3.0 Volts	80 %	232 rpm	0.045 Amp	7.85 mNm	24.60 mm	5.0 grams	Same	A100026DM10
136:1	3.0 Volts	70 %	43 rpm	0.050 Amp	24.52 mNm	26.50 mm	5.1 grams	Same	A100136DM10

Bearing Type POM Sleeve

Options: Gears, Compound Gears, Worm Gear on Output Shaft. Connector on Leads. Shaft Material.

\* Rotational Sense of Gearbox Output Shaft to Motor Shaft

Global Motion Products

Distributed by:

Precision Motion Distributors: (925) 803-9565

Technical Support: (760) 451-2723

<http://www.gmpwebsite.com> Email: [info@gmpwebsite.com](mailto:info@gmpwebsite.com)

RoHS Compliant

A - January 2011

Specifications Subject to change without notice