

# Gearmotor - Coreless - 6 mm Ø

A06••••DC00

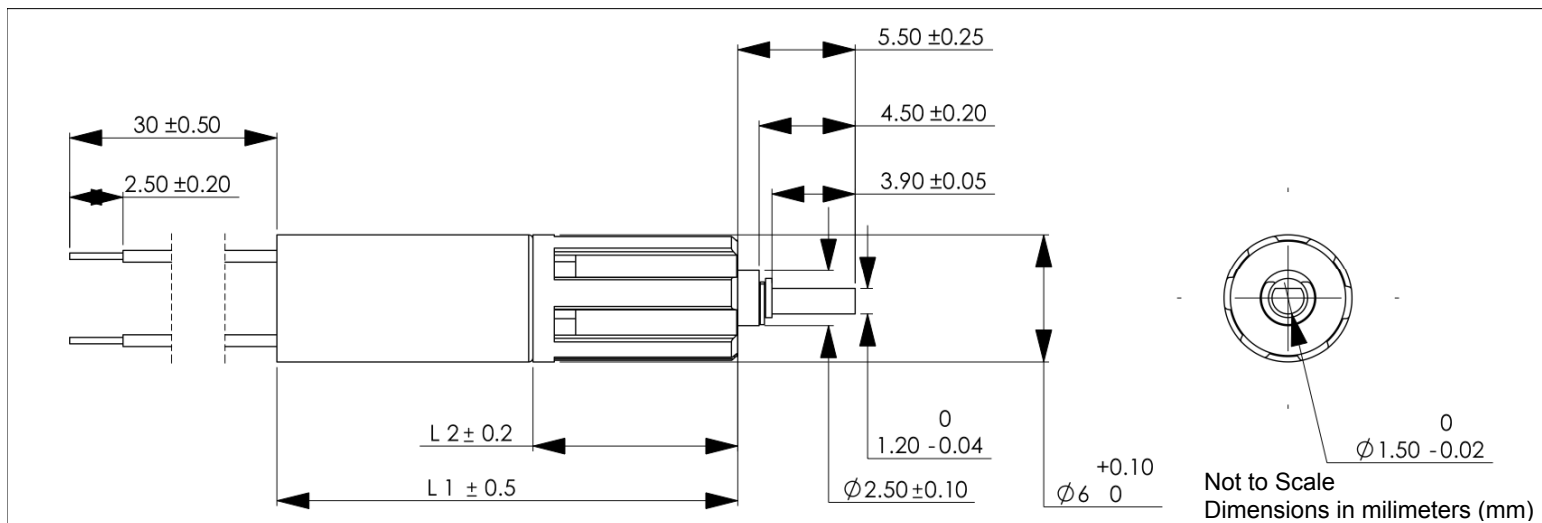

Global Motion Products



Ratio	Voltage Volts	Efficiency %	No Load Speed rpm	No Load Current Amps	Rated Torque mNm	Length L1 mm	Mass grams	Direction of Rotation*	Order Part Number
5:1	3.0 Volts	90 %	5,349 rpm	0.040 Amp	0.50 mNm	19.60 mm	2.0 grams	Same	A060005DC00
26:1	3.0 Volts	80 %	1,039 rpm	0.040 Amp	2.50 mNm	21.40 mm	2.1 grams	Same	A060026DC00
136:1	3.0 Volts	70 %	202 rpm	0.040 Amp	11.80 mNm	23.20 mm	2.2 grams	Same	A060136DC00

Bearing Type POM Sleeve

Options: Gears, Compound Gears, Worm Gear on Output Shaft. Connector on Leads. Shaft Material.

\* Rotational Sense of Gearbox Output Shaft to Motor Shaft

Global Motion Products

Distributed by:

Precision Motion Distributors: (925) 803-9565

Technical Support: (760) 451-2723

<http://www.gmpwebsite.com> Email: [info@gmpwebsite.com](mailto:info@gmpwebsite.com)

RoHS Compliant

A - January 2011

Specifications Subject to change without notice

# Gearmotor - Coreless - 6 mm Ø

A06••••DC10



Global Motion Products

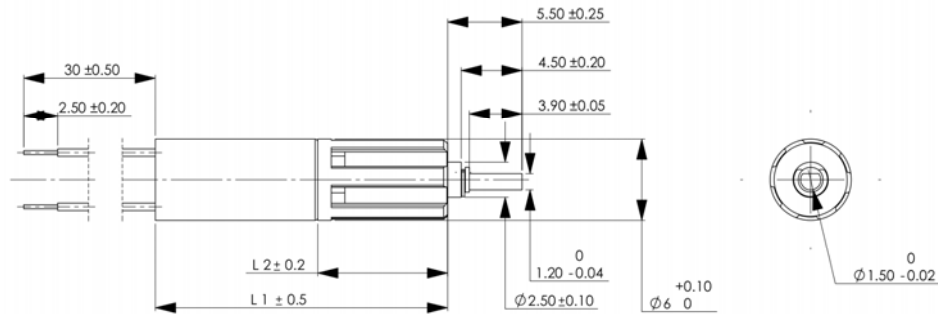

Not to Scale  
Dimensions in millimeters (mm)

Ratio	Voltage Volts	Efficiency %	No Load Speed rpm	No Load Current Amps	Rated Torque mNm	Length L1 mm	Mass grams	Direction of Rotation*	Order Part Number
5:1	3.0 Volts	90 %	1,946 rpm	0.010 Amp	0.39 mNm	22.60 mm	2.0 grams	Same	A060005DC10
26:1	3.0 Volts	80 %	378 rpm	0.010 Amp	1.57 mNm	24.40 mm	2.1 grams	Same	A060026DC10
136:1	3.0 Volts	70 %	74 rpm	0.010 Amp	5.88 mNm	26.20 mm	2.2 grams	Same	A060136DC10

Bearing Type POM Sleeve

Options: Gears, Compound Gears, Worm Gear on Output Shaft. Connector on Leads. Shaft Material.

\* Rotational Sense of Gearbox Output Shaft to Motor Shaft

Global Motion Products

Distributed by:

Precision Motion Distributors: (925) 803-9565

Technical Support: (760) 451-2723

<http://www.gmpwebsite.com> Email: [info@gmpwebsite.com](mailto:info@gmpwebsite.com)

RoHS Compliant

A - January 2011

Specifications Subject to change without notice

# Gearmotor - Coreless - 6 mm Ø



Global Motion Products

A06••••DC30

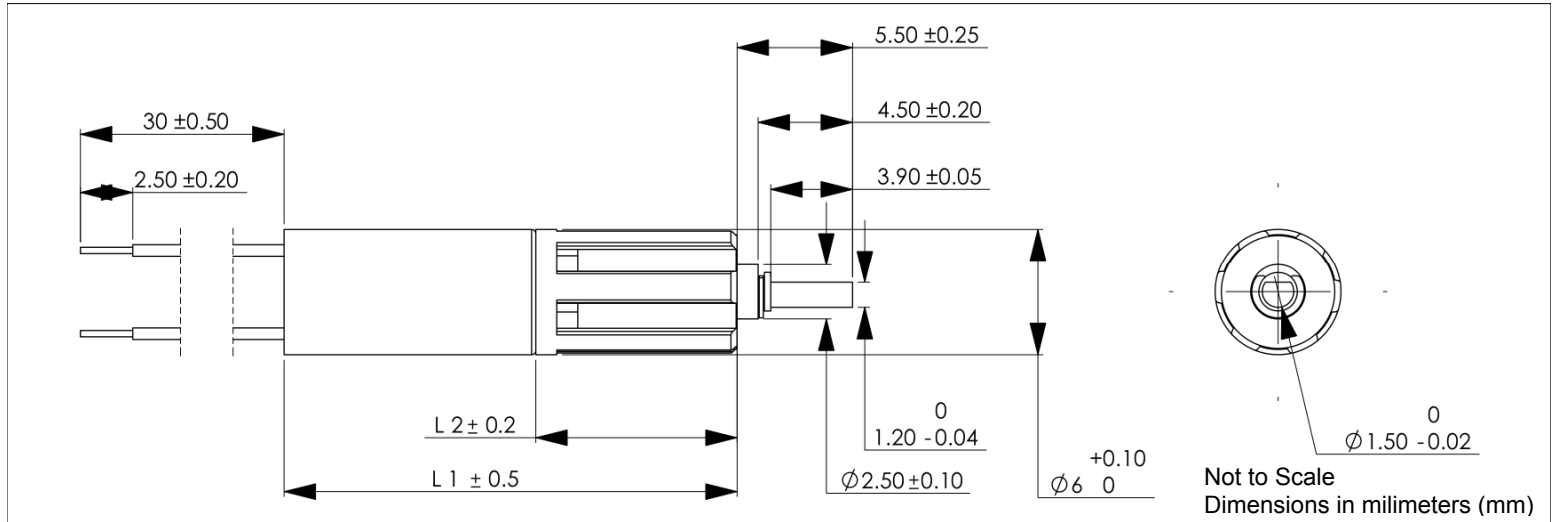

Ratio	Voltage Volts	Efficiency %	No Load Speed rpm	No Load Current Amps	Rated Torque mNm	Length L1 mm	Mass grams	Direction of Rotation*	Order Part Number
5:1	3.0 Volts	90 %	3,498 rpm	0.015 Amp	0.39 mNm	19.60 mm	2.0 grams	Same	A060005DC30
26:1	3.0 Volts	80 %	680 rpm	0.015 Amp	1.57 mNm	21.40 mm	2.1 grams	Same	A060026DC30
136:1	3.0 Volts	70 %	132 rpm	0.015 Amp	5.88 mNm	23.20 mm	2.2 grams	Same	A060136DC30

Bearing Type POM Sleeve

Options: Gears, Compound Gears, Worm Gear on Output Shaft. Connector on Leads. Shaft Material.

\* Rotational Sense of Gearbox Output Shaft to Motor Shaft

Global Motion Products

Distributed by:

Precision Motion Distributors: (925) 803-9565

Technical Support: (760) 451-2723

<http://www.gmpwebsite.com> Email: [info@gmpwebsite.com](mailto:info@gmpwebsite.com)

RoHS Compliant

A - January 2011

Specifications Subject to change without notice

# Gearmotor - 6 x 8 mm

A08••••DM00



Global Motion Products

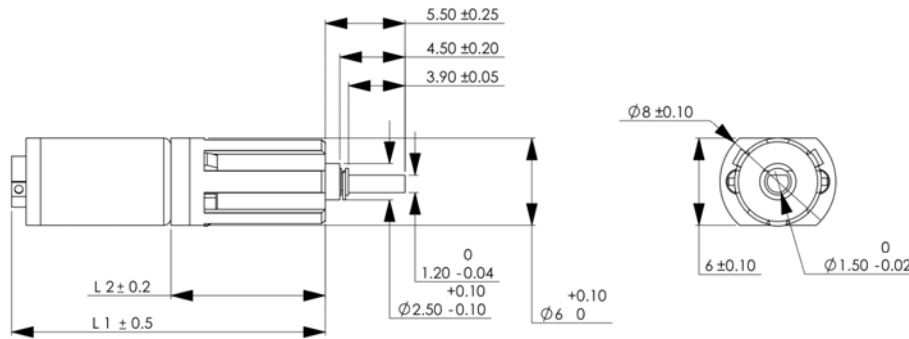

Not to Scale  
Dimensions in millimeters (mm)

Ratio	Voltage Volts	Efficiency %	No Load Speed rpm	No Load Current Amps	Rated Torque mNm	Length L1 mm	Mass grams	Direction of Rotation*	Order Part Number
5:1	3.0 Volts	90 %	3,926 rpm	0.060 Amp	0.49 mNm	20.70 mm	2.1 grams	Same	A080005DM00
26:1	3.0 Volts	80 %	763 rpm	0.060 Amp	2.45 mNm	20.70 mm	2.2 grams	Same	A080026DM00
136:1	3.0 Volts	70 %	148 rpm	0.060 Amp	11.77 mNm	22.50 mm	2.3 grams	Same	A080136DM00

Bearing Type POM Sleeve

Options: Gears, Compound Gears, Worm Gear Mounted on Output Shaft. Connector on Leads. Shaft Material.

\* Rotational Sense of Gearbox Output Shaft to Motor Shaft

Global Motion Products

Distributed by:

Precision Motion Distributors: (925) 803-9565

Technical Support: (760) 451-2723

<http://www.gmpwebsite.com> Email: [info@gmpwebsite.com](mailto:info@gmpwebsite.com)

RoHS Compliant

A - January 2011

Specifications Subject to change without notice

# Gearmotor - 8 x 10 mm

A10••••DM00



Global Motion Products

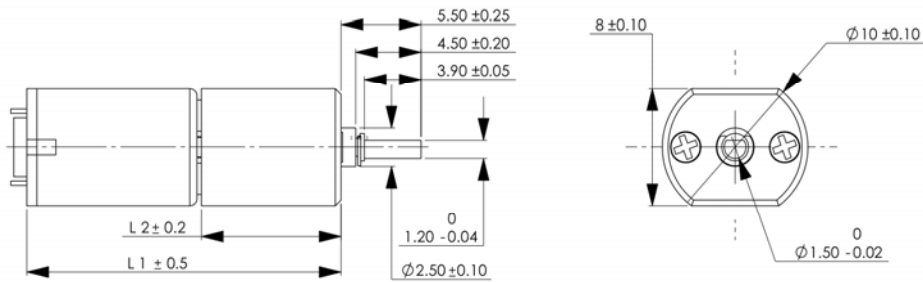

Not to Scale  
Dimensions in millimeters (mm)

Ratio	Voltage Volts	Efficiency %	No Load Speed rpm	No Load Current Amps	Rated Torque mNm	Length L1 mm	Mass grams	Direction of Rotation*	Order Part Number
5:1	3.0 Volts	80 %	2,697 rpm	0.080 Amp	0.49 mNm	20.60 mm	3.7 grams	Same	A100005DM00
26:1	3.0 Volts	80 %	524 rpm	0.080 Amp	7.85 mNm	20.60 mm	3.8 grams	Same	A100026DM00
136:1	3.0 Volts	70 %	99 rpm	0.090 Amp	24.52 mNm	22.50 mm	3.9 grams	Same	A100136DM00

Bearing Type POM Sleeve

Options: Gears, Compound Gears, Worm Gear on Output Shaft. Connector on Leads. Shaft Material.

\* Rotational Sense of Gearbox Output Shaft to Motor Shaft

Global Motion Products

Distributed by:

Precision Motion Distributors: (925) 803-9565

Technical Support: (760) 451-2723

<http://www.gmpwebsite.com> Email: [info@gmpwebsite.com](mailto:info@gmpwebsite.com)

RoHS Compliant

A - January 2011

Specifications Subject to change without notice

# Gearmotor - 8 x 10 mm

A10...DM10



Global Motion Products

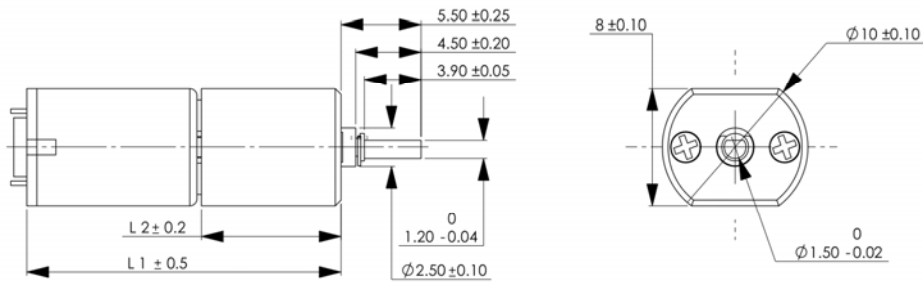

Not to Scale  
Dimensions in millimeters (mm)

Ratio	Voltage Volts	Efficiency %	No Load Speed rpm	No Load Current Amps	Rated Torque mNm	Length L1 mm	Mass grams	Direction of Rotation*	Order Part Number
5:1	3.0 Volts	80 %	1,194 rpm	0.045 Amp	1.47 mNm	24.60 mm	4.9 grams	Same	A100005DM10
26:1	3.0 Volts	80 %	232 rpm	0.045 Amp	7.85 mNm	24.60 mm	5.0 grams	Same	A100026DM10
136:1	3.0 Volts	70 %	43 rpm	0.050 Amp	24.52 mNm	26.50 mm	5.1 grams	Same	A100136DM10

Bearing Type POM Sleeve

Options: Gears, Compound Gears, Worm Gear on Output Shaft. Connector on Leads. Shaft Material.

\* Rotational Sense of Gearbox Output Shaft to Motor Shaft

Global Motion Products

Distributed by:

Precision Motion Distributors: (925) 803-9565

Technical Support: (760) 451-2723

<http://www.gmpwebsite.com> Email: [info@gmpwebsite.com](mailto:info@gmpwebsite.com)

RoHS Compliant

A - January 2011

Specifications Subject to change without notice