

# Planetary Gearbox - 35 mm Ø

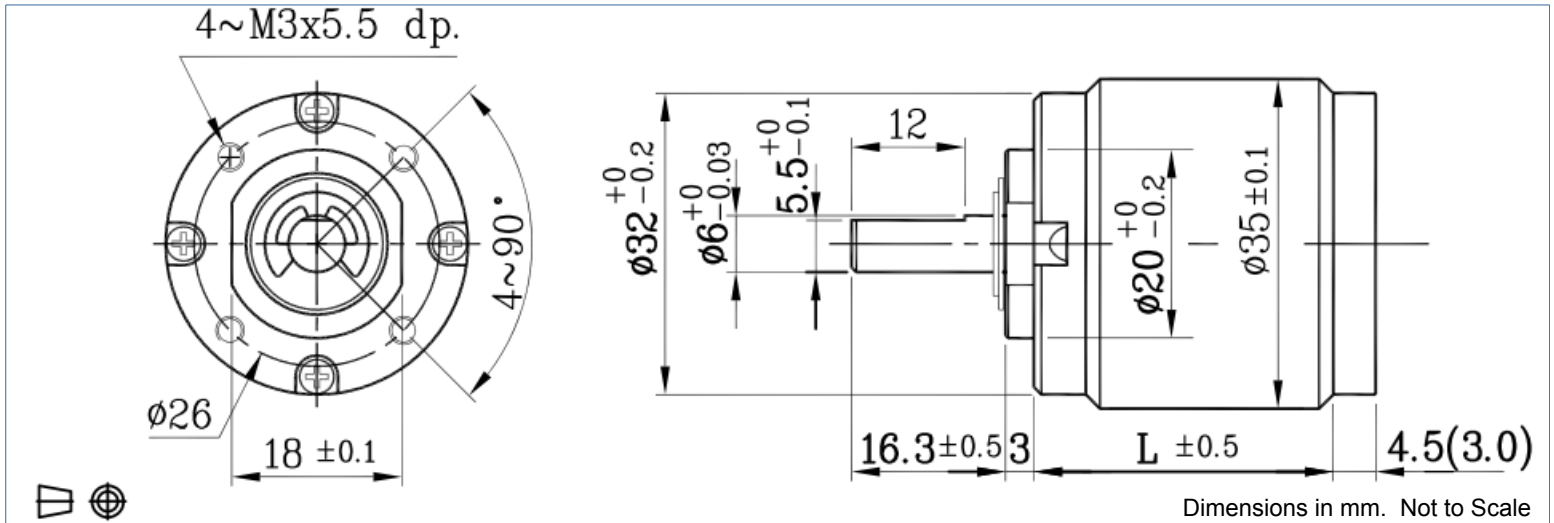

Global Motion Products

P35 •••• AB00



| Ratio   | Efficiency % | Continuous Torque Nm | Momentary Torque Nm | Length L mm | Mass grams | Direction of Rotation* | Order Part Number |
|---------|--------------|----------------------|---------------------|-------------|------------|------------------------|-------------------|
| 3.7:1   | 80           | 0.20 Nm              | 0.59 Nm             | 22.10       |            | Same                   | P350004AB00       |
| 5.2:1   | 80           | 0.20 Nm              | 0.59 Nm             | 22.10       |            | Same                   | P350005AB00       |
| 14.0:1  | 70           | 0.39 Nm              | 1.18 Nm             | 28.50       |            | Same                   | P350014AB00       |
| 19.0:1  | 70           | 0.39 Nm              | 1.18 Nm             | 28.50       |            | Same                   | P350019AB00       |
| 27.0:1  | 70           | 0.59 Nm              | 1.77 Nm             | 28.50       |            | Same                   | P350027AB00       |
| 51.0:1  | 60           | 0.78 Nm              | 2.35 Nm             | 34.90       |            | Same                   | P350051AB00       |
| 71.0:1  | 60           | 0.78 Nm              | 2.35 Nm             | 34.90       |            | Same                   | P350071AB00       |
| 100.0:1 | 60           | 0.98 Nm              | 2.94 Nm             | 34.90       |            | Same                   | P350100AB00       |
| 139.0:1 | 60           | 0.98 Nm              | 2.94 Nm             | 34.90       |            | Same                   | P350139AB00       |
| 189.0:1 | 50           | 1.18 Nm              | 3.53 Nm             | 41.30       |            | Same                   | P350189AB00       |

Radial Load Rating ≤ 34.3 N  
 Radial Load Distance 10 mm  
 Axial Load ≤ 24.5 N  
 Press Fit Force - Max ≤ 98.1 N

Radial Play ≤ 0.04 mm  
 Thrust Play ≤ 0.30 mm  
 Backlash ≤ 2.5 °

Max Temperature - 60°C  
 Min Temperature - -10°C  
 Relative Humidity - 20% to 80%

Bearing Type Ball

Options

Lubrication. Bearings. Coreless and Iron Core Motors. Motors with encoders. Wiring harness. Connectors.

\* Rotational Sense of Gearbox Output Shaft to Motor Shaft

Global Motion Products

Distributed by:

Precision Motion Distributors: (925) 803-9565

Technical Support: (760) 451-2723

http://www.gmpwebsite.com Email: info@gmpwebsite.com

A - January 2011

Specifications Subject to change without notice

RoHS Compliant

# Planetary Gearbox - 32 mm Ø

P32 •••• AS00



Global Motion Products

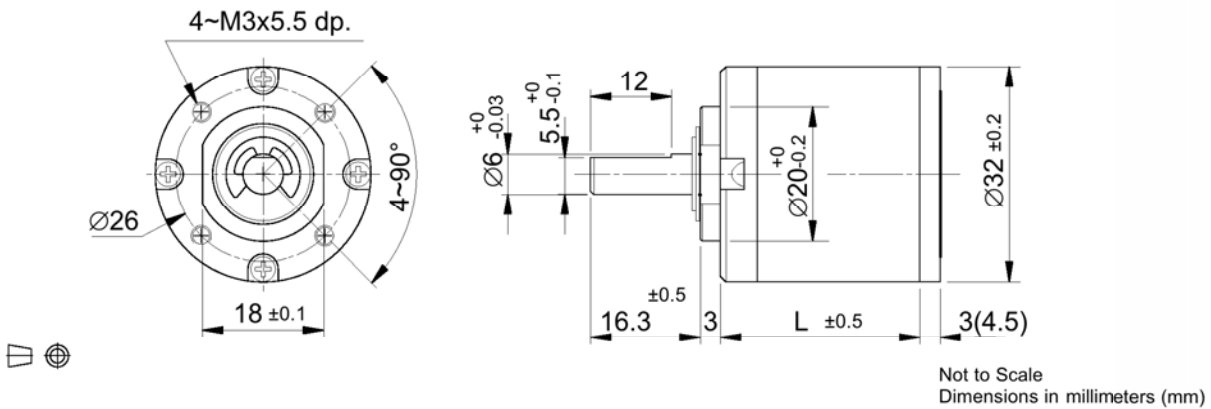

Dimensions in mm. Not to Scale

| Ratio   | Efficiency % | Continuous Torque Nm | Momentary Torque Nm | Length L mm | Mass grams | Direction of Rotation* | Order Part Number |
|---------|--------------|----------------------|---------------------|-------------|------------|------------------------|-------------------|
| 264.0:1 | 50           | 1.18 Nm              | 3.53 Nm             | 36.80       | 173.0      | Same                   | P320264AS00       |
| 516.0:1 | 50           | 1.18 Nm              | 3.53 Nm             | 36.80       | 173.0      | Same                   | P320516AS00       |
| 721.0:1 | 50           | 1.18 Nm              | 3.53 Nm             | 36.80       | 173.0      | Same                   | P320721AS00       |

Radial Load Rating ≤ 29.4 N  
 Radial Load Distance 10 mm  
 Axial Load ≤ 24.5 N  
 Press Fit Force - Max ≤ 98.1 N

Radial Play ≤ 0.05 mm  
 Thrust Play ≤ 0.30 mm  
 Backlash ≤ 2.5 °

Max Temperature - 60°C  
 Min Temperature - -10°C  
 Relative Humidity - 20% to 80%

Bearing Type Sleeve

Options

Lubrication. Bearings. Coreless and Iron Core Motors. Motors with encoders. Wiring harness. Connectors.

\* Rotational Sense of Gearbox Output Shaft to Motor Shaft

Global Motion Products

Distributed by:

Precision Motion Distributors: (925) 803-9565

Technical Support: (760) 451-2723

http://www.gmpwebsite.com Email: info@gmpwebsite.com

A - January 2011

Specifications Subject to change without notice

RoHS Compliant