

Coreless DC Motor - 16 mm Ø

C16P03SD010 **2.3 Watts Peak Power**

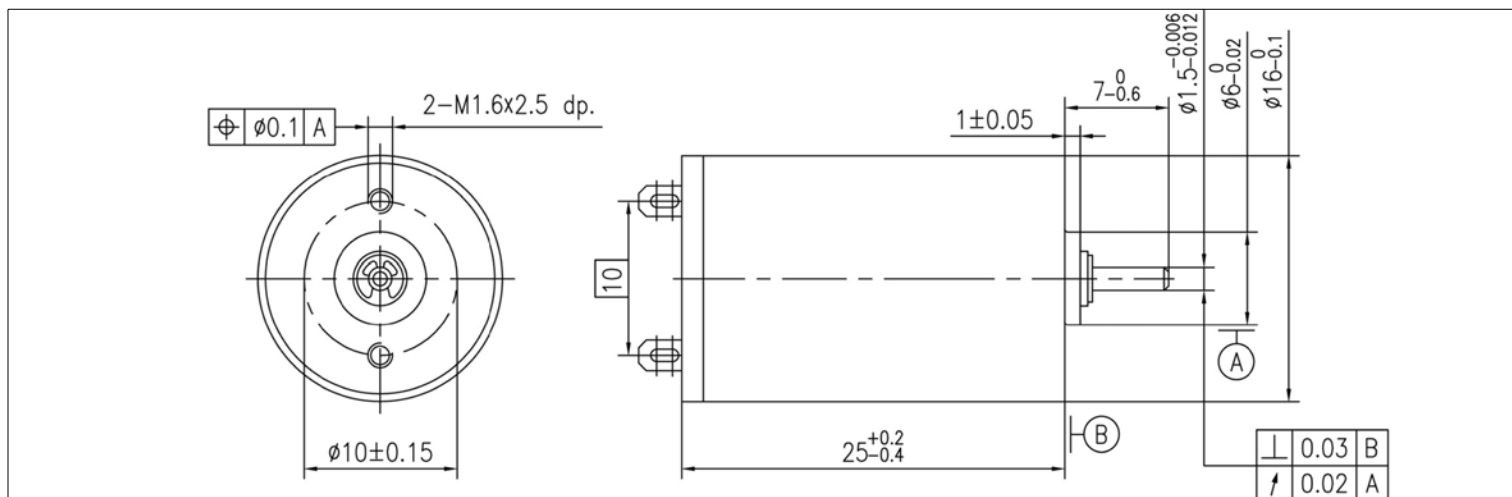

Global Motion Products



Not to Scale - Dimensions in millimeters (mm)

<i>Nominal Voltage</i>	3.0 Volts	3.0 Volts	3.0 Volts
<i>No-Load Speed</i>	10,900 rpm	10,900 rpm	10,900 rpm
<i>Stall Torque</i>	8.2 mNm	83.2 gcm	1.2 oz-in
<i>No-Load Current</i>	0.052 Amps	0.052 Amps	0.052 Amps
<i>Peak Output Power</i>	2.3 Watts	2.3 Watts	2.3 Watts
<i>Torque Constant</i>	2.58 mNm/A	26.36 gcm/A	0.37 oz-in/A
<i>Terminal Resistance</i>	0.95 Ohms	0.95 Ohms	0.95 Ohms
<i>Back-EMF Constant</i>	0.27 V/krpm	0.27 V/krpm	0.27 V/krpm
<i>Mechanical Time Constant</i>	11.7 msec	11.7 msec	11.7 msec
<i>Rotor Inertia</i>	0.82 kgm ² x10 ⁻⁷	0.82 gm cm ²	0.12 x10 ⁻⁴ oz-in-sec ²
<i>Mechanical Time Constant</i>	11.7 msec	11.7 msec	11.7 msec
<i>Slope of Speed/Torque Curve</i>	1,335.3 rpm/mNm	130.9 rpm/gcm	9,429.2 rpm/oz-in
<i>Speed Constant</i>	3,694 rpm/Volt	76 %	76 %
<i>Motor Constant</i>	2.65 mNm/√Watt	27.04 gcm/√Watt	0.38 oz-in/√Watt
<i>Commutation Type</i>	Precious Metal	Precious Metal	Precious Metal
<i>Rated Power @ 9,540 rpm</i>	1.0 Watts	1.0 Watts	1.0 Watts
<i>Rated Torque @ 9,540 rpm</i>	1.0 mNm	10.4 gcm	0.1 oz-in
<i>Rated Current @ 9,540 rpm</i>	0.394 Amps	0.394 Amps	0.394 Amps

Part Number: How to Order C16P03SD010

Ratings are at 25°C Ambient Temperature.

Radial Load Rating	1.4 N	Radial Play	0.020 mm	Max Temperature	65 °C
Radial Load Distance	4 mm	Thrust Play	0.150 mm	Min Temperature	-20 °C
Axial Load	0.80 N	Magnet Type	NdFeB	Max Winding Temp	85 °C
Press Fit Force - Max	15.00 N	Bearing Type	Sleeve Bearings	Mass	19 grams
Gearbox Options	P16 Planetary Gearbox				
Encoder Options	N/A				
Options - Other	Ball Bearings. Shaft length. Lubricants. Leads. Solder Tabs. Connectors.				

Global Motion Products

Distributed by:

Precision Motion Distributors: (925) 803-9565

Technical Support: (760) 451-2723

http://www.gmpwebsite.com Email: info@gmpwebsite.com

Commutation Type:

Precious Metal

**Manufactured under a
Certified ISO 9001:2008
Quality System**

RoHS Compliant

B - August 2011

Specifications Subject to change without notice

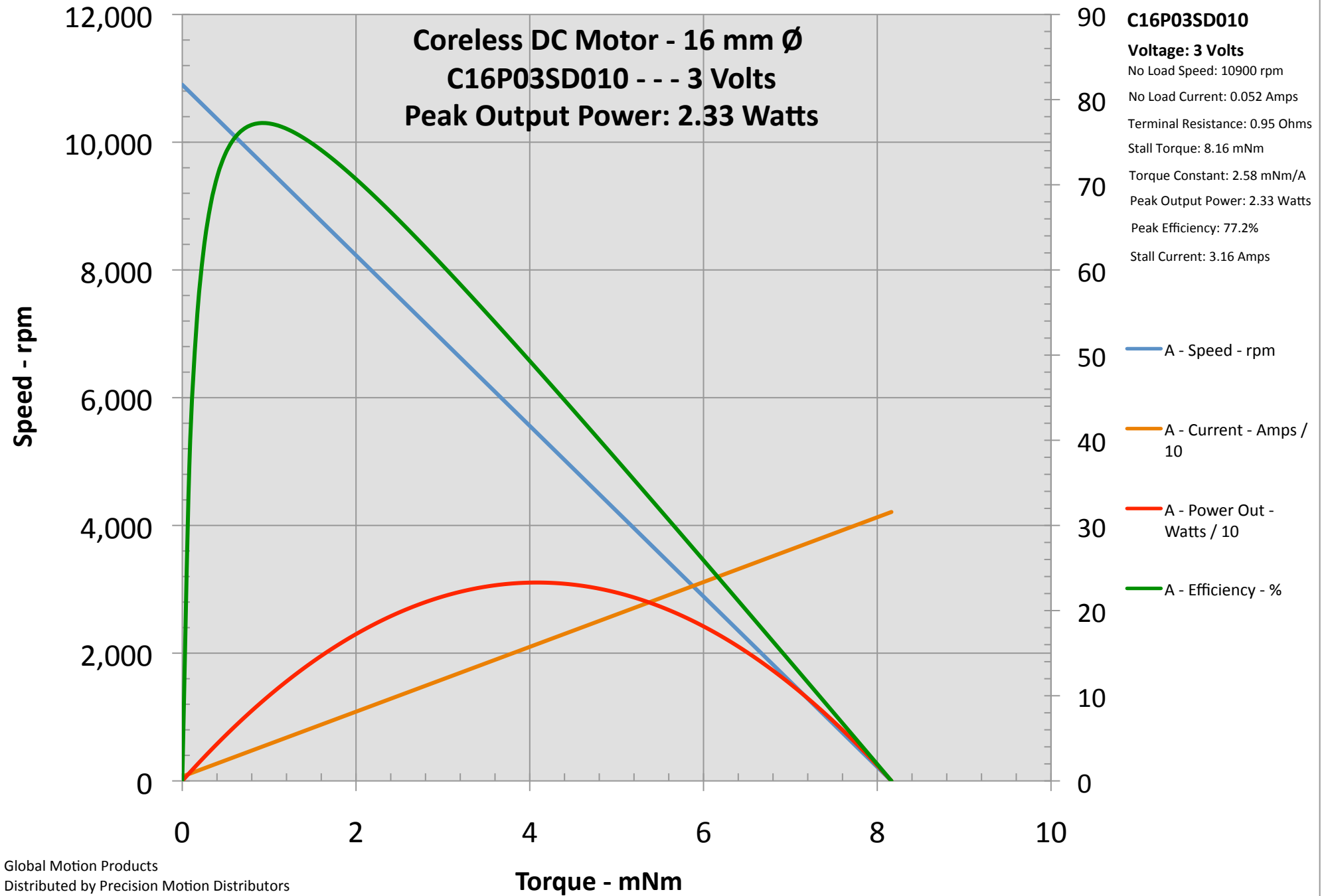

Global Motion Products
 Distributed by Precision Motion Distributors
 (760) 451-2723, (925) 803-9565
<http://www.gmpwebsite.com>
 Email: info@gmpwebsite.com

This Graph is provided free of charge and without any representations or warranties, express or implied, as to its suitability, legal effect, completeness, currentness, accuracy, and/or appropriateness. The simulation is with Nominal Values. The Graph is provided "as is", "as available", and with "all faults" and we disclaim any warranties, including but not limited to the motor or gearmotor's warranties of merchantability and fitness for a particular purpose. This Graph may be inappropriate for your particular circumstances. This is a simple mathematical simulation of a speed/torque curve for information purposes only. **IT IS NOT TEST DATA.**

January 18, 2011

CAUTION: Peak Output Power is NOT a RATING. This is merely a calculated value and does not address Thermal Issues.

Coreless DC Motor - 16 mm Ø

C16P05SD000 1.1 Watts Peak Power



Global Motion Products

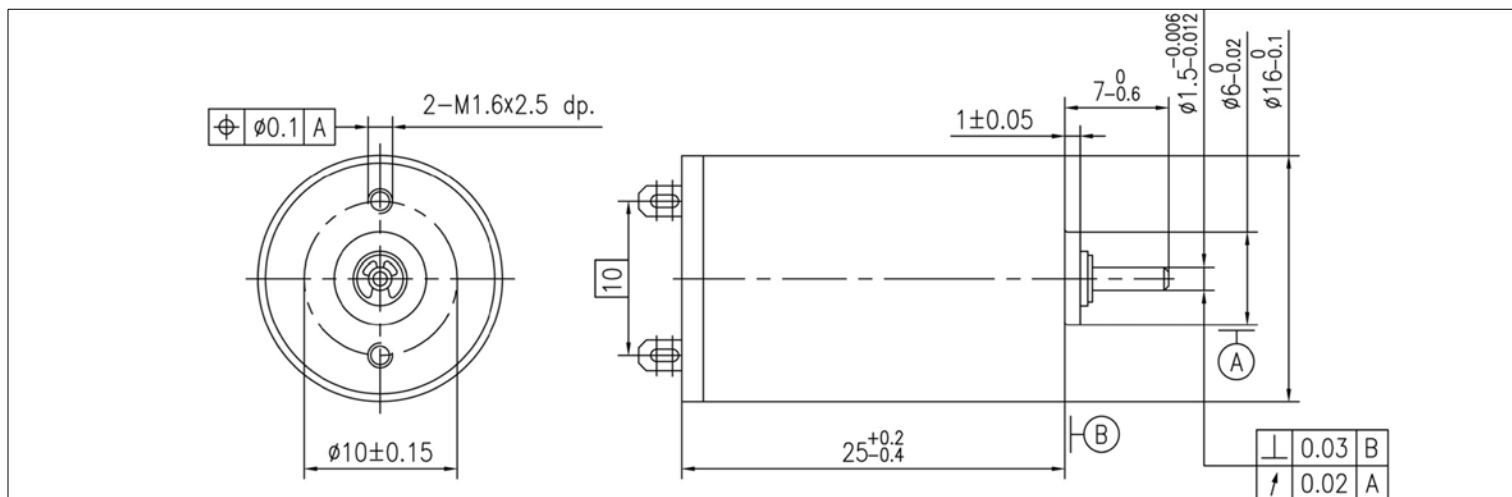

Not to Scale - Dimensions in millimeters (mm)

Nominal Voltage	4.5 Volts	4.5 Volts	4.5 Volts
No-Load Speed	8,800 rpm	8,800 rpm	8,800 rpm
Stall Torque	5.0 mNm	50.5 gcm	0.7 oz-in
No-Load Current	0.020 Amps	0.020 Amps	0.020 Amps
Peak Output Power	1.1 Watts	1.1 Watts	1.1 Watts
Torque Constant	4.79 mNm/A	48.84 gcm/A	0.68 oz-in/A
Terminal Resistance	4.35 Ohms	4.35 Ohms	4.35 Ohms
Back-EMF Constant	0.50 V/krpm	0.50 V/krpm	0.50 V/krpm
Mechanical Time Constant	10.1 msec	10.1 msec	10.1 msec
Rotor Inertia	0.53 kgm ² x10 ⁻⁷	0.53 gm cm ²	0.08 x10 ⁻⁴ oz-in-sec ²
Mechanical Time Constant	10.1 msec	10.1 msec	10.1 msec
Slope of Speed/Torque Curve	1,776.0 rpm/mNm	174.2 rpm/gcm	12,541.5 rpm/oz-in
Speed Constant	1,994 rpm/Volt	74 %	74 %
Motor Constant	2.30 mNm/√Watt	23.42 gcm/√Watt	0.33 oz-in/√Watt
Commutation Type	Precious Metal	Precious Metal	Precious Metal
Rated Power @ 6,758 rpm	0.8 Watts	0.8 Watts	0.8 Watts
Rated Torque @ 6,758 rpm	1.1 mNm	11.7 gcm	0.2 oz-in
Rated Current @ 6,758 rpm	0.240 Amps	0.240 Amps	0.240 Amps

Part Number: How to Order C16P05SD000

Ratings are at 25°C Ambient Temperature.

Radial Load Rating	1.4 N	Radial Play	0.020 mm	Max Temperature	65 °C
Radial Load Distance	4 mm	Thrust Play	0.150 mm	Min Temperature	-20 °C
Axial Load	0.80 N	Magnet Type	NdFeB	Max Winding Temp	85 °C
Press Fit Force - Max	15.00 N	Bearing Type	Sleeve Bearings	Mass	19 grams
Gearbox Options	P16 Planetary Gearbox				
Encoder Options	N/A				
Options - Other	Ball Bearings. Shaft length. Lubricants. Leads. Solder Tabs. Connectors.				

Global Motion Products

Distributed by:

Precision Motion Distributors: (925) 803-9565

Technical Support: (760) 451-2723

http://www.gmpwebsite.com Email: info@gmpwebsite.com

Commutation Type:

Precious Metal

Manufactured under a
Certified ISO 9001:2008
Quality System

RoHS Compliant

B - August 2011

Specifications Subject to change without notice

Coreless DC Motor - 16 mm Ø
C16P05SD000 - - - 4.5 Volts
Peak Output Power: 1.14 Watts

C16P05SD000
Voltage: 4.5 Volts
 No Load Speed: 8800 rpm
 No Load Current: 0.0198 Amps
 Terminal Resistance: 4.35 Ohms
 Stall Torque: 4.95 mNm
 Torque Constant: 4.79 mNm/A
 Peak Output Power: 1.14 Watts
 Peak Efficiency: 75.7%
 Stall Current: 1.03 Amps

Speed - rpm

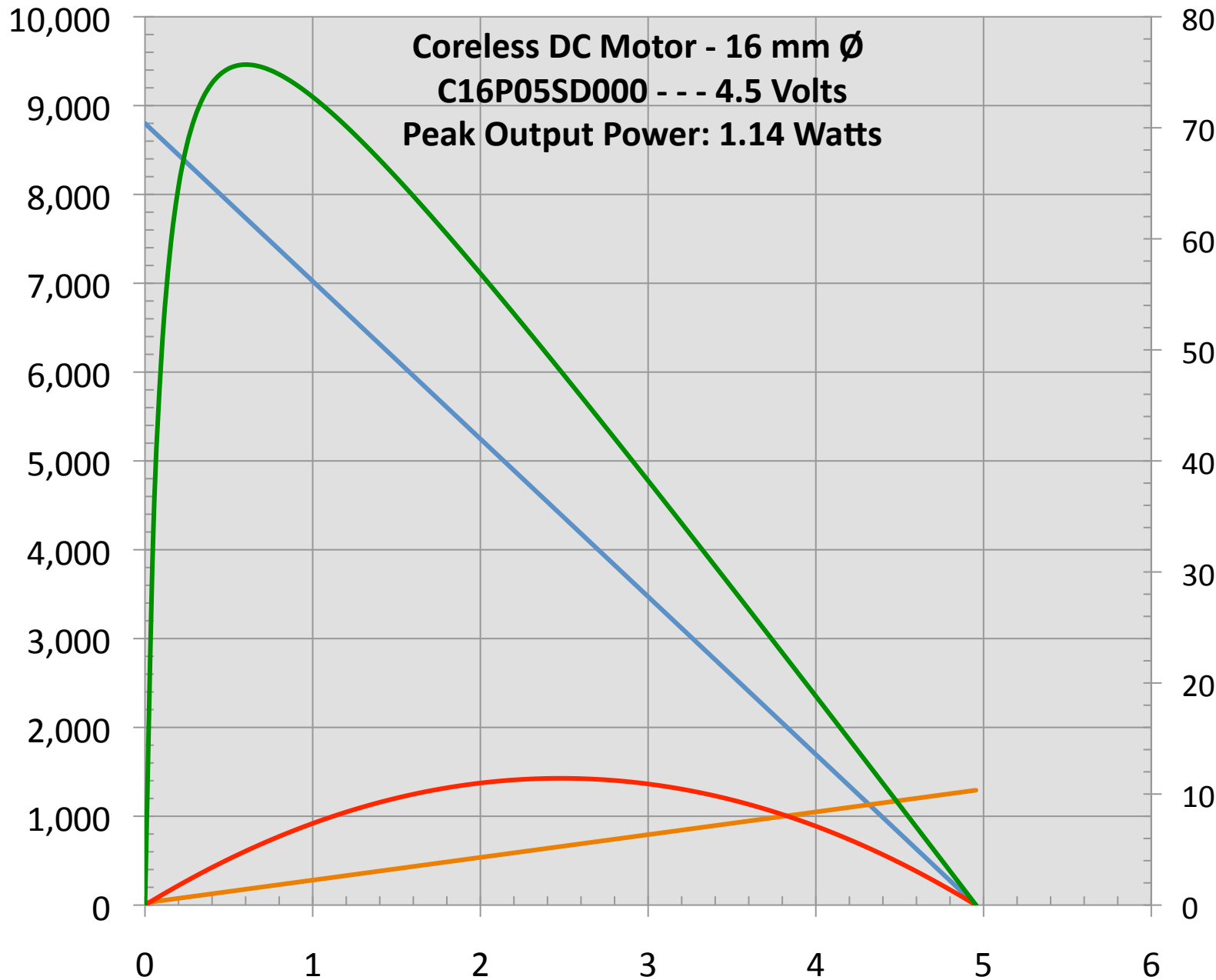

- A - Speed - rpm
- A - Current - Amps / 10
- A - Power Out - Watts / 10
- A - Efficiency - %

Global Motion Products
 Distributed by Precision Motion Distributors
 (760) 451-2723, (925) 803-9565
<http://www.gmpwebsite.com>
 Email: info@gmpwebsite.com

This Graph is provided free of charge and without any representations or warranties, express or implied, as to its suitability, legal effect, completeness, currentness, accuracy, and/or appropriateness. The simulation is with Nominal Values. The Graph is provided "as is", "as available", and with "all faults" and we disclaim any warranties, including but not limited to the motor or gearmotor's warranties of merchantability and fitness for a particular purpose. This Graph may be inappropriate for your particular circumstances. This is a simple mathematical simulation of a speed/torque curve for information purposes only. **IT IS NOT TEST DATA.**

January 18, 2011

CAUTION: Peak Output Power is NOT a RATING. This is merely a calculated value and does not address Thermal Issues.

Coreless DC Motor - 16 mm Ø

C16P06SD000

1.1 Watts Peak Power



Global Motion Products

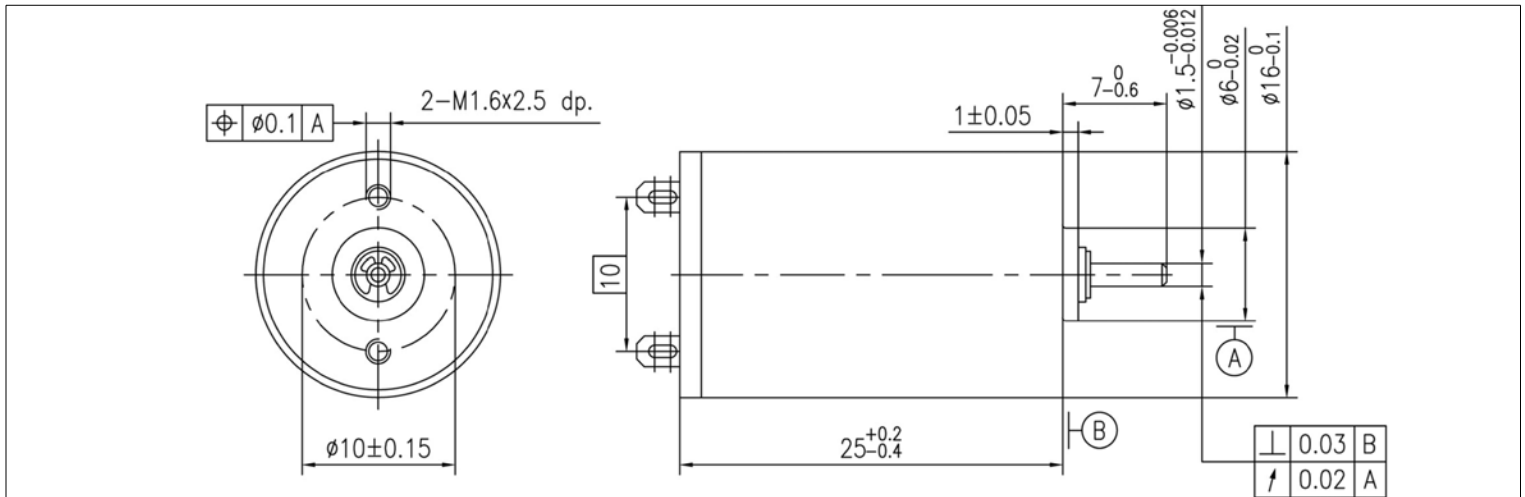

Not to Scale - Dimensions in millimeters (mm)

Nominal Voltage	6.0 Volts	6.0 Volts	6.0 Volts
No-Load Speed	8,590 rpm	8,590 rpm	8,590 rpm
Stall Torque	4.9 mNm	50.1 gcm	0.7 oz-in
No-Load Current	0.013 Amps	0.013 Amps	0.013 Amps
Peak Output Power	1.1 Watts	1.1 Watts	1.1 Watts
Torque Constant	6.56 mNm/A	66.85 gcm/A	0.93 oz-in/A
Terminal Resistance	8.00 Ohms	8.00 Ohms	8.00 Ohms
Back-EMF Constant	0.69 V/krpm	0.69 V/krpm	0.69 V/krpm
Mechanical Time Constant	17.2 msec	17.2 msec	17.2 msec
Rotor Inertia	0.92 kgm ² x10 ⁻⁷	0.92 gm cm ²	0.13 x10 ⁻⁴ oz-in-sec ²
Mechanical Time Constant	17.2 msec	17.2 msec	17.2 msec
Slope of Speed/Torque Curve	1,746.9 rpm/mNm	171.3 rpm/gcm	12,336.1 rpm/oz-in
Speed Constant	1,457 rpm/Volt	76 %	76 %
Motor Constant	2.32 mNm/√Watt	23.64 gcm/√Watt	0.33 oz-in/√Watt
Commutation Type	Precious Metal	Precious Metal	Precious Metal
Rated Power @ 6,448 rpm	0.8 Watts	0.8 Watts	0.8 Watts
Rated Torque @ 6,448 rpm	1.2 mNm	12.5 gcm	0.2 oz-in
Rated Current @ 6,448 rpm	0.187 Amps	0.187 Amps	0.187 Amps

Part Number: How to Order C16P06SD000

Ratings are at 25°C Ambient Temperature.

Radial Load Rating	1.4 N	Radial Play	0.020 mm	Max Temperature	65 °C
Radial Load Distance	4 mm	Thrust Play	0.150 mm	Min Temperature	-20 °C
Axial Load	0.80 N	Magnet Type	NdFeB	Max Winding Temp	85 °C
Press Fit Force - Max	15.00 N	Bearing Type	Sleeve Bearings	Mass	19 grams
Gearbox Options	P16 Planetary Gearbox				
Encoder Options	N/A				
Options - Other	Ball Bearings. Shaft length. Lubricants. Leads. Solder Tabs. Connectors.				

Global Motion Products

Distributed by:

Precision Motion Distributors: (925) 803-9565

Technical Support: (760) 451-2723

http://www.gmpwebsite.com Email: info@gmpwebsite.com

Commutation Type:

Precious Metal

Manufactured under a
Certified ISO 9001:2008
Quality System

RoHS Compliant

B - August 2011

Specifications Subject to change without notice

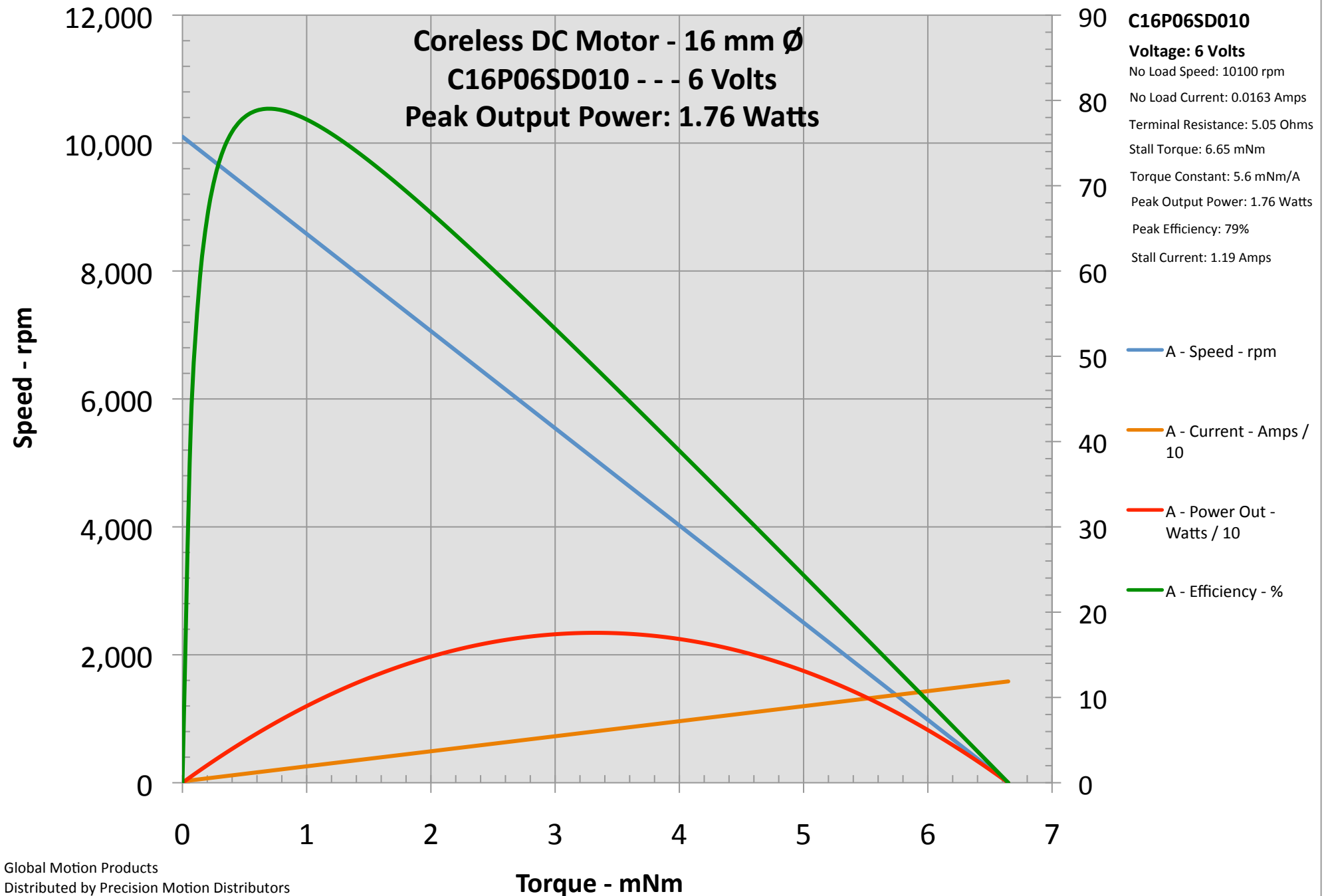

C16P06SD010
Voltage: 6 Volts
 No Load Speed: 10100 rpm
 No Load Current: 0.0163 Amps
 Terminal Resistance: 5.05 Ohms
 Stall Torque: 6.65 mNm
 Torque Constant: 5.6 mNm/A
 Peak Output Power: 1.76 Watts
 Peak Efficiency: 79%
 Stall Current: 1.19 Amps

Global Motion Products
 Distributed by Precision Motion Distributors
 (760) 451-2723, (925) 803-9565
<http://www.gmpwebsite.com>
 Email: info@gmpwebsite.com

This Graph is provided free of charge and without any representations or warranties, express or implied, as to its suitability, legal effect, completeness, currentness, accuracy, and/or appropriateness. The simulation is with Nominal Values. The Graph is provided "as is", "as available", and with "all faults" and we disclaim any warranties, including but not limited to the motor or gearmotor's warranties of merchantability and fitness for a particular purpose. This Graph may be inappropriate for your particular circumstances. This is a simple mathematical simulation of a speed/torque curve for information purposes only. **IT IS NOT TEST DATA.**

January 18, 2011

CAUTION: Peak Output Power is NOT a RATING. This is merely a calculated value and does not address Thermal Issues.

Coreless DC Motor - 16 mm Ø

C16P06SD010 1.7 Watts Peak Power



Global Motion Products

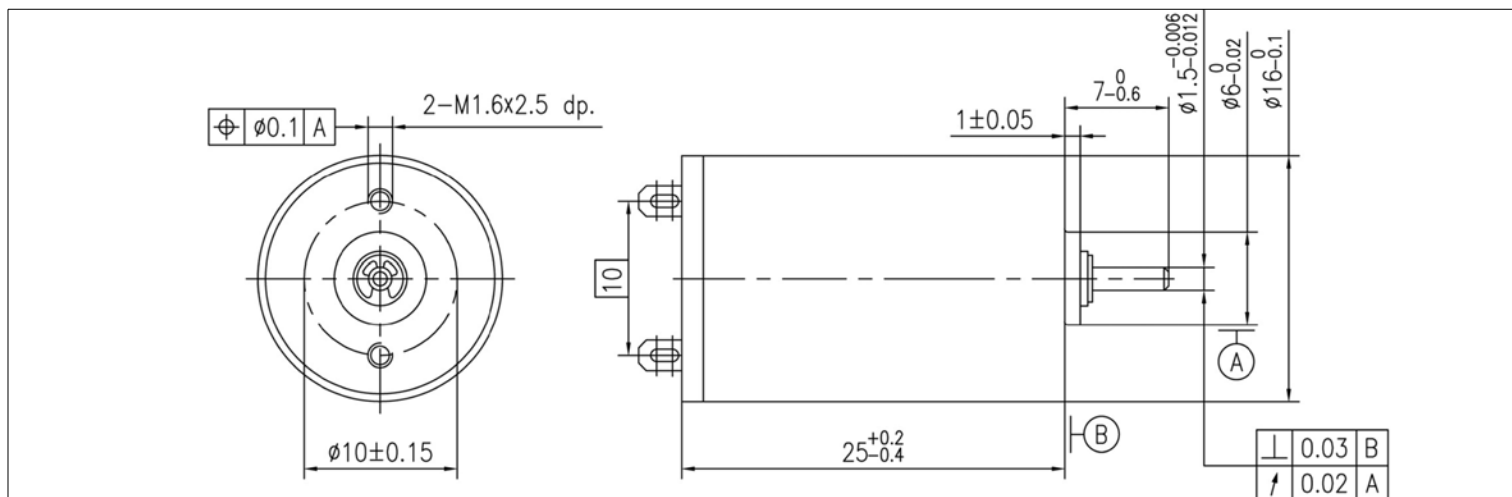

Not to Scale - Dimensions in millimeters (mm)

Nominal Voltage	6.0 Volts	6.0 Volts	6.0 Volts
No-Load Speed	10,100 rpm	10,100 rpm	10,100 rpm
Stall Torque	6.6 mNm	67.8 gcm	0.9 oz-in
No-Load Current	0.016 Amps	0.016 Amps	0.016 Amps
Peak Output Power	1.7 Watts	1.7 Watts	1.7 Watts
Torque Constant	5.60 mNm/A	57.05 gcm/A	0.79 oz-in/A
Terminal Resistance	5.05 Ohms	5.05 Ohms	5.05 Ohms
Back-EMF Constant	0.59 V/krpm	0.59 V/krpm	0.59 V/krpm
Mechanical Time Constant	16.8 msec	16.8 msec	16.8 msec
Rotor Inertia	1.04 kgm ² x10 ⁻⁷	1.04 gm cm ²	0.15 x10 ⁻⁴ oz-in-sec ²
Mechanical Time Constant	16.8 msec	16.8 msec	16.8 msec
Slope of Speed/Torque Curve	1,519.4 rpm/mNm	149.0 rpm/gcm	10,729.0 rpm/oz-in
Speed Constant	1,707 rpm/Volt	78 %	78 %
Motor Constant	2.49 mNm/√Watt	25.39 gcm/√Watt	0.35 oz-in/√Watt
Commutation Type	Precious Metal	Precious Metal	Precious Metal
Rated Power @ 7,575 rpm	1.3 Watts	1.3 Watts	1.3 Watts
Rated Torque @ 7,575 rpm	1.7 mNm	16.9 gcm	0.2 oz-in
Rated Current @ 7,575 rpm	0.297 Amps	0.297 Amps	0.297 Amps

Part Number: How to Order C16P06SD010

Ratings are at 25°C Ambient Temperature.

Radial Load Rating	1.4 N	Radial Play	0.020 mm	Max Temperature	65 °C
Radial Load Distance	4 mm	Thrust Play	0.150 mm	Min Temperature	-20 °C
Axial Load	0.80 N	Magnet Type	NdFeB	Max Winding Temp	85 °C
Press Fit Force - Max	15.00 N	Bearing Type	Sleeve Bearings	Mass	19 grams
Gearbox Options	P16 Planetary Gearbox				
Encoder Options	N/A				
Options - Other	Ball Bearings. Shaft length. Lubricants. Leads. Solder Tabs. Connectors.				

Global Motion Products

Distributed by:

Precision Motion Distributors: (925) 803-9565

Technical Support: (760) 451-2723

http://www.gmpwebsite.com Email: info@gmpwebsite.com

Commutation Type:

Precious Metal

Manufactured under a
Certified ISO 9001:2008
Quality System

RoHS Compliant

B - August 2011

Specifications Subject to change without notice

Coreless DC Motor - 16 mm Ø
C16P06SD000 - - - 6 Volts
Peak Output Power: 1.11 Watts

C16P06SD000
Voltage: 6 Volts
 No Load Speed: 8590 rpm
 No Load Current: 0.0128 Amps
 Terminal Resistance: 8 Ohms
 Stall Torque: 4.92 mNm
 Torque Constant: 6.56 mNm/A
 Peak Output Power: 1.11 Watts
 Peak Efficiency: 76.9%
 Stall Current: 0.75 Amps

Speed - rpm

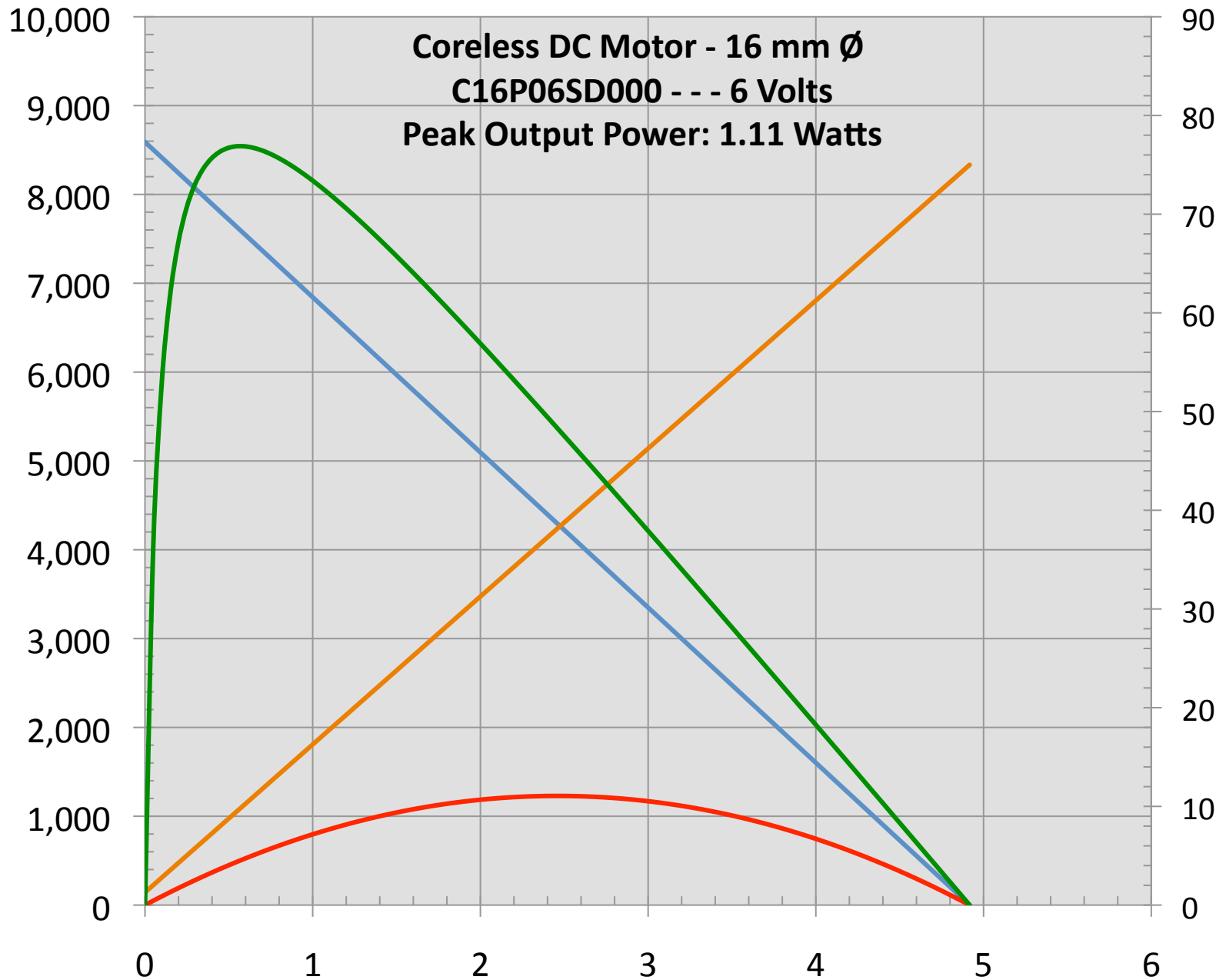

90
80
70
60
50
40
30
20
10
0

A - Speed - rpm
 A - Current - Amps / 100
 A - Power Out - Watts / 10
 A - Efficiency - %

Torque - mNm

Global Motion Products
 Distributed by Precision Motion Distributors
 (760) 451-2723, (925) 803-9565
<http://www.gmpwebsite.com>
 Email: info@gmpwebsite.com

This Graph is provided free of charge and without any representations or warranties, express or implied, as to its suitability, legal effect, completeness, currentness, accuracy, and/or appropriateness. The simulation is with Nominal Values. The Graph is provided "as is", "as available", and with "all faults" and we disclaim any warranties, including but not limited to the motor or gearmotor's warranties of merchantability and fitness for a particular purpose. This Graph may be inappropriate for your particular circumstances. This is a simple mathematical simulation of a speed/torque curve for information purposes only. **IT IS NOT TEST DATA.**

January 18, 2011

CAUTION: Peak Output Power is NOT a RATING. This is merely a calculated value and does not address Thermal Issues.

Coreless DC Motor - 16 mm Ø

C16P09SD000 1.1 Watts Peak Power



Global Motion Products

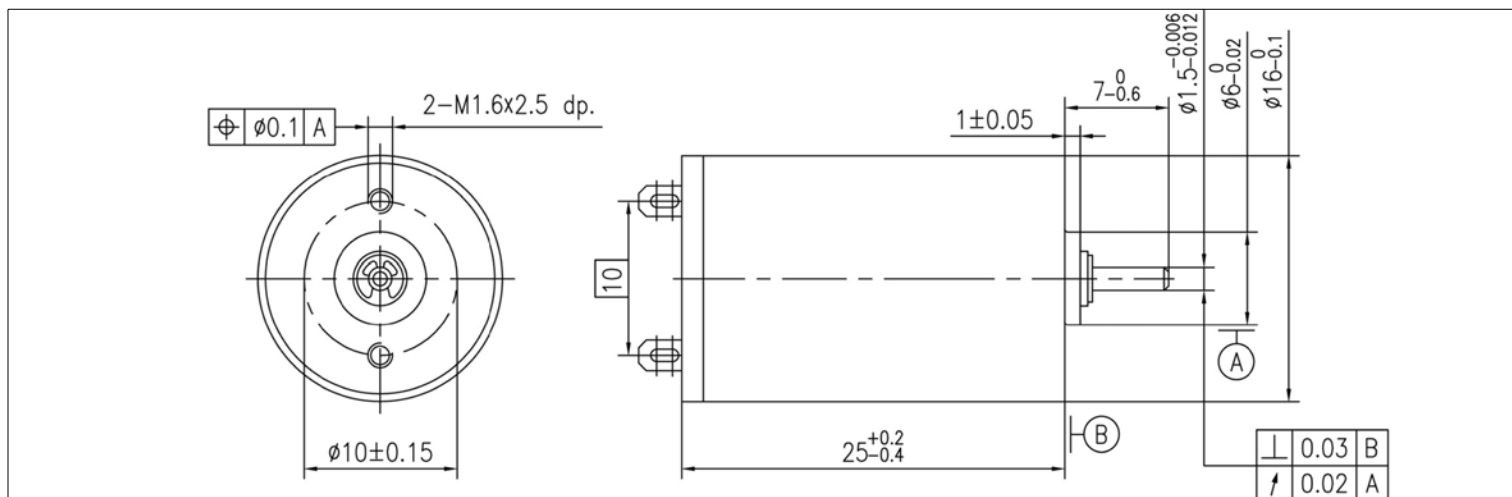

Not to Scale - Dimensions in millimeters (mm)

Nominal Voltage	9.0 Volts	9.0 Volts	9.0 Volts
No-Load Speed	8,480 rpm	8,480 rpm	8,480 rpm
Stall Torque	5.2 mNm	53.2 gcm	0.7 oz-in
No-Load Current	0.008 Amps	0.008 Amps	0.008 Amps
Peak Output Power	1.1 Watts	1.1 Watts	1.1 Watts
Torque Constant	9.97 mNm/A	101.69 gcm/A	1.41 oz-in/A
Terminal Resistance	17.20 Ohms	17.20 Ohms	17.20 Ohms
Back-EMF Constant	1.04 V/krpm	1.04 V/krpm	1.04 V/krpm
Mechanical Time Constant	12.2 msec	12.2 msec	12.2 msec
Rotor Inertia	0.70 kgm ² x10 ⁻⁷	0.70 gm cm ²	0.10 x10 ⁻⁴ oz-in-sec ²
Mechanical Time Constant	12.2 msec	12.2 msec	12.2 msec
Slope of Speed/Torque Curve	1,625.1 rpm/mNm	159.4 rpm/gcm	11,476.0 rpm/oz-in
Speed Constant	958 rpm/Volt	76 %	76 %
Motor Constant	2.40 mNm/√Watt	24.52 gcm/√Watt	0.34 oz-in/√Watt
Commutation Type	Precious Metal	Precious Metal	Precious Metal
Rated Power @ 6,535 rpm	0.8 Watts	0.8 Watts	0.8 Watts
Rated Torque @ 6,535 rpm	1.2 mNm	12.2 gcm	0.2 oz-in
Rated Current @ 6,535 rpm	0.120 Amps	0.120 Amps	0.120 Amps

Part Number: How to Order C16P09SD000

Ratings are at 25°C Ambient Temperature.

Radial Load Rating	1.4 N	Radial Play	0.020 mm	Max Temperature	65 °C
Radial Load Distance	4 mm	Thrust Play	0.150 mm	Min Temperature	-20 °C
Axial Load	0.80 N	Magnet Type	NdFeB	Max Winding Temp	85 °C
Press Fit Force - Max	15.00 N	Bearing Type	Sleeve Bearings	Mass	19 grams
Gearbox Options	P16 Planetary Gearbox				
Encoder Options	N/A				
Options - Other	Ball Bearings. Shaft length. Lubricants. Leads. Solder Tabs. Connectors.				

Global Motion Products

Distributed by:

Precision Motion Distributors: (925) 803-9565

Technical Support: (760) 451-2723

http://www.gmpwebsite.com Email: info@gmpwebsite.com

Commutation Type:

Precious Metal

Manufactured under a
Certified ISO 9001:2008
Quality System

RoHS Compliant

B - August 2011

Specifications Subject to change without notice

Coreless DC Motor - 16 mm Ø
C16P09SD000 - - - 9 Volts
Peak Output Power: 1.16 Watts

C16P09SD000
Voltage: 9 Volts
 No Load Speed: 8480 rpm
 No Load Current: 0.0084 Amps
 Terminal Resistance: 17.2 Ohms
 Stall Torque: 5.22 mNm
 Torque Constant: 9.97 mNm/A
 Peak Output Power: 1.16 Watts
 Peak Efficiency: 77.5%
 Stall Current: 0.52 Amps

Speed - rpm

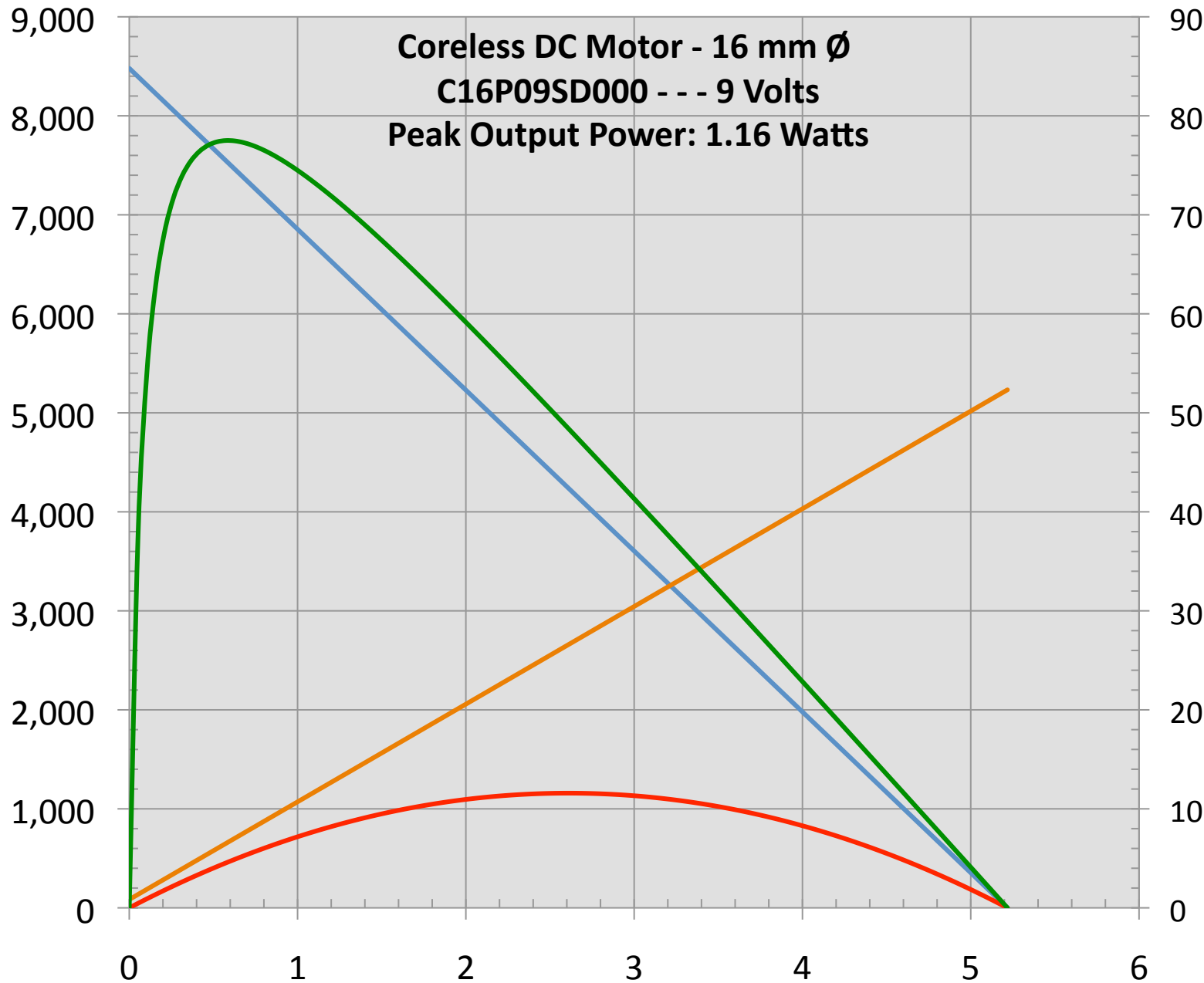

90
80
70
60
50
40
30
20
10
0

— A - Speed - rpm
 — A - Current - Amps / 100
 — A - Power Out - Watts / 10
 — A - Efficiency - %

Torque - mNm

Global Motion Products
 Distributed by Precision Motion Distributors
 (760) 451-2723, (925) 803-9565
<http://www.gmpwebsite.com>
 Email: info@gmpwebsite.com

This Graph is provided free of charge and without any representations or warranties, express or implied, as to its suitability, legal effect, completeness, currentness, accuracy, and/or appropriateness. The simulation is with Nominal Values. The Graph is provided "as is", "as available", and with "all faults" and we disclaim any warranties, including but not limited to the motor or gearmotor's warranties of merchantability and fitness for a particular purpose. This Graph may be inappropriate for your particular circumstances. This is a simple mathematical simulation of a speed/torque curve for information purposes only. **IT IS NOT TEST DATA.**

January 18, 2011

CAUTION: Peak Output Power is NOT a RATING. This is merely a calculated value and does not address Thermal Issues.

Coreless DC Motor - 16 mm Ø

C16P09SD010 1.9 Watts Peak Power



Global Motion Products

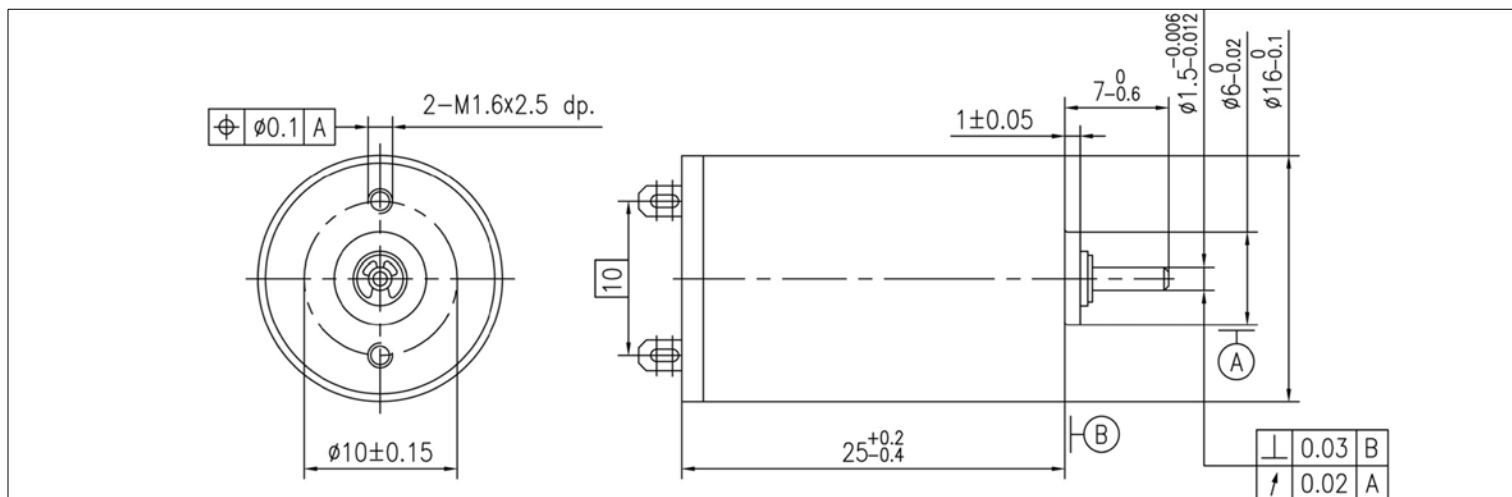

Not to Scale - Dimensions in millimeters (mm)

Nominal Voltage	9.0 Volts	9.0 Volts	9.0 Volts
No-Load Speed	10,600 rpm	10,600 rpm	10,600 rpm
Stall Torque	7.0 mNm	71.1 gcm	1.0 oz-in
No-Load Current	0.013 Amps	0.013 Amps	0.013 Amps
Peak Output Power	1.9 Watts	1.9 Watts	1.9 Watts
Torque Constant	7.98 mNm/A	81.40 gcm/A	1.13 oz-in/A
Terminal Resistance	10.30 Ohms	10.30 Ohms	10.30 Ohms
Back-EMF Constant	0.84 V/krpm	0.84 V/krpm	0.84 V/krpm
Mechanical Time Constant	14.0 msec	14.0 msec	14.0 msec
Rotor Inertia	0.87 kgm ² x10 ⁻⁷	0.87 gm cm ²	0.12 x10 ⁻⁴ oz-in-sec ²
Mechanical Time Constant	14.0 msec	14.0 msec	14.0 msec
Slope of Speed/Torque Curve	1,519.7 rpm/mNm	149.0 rpm/gcm	10,731.4 rpm/oz-in
Speed Constant	1,196 rpm/Volt	77 %	77 %
Motor Constant	2.49 mNm/√Watt	25.36 gcm/√Watt	0.35 oz-in/√Watt
Commutation Type	Precious Metal	Precious Metal	Precious Metal
Rated Power @ 8,295 rpm	1.3 Watts	1.3 Watts	1.3 Watts
Rated Torque @ 8,295 rpm	1.5 mNm	15.5 gcm	0.2 oz-in
Rated Current @ 8,295 rpm	0.190 Amps	0.190 Amps	0.190 Amps

Part Number: How to Order C16P09SD010

Ratings are at 25°C Ambient Temperature.

Radial Load Rating	1.4 N	Radial Play	0.020 mm	Max Temperature	65 °C
Radial Load Distance	4 mm	Thrust Play	0.150 mm	Min Temperature	-20 °C
Axial Load	0.80 N	Magnet Type	NdFeB	Max Winding Temp	85 °C
Press Fit Force - Max	15.00 N	Bearing Type	Sleeve Bearings	Mass	19 grams
Gearbox Options	P16 Planetary Gearbox				
Encoder Options	N/A				
Options - Other	Ball Bearings. Shaft length. Lubricants. Leads. Solder Tabs. Connectors.				

Global Motion Products

Distributed by:

Precision Motion Distributors: (925) 803-9565

Technical Support: (760) 451-2723

http://www.gmpwebsite.com Email: info@gmpwebsite.com

Commutation Type:

Precious Metal

Manufactured under a
Certified ISO 9001:2008
Quality System

RoHS Compliant

B - August 2011

Specifications Subject to change without notice

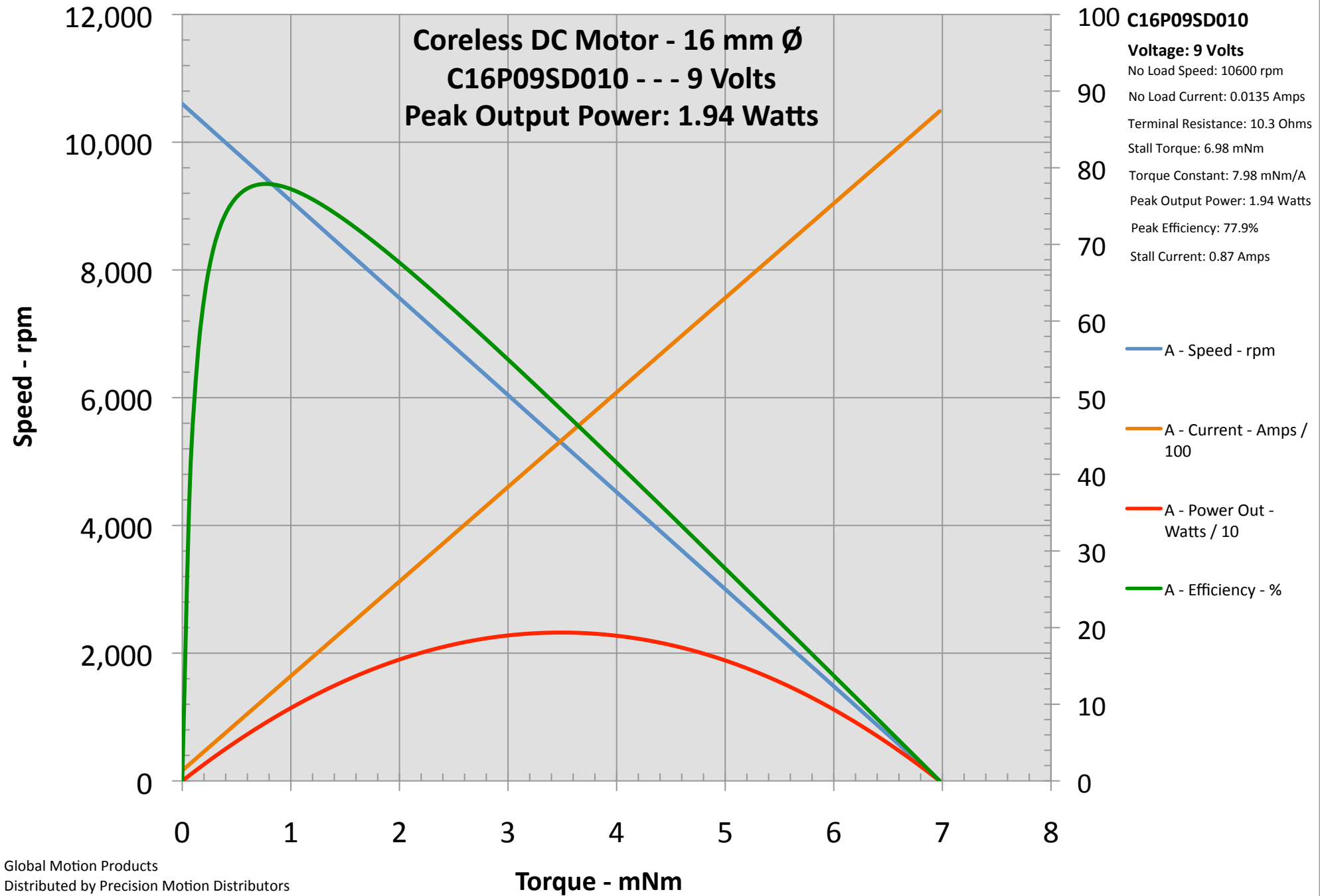

C16P09SD010
Voltage: 9 Volts
 No Load Speed: 10600 rpm
 No Load Current: 0.0135 Amps
 Terminal Resistance: 10.3 Ohms
 Stall Torque: 6.98 mNm
 Torque Constant: 7.98 mNm/A
 Peak Output Power: 1.94 Watts
 Peak Efficiency: 77.9%
 Stall Current: 0.87 Amps

Global Motion Products
 Distributed by Precision Motion Distributors
 (760) 451-2723, (925) 803-9565
<http://www.gmpwebsite.com>
 Email: info@gmpwebsite.com

This Graph is provided free of charge and without any representations or warranties, express or implied, as to its suitability, legal effect, completeness, currentness, accuracy, and/or appropriateness. The simulation is with Nominal Values. The Graph is provided "as is", "as available", and with "all faults" and we disclaim any warranties, including but not limited to the motor or gearmotor's warranties of merchantability and fitness for a particular purpose. This Graph may be inappropriate for your particular circumstances. This is a simple mathematical simulation of a speed/torque curve for information purposes only. **IT IS NOT TEST DATA.**

January 18, 2011

CAUTION: Peak Output Power is NOT a RATING. This is merely a calculated value and does not address Thermal Issues.

Coreless DC Motor - 16 mm Ø

C16P12SD000

0.9 Watts Peak Power



Global Motion Products

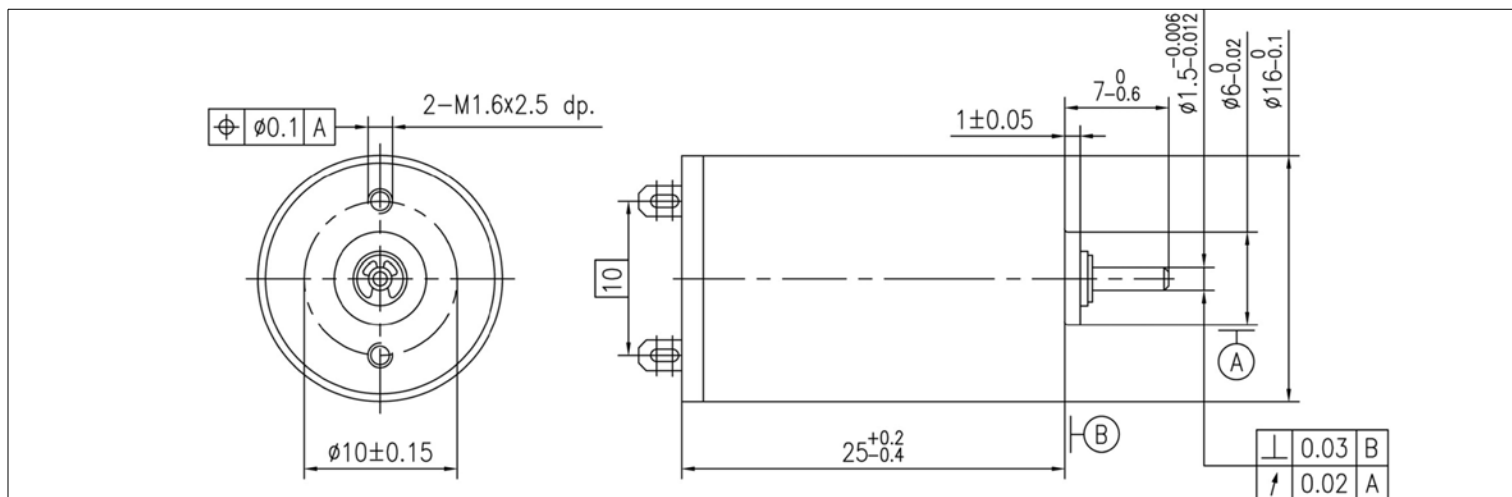

Not to Scale - Dimensions in millimeters (mm)

Nominal Voltage	12.0 Volts	12.0 Volts	12.0 Volts
No-Load Speed	8,820 rpm	8,820 rpm	8,820 rpm
Stall Torque	4.0 mNm	40.9 gcm	0.6 oz-in
No-Load Current	0.006 Amps	0.006 Amps	0.006 Amps
Peak Output Power	0.9 Watts	0.9 Watts	0.9 Watts
Torque Constant	12.76 mNm/A	130.08 gcm/A	1.81 oz-in/A
Terminal Resistance	38.20 Ohms	38.20 Ohms	38.20 Ohms
Back-EMF Constant	1.34 V/krpm	1.34 V/krpm	1.34 V/krpm
Mechanical Time Constant	13.4 msec	13.4 msec	13.4 msec
Rotor Inertia	0.57 kgm ² x10 ⁻⁷	0.57 gm cm ²	0.08 x10 ⁻⁴ oz-in-sec ²
Mechanical Time Constant	13.4 msec	13.4 msec	13.4 msec
Slope of Speed/Torque Curve	2,201.0 rpm/mNm	215.8 rpm/gcm	15,542.4 rpm/oz-in
Speed Constant	749 rpm/Volt	75 %	75 %
Motor Constant	2.06 mNm/√Watt	21.05 gcm/√Watt	0.29 oz-in/√Watt
Commutation Type	Precious Metal	Precious Metal	Precious Metal
Rated Power @ 6,686 rpm	0.7 Watts	0.7 Watts	0.7 Watts
Rated Torque @ 6,686 rpm	1.0 mNm	9.9 gcm	0.1 oz-in
Rated Current @ 6,686 rpm	0.076 Amps	0.076 Amps	0.076 Amps

Part Number: How to Order C16P12SD000

Ratings are at 25°C Ambient Temperature.

Radial Load Rating	1.4 N	Radial Play	0.020 mm	Max Temperature	65 °C
Radial Load Distance	4 mm	Thrust Play	0.150 mm	Min Temperature	-20 °C
Axial Load	0.80 N	Magnet Type	NdFeB	Max Winding Temp	85 °C
Press Fit Force - Max	15.00 N	Bearing Type	Sleeve Bearings	Mass	19 grams
Gearbox Options	P16 Planetary Gearbox				
Encoder Options	N/A				
Options - Other	Ball Bearings. Shaft length. Lubricants. Leads. Solder Tabs. Connectors.				

Global Motion Products

Distributed by:

Precision Motion Distributors: (925) 803-9565

Technical Support: (760) 451-2723

http://www.gmpwebsite.com Email: info@gmpwebsite.com

Commutation Type:

Precious Metal

Manufactured under a
Certified ISO 9001:2008
Quality System

RoHS Compliant

B - August 2011

Specifications Subject to change without notice

Coreless DC Motor - 16 mm Ø
C16P12SD000 - - - 12 Volts
Peak Output Power: 0.93 Watts

100 C16P12SD000
Voltage: 12 Volts
 No Load Speed: 8820 rpm
 No Load Current: 0.0057 Amps
 Terminal Resistance: 38.2 Ohms
 Stall Torque: 4.01 mNm
 Torque Constant: 12.76 mNm/A
 Peak Output Power: 0.93 Watts
 Peak Efficiency: 76.3%
 Stall Current: 0.31 Amps

Speed - rpm

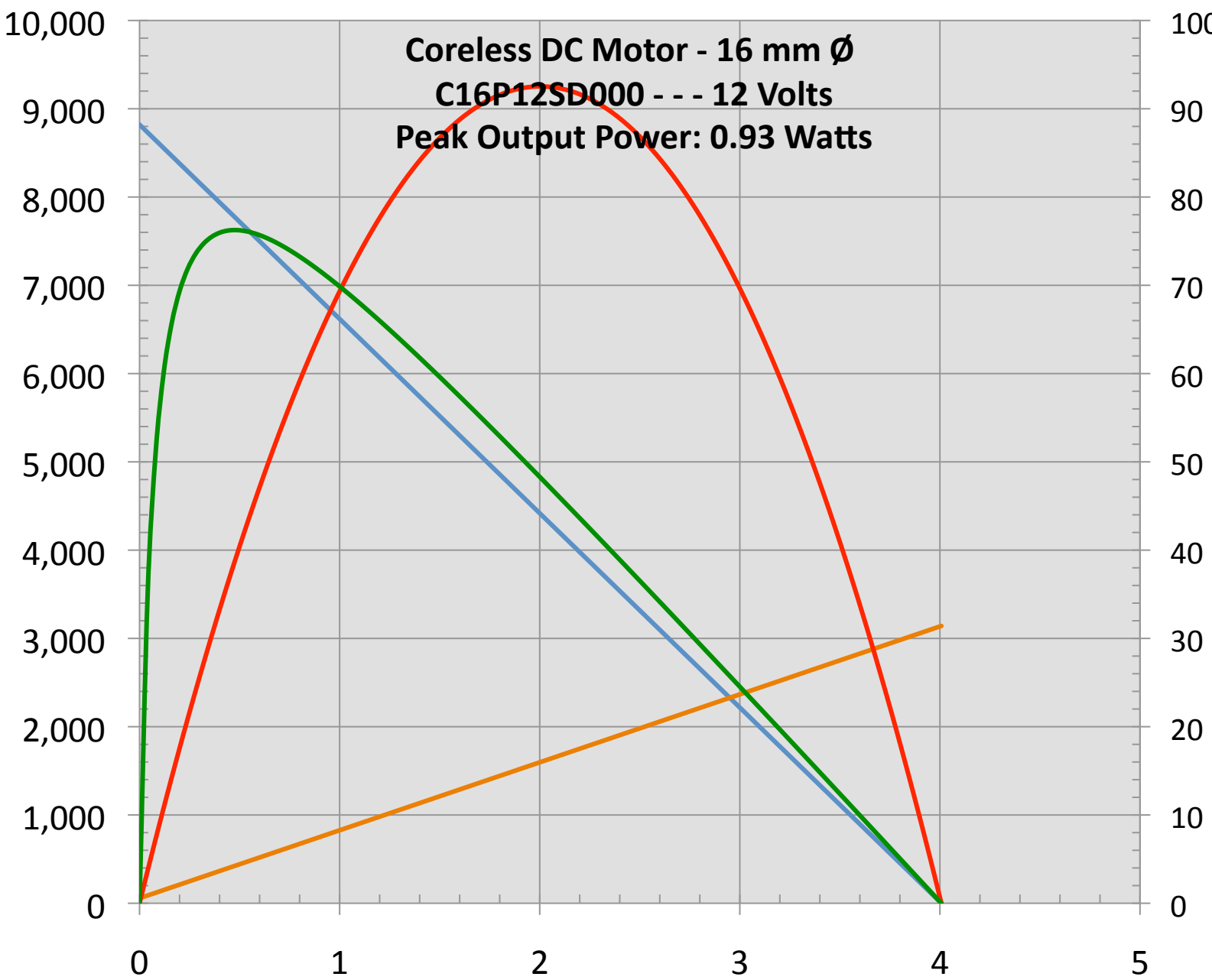

— A - Speed - rpm
 — A - Current - Amps / 100
 — A - Power Out - Watts / 100
 — A - Efficiency - %

Torque - mNm

Global Motion Products
 Distributed by Precision Motion Distributors
 (760) 451-2723, (925) 803-9565
<http://www.gmpwebsite.com>
 Email: info@gmpwebsite.com

This Graph is provided free of charge and without any representations or warranties, express or implied, as to its suitability, legal effect, completeness, currentness, accuracy, and/or appropriateness. The simulation is with Nominal Values. The Graph is provided "as is", "as available", and with "all faults" and we disclaim any warranties, including but not limited to the motor or gearmotor's warranties of merchantability and fitness for a particular purpose. This Graph may be inappropriate for your particular circumstances. This is a simple mathematical simulation of a speed/torque curve for information purposes only. **IT IS NOT TEST DATA.**

January 18, 2011

CAUTION: Peak Output Power is NOT a RATING. This is merely a calculated value and does not address Thermal Issues.

Coreless DC Motor - 16 mm Ø

C16P12SD010 1.3 Watts Peak Power



Global Motion Products

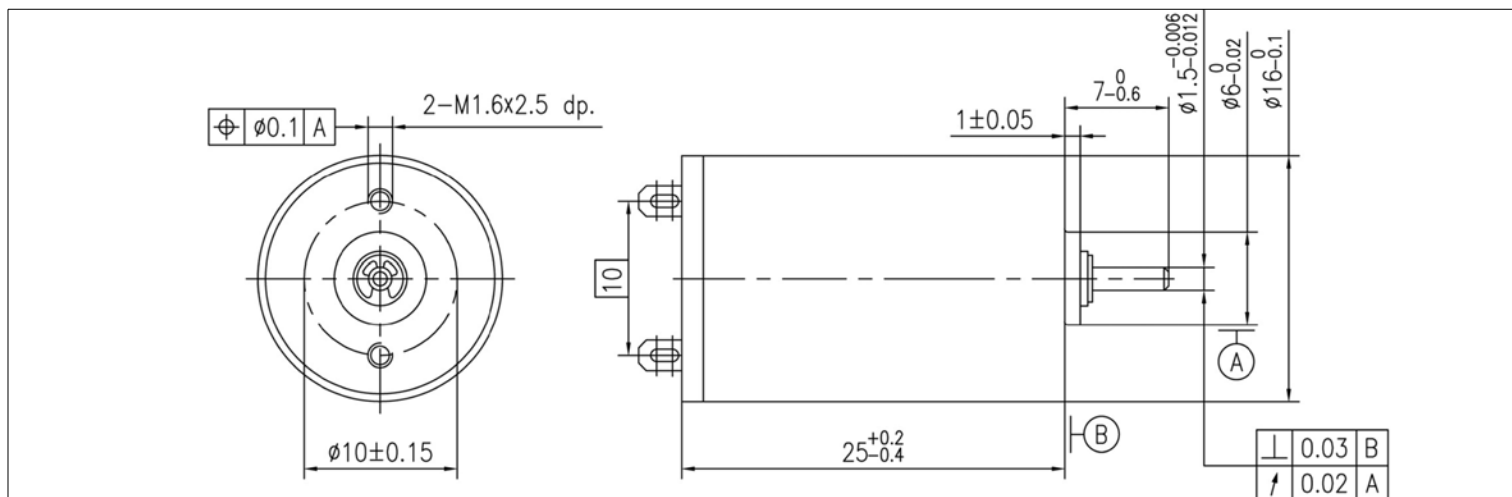

Not to Scale - Dimensions in millimeters (mm)

Nominal Voltage	12.0 Volts	12.0 Volts	12.0 Volts
No-Load Speed	10,400 rpm	10,400 rpm	10,400 rpm
Stall Torque	5.0 mNm	50.9 gcm	0.7 oz-in
No-Load Current	0.009 Amps	0.009 Amps	0.009 Amps
Peak Output Power	1.3 Watts	1.3 Watts	1.3 Watts
Torque Constant	10.81 mNm/A	110.24 gcm/A	1.53 oz-in/A
Terminal Resistance	26.00 Ohms	26.00 Ohms	26.00 Ohms
Back-EMF Constant	1.13 V/krpm	1.13 V/krpm	1.13 V/krpm
Mechanical Time Constant	14.5 msec	14.5 msec	14.5 msec
Rotor Inertia	0.65 kgm ² x10 ⁻⁷	0.65 gm cm ²	0.09 x10 ⁻⁴ oz-in-sec ²
Mechanical Time Constant	14.5 msec	14.5 msec	14.5 msec
Slope of Speed/Torque Curve	2,084.3 rpm/mNm	204.4 rpm/gcm	14,718.7 rpm/oz-in
Speed Constant	883 rpm/Volt	74 %	74 %
Motor Constant	2.12 mNm/√Watt	21.62 gcm/√Watt	0.30 oz-in/√Watt
Commutation Type	Precious Metal	Precious Metal	Precious Metal
Rated Power @ 7,223 rpm	1.1 Watts	1.1 Watts	1.1 Watts
Rated Torque @ 7,223 rpm	1.5 mNm	15.6 gcm	0.2 oz-in
Rated Current @ 7,223 rpm	0.141 Amps	0.141 Amps	0.141 Amps

Part Number: How to Order C16P12SD010

Ratings are at 25°C Ambient Temperature.

Radial Load Rating	1.4 N	Radial Play	0.020 mm	Max Temperature	65 °C
Radial Load Distance	4 mm	Thrust Play	0.150 mm	Min Temperature	-20 °C
Axial Load	0.80 N	Magnet Type	NdFeB	Max Winding Temp	85 °C
Press Fit Force - Max	15.00 N	Bearing Type	Sleeve Bearings	Mass	19 grams
Gearbox Options	P16 Planetary Gearbox				
Encoder Options	N/A				
Options - Other	Ball Bearings. Shaft length. Lubricants. Leads. Solder Tabs. Connectors.				

Global Motion Products

Distributed by:

Precision Motion Distributors: (925) 803-9565

Technical Support: (760) 451-2723

http://www.gmpwebsite.com Email: info@gmpwebsite.com

Commutation Type:

Precious Metal

Manufactured under a
Certified ISO 9001:2008
Quality System

RoHS Compliant

B - August 2011

Specifications Subject to change without notice

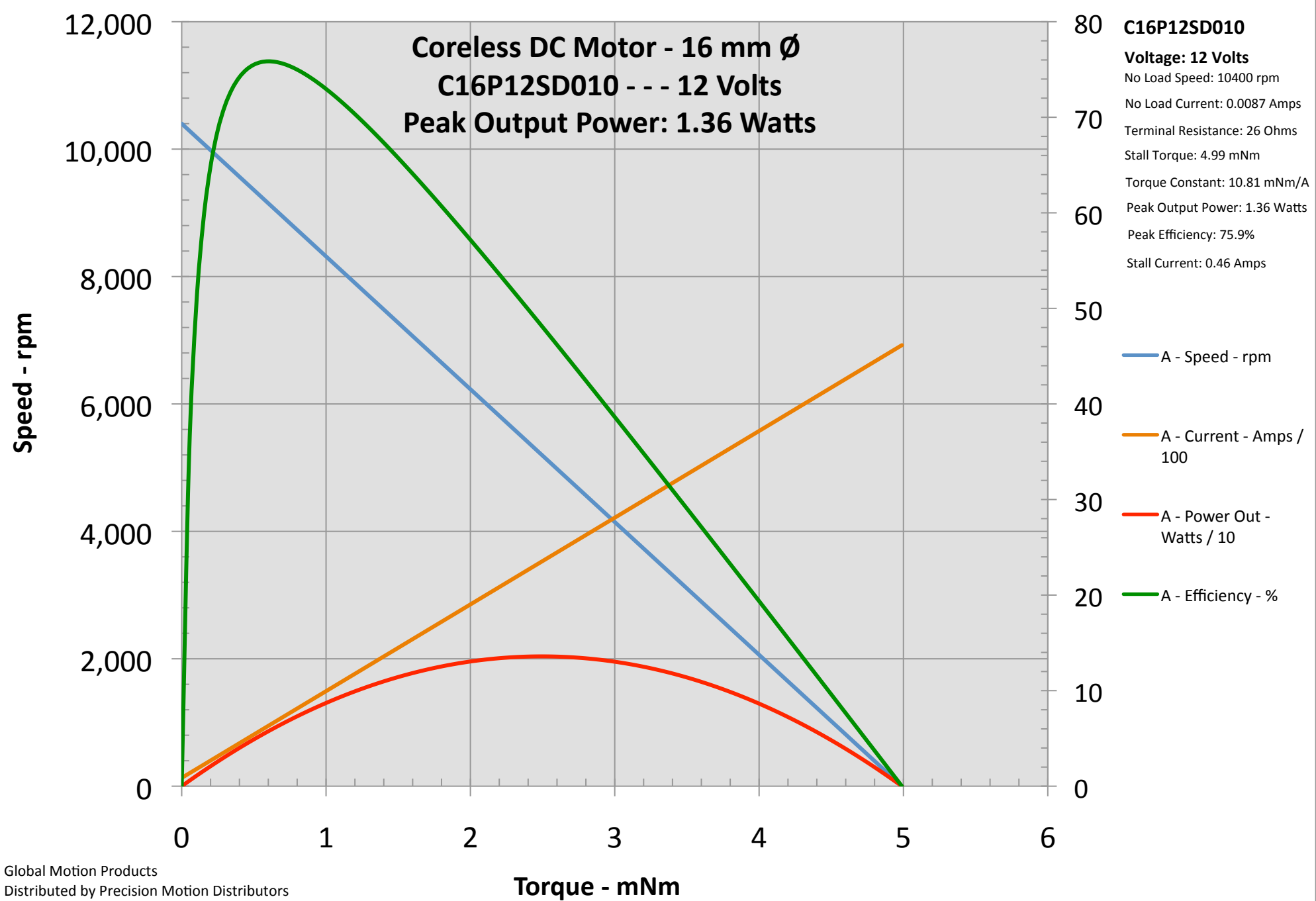

C16P12SD010
Voltage: 12 Volts
 No Load Speed: 10400 rpm
 No Load Current: 0.0087 Amps
 Terminal Resistance: 26 Ohms
 Stall Torque: 4.99 mNm
 Torque Constant: 10.81 mNm/A
 Peak Output Power: 1.36 Watts
 Peak Efficiency: 75.9%
 Stall Current: 0.46 Amps

- A - Speed - rpm
- A - Current - Amps / 100
- A - Power Out - Watts / 10
- A - Efficiency - %

Global Motion Products
 Distributed by Precision Motion Distributors
 (760) 451-2723, (925) 803-9565
<http://www.gmpwebsite.com>
 Email: info@gmpwebsite.com

This Graph is provided free of charge and without any representations or warranties, express or implied, as to its suitability, legal effect, completeness, currentness, accuracy, and/or appropriateness. The simulation is with Nominal Values. The Graph is provided "as is", "as available", and with "all faults" and we disclaim any warranties, including but not limited to the motor or gearmotor's warranties of merchantability and fitness for a particular purpose. This Graph may be inappropriate for your particular circumstances. This is a simple mathematical simulation of a speed/torque curve for information purposes only. **IT IS NOT TEST DATA.**

January 18, 2011

CAUTION: Peak Output Power is NOT a RATING. This is merely a calculated value and does not address Thermal Issues.