

Coreless DC Motor - 16 mm Ø

C16P03SE000

2.4 Watts Peak Power



Global Motion Products

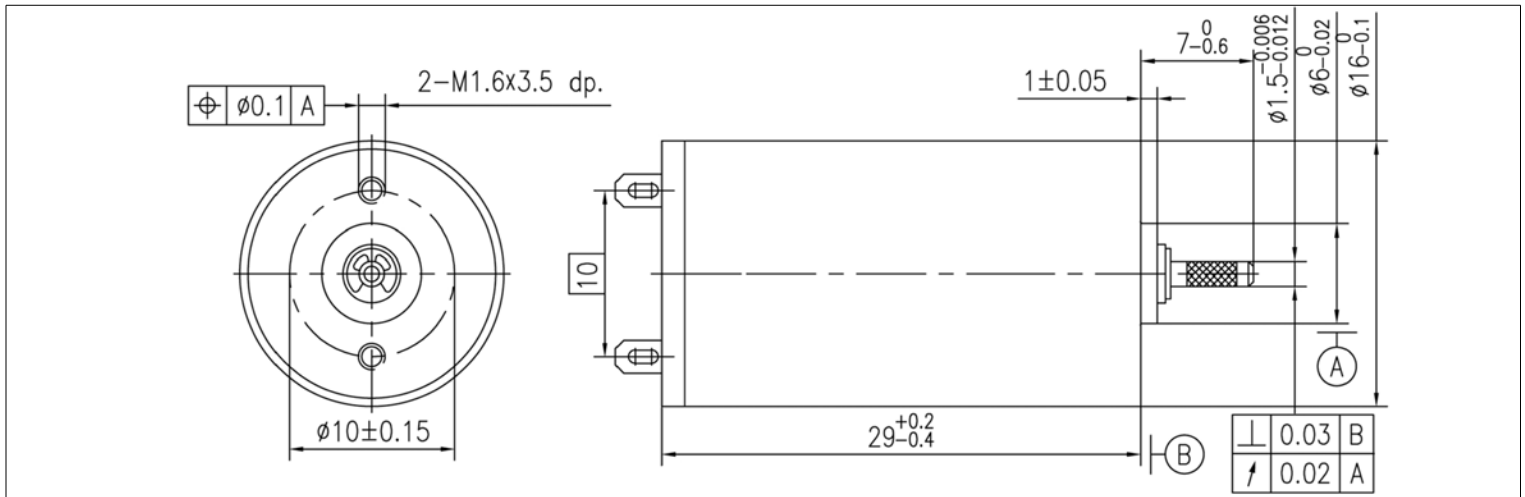

Not to Scale - Dimensions in millimeters (mm)

Nominal Voltage	3.0 Volts	3.0 Volts	3.0 Volts
No-Load Speed	10,200 rpm	10,200 rpm	10,200 rpm
Stall Torque	8.9 mNm	91.1 gcm	1.3 oz-in
No-Load Current	0.045 Amps	0.045 Amps	0.045 Amps
Peak Output Power	2.4 Watts	2.4 Watts	2.4 Watts
Torque Constant	2.77 mNm/A	28.24 gcm/A	0.39 oz-in/A
Terminal Resistance	0.93 Ohms	0.93 Ohms	0.93 Ohms
Back-EMF Constant	0.29 V/krpm	0.29 V/krpm	0.29 V/krpm
Mechanical Time Constant	16.1 msec	16.1 msec	16.1 msec
Rotor Inertia	1.33 kgm ² x10 ⁻⁷	1.33 gm cm ²	0.19 x10 ⁻⁴ oz-in-sec ²
Mechanical Time Constant	16.1 msec	16.1 msec	16.1 msec
Slope of Speed/Torque Curve	1,141.7 rpm/mNm	112.0 rpm/gcm	8,062.5 rpm/oz-in
Speed Constant	3,448 rpm/Volt	78 %	78 %
Motor Constant	2.87 mNm/√Watt	29.28 gcm/√Watt	0.41 oz-in/√Watt
Commutation Type	Precious Metal	Precious Metal	Precious Metal
Rated Power @ 8,362 rpm	1.4 Watts	1.4 Watts	1.4 Watts
Rated Torque @ 8,362 rpm	1.6 mNm	16.4 gcm	0.2 oz-in
Rated Current @ 8,362 rpm	0.580 Amps	0.580 Amps	0.580 Amps

Part Number: How to Order C16P03SE000

Ratings are at 25°C Ambient Temperature.

Radial Load Rating	1.4 N	Radial Play	0.020 mm	Max Temperature	65 °C
Radial Load Distance	4 mm	Thrust Play	0.150 mm	Min Temperature	-20 °C
Axial Load	0.80 N	Magnet Type	NdFeB	Max Winding Temp	85 °C
Press Fit Force - Max	15.00 N	Bearing Type	Sleeve Bearings	Mass	22 grams
Gearbox Options	P16 Planetary Gearbox				
Encoder Options	N/A				
Options - Other	Ball Bearings. Shaft length. Lubricants. Leads. Solder Tabs. Connectors.				

Global Motion Products

Distributed by:

Precision Motion Distributors: (925) 803-9565

Technical Support: (760) 451-2723

http://www.gmpwebsite.com Email: info@gmpwebsite.com

Commutation Type:

Precious Metal

Manufactured under a
Certified ISO 9001:2008
Quality System

RoHS Compliant

B - August 2011

Specifications Subject to change without notice

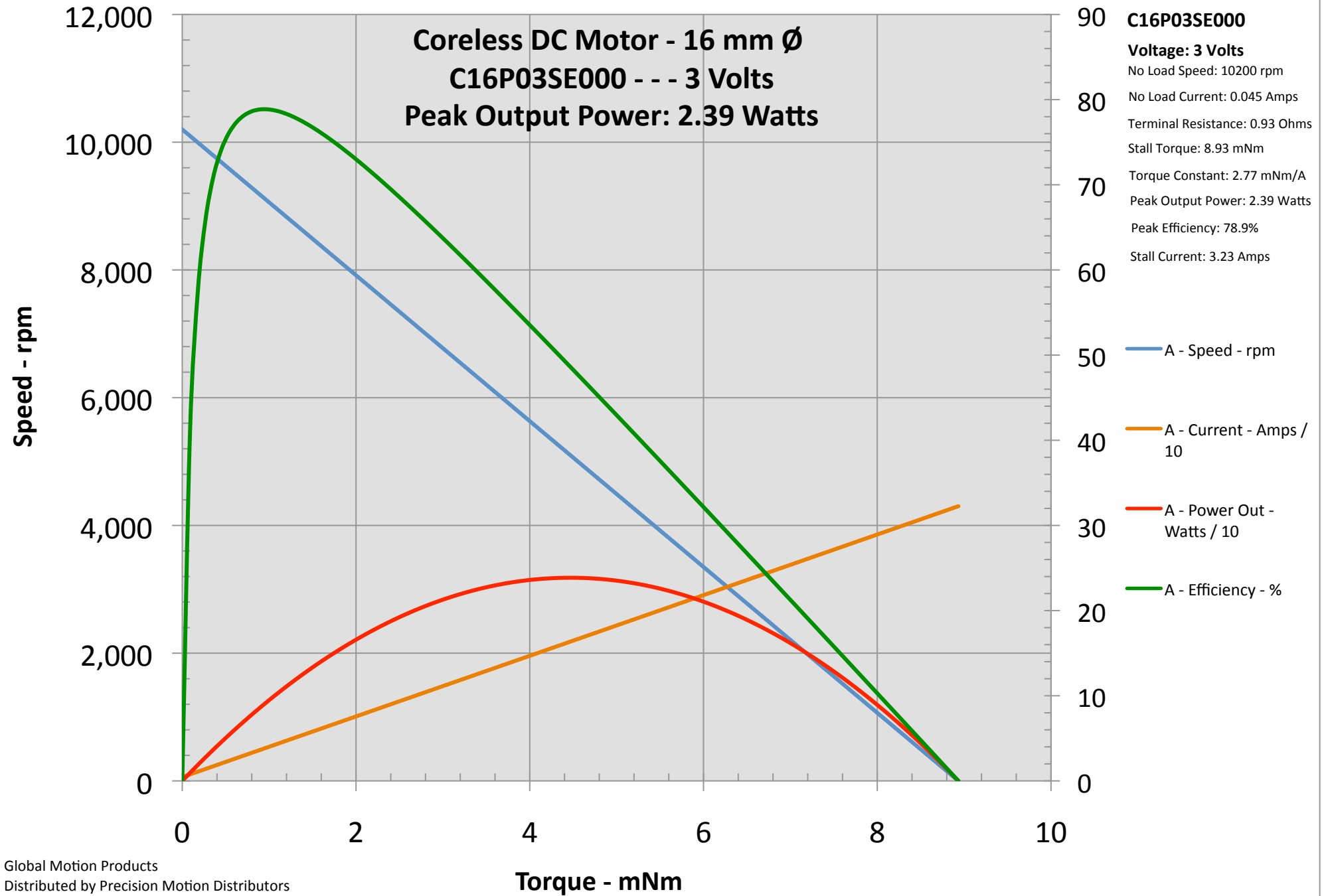

Global Motion Products
 Distributed by Precision Motion Distributors
 (760) 451-2723, (925) 803-9565
<http://www.gmpwebsite.com>
 Email: info@gmpwebsite.com

This Graph is provided free of charge and without any representations or warranties, express or implied, as to its suitability, legal effect, completeness, currentness, accuracy, and/or appropriateness. The simulation is with Nominal Values. The Graph is provided "as is", "as available", and with "all faults" and we disclaim any warranties, including but not limited to the motor or gearmotor's warranties of merchantability and fitness for a particular purpose. This Graph may be inappropriate for your particular circumstances. This is a simple mathematical simulation of a speed/torque curve for information purposes only. **IT IS NOT TEST DATA.**

January 18, 2011

CAUTION: Peak Output Power is NOT a RATING. This is merely a calculated value and does not address Thermal Issues.

Coreless DC Motor - 16 mm Ø

C16P06SE000

2.0 Watts Peak Power



Global Motion Products

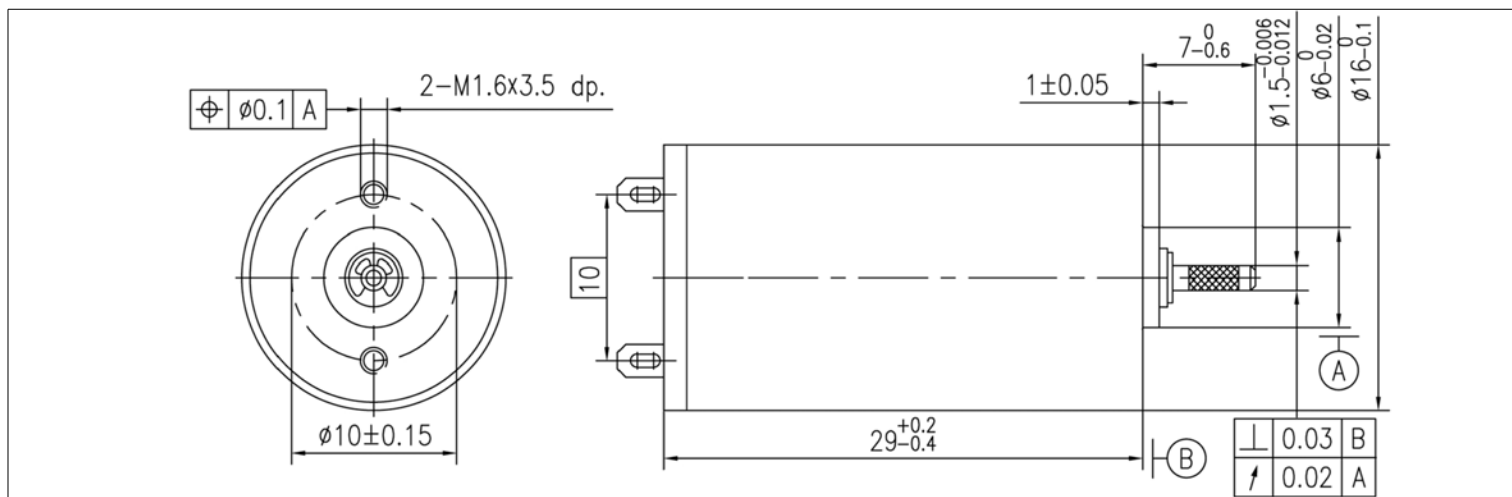

Not to Scale - Dimensions in millimeters (mm)

Nominal Voltage	6.0 Volts	6.0 Volts	6.0 Volts
No-Load Speed	10,300 rpm	10,300 rpm	10,300 rpm
Stall Torque	7.4 mNm	75.5 gcm	1.0 oz-in
No-Load Current	0.020 Amps	0.020 Amps	0.020 Amps
Peak Output Power	2.0 Watts	2.0 Watts	2.0 Watts
Torque Constant	5.48 mNm/A	55.88 gcm/A	0.78 oz-in/A
Terminal Resistance	4.44 Ohms	4.44 Ohms	4.44 Ohms
Back-EMF Constant	0.57 V/krpm	0.57 V/krpm	0.57 V/krpm
Mechanical Time Constant	11.4 msec	11.4 msec	11.4 msec
Rotor Inertia	0.77 kgm ² x10 ⁻⁷	0.77 gm cm ²	0.11 x10 ⁻⁴ oz-in-sec ²
Mechanical Time Constant	11.4 msec	11.4 msec	11.4 msec
Slope of Speed/Torque Curve	1,391.0 rpm/mNm	136.4 rpm/gcm	9,822.5 rpm/oz-in
Speed Constant	1,743 rpm/Volt	77 %	77 %
Motor Constant	2.60 mNm/√Watt	26.52 gcm/√Watt	0.37 oz-in/√Watt
Commutation Type	Precious Metal	Precious Metal	Precious Metal
Rated Power @ 7,937 rpm	1.4 Watts	1.4 Watts	1.4 Watts
Rated Torque @ 7,937 rpm	1.7 mNm	17.3 gcm	0.2 oz-in
Rated Current @ 7,937 rpm	0.310 Amps	0.310 Amps	0.310 Amps

Part Number: How to Order C16P06SE000

Ratings are at 25°C Ambient Temperature.

Radial Load Rating	1.4 N	Radial Play	0.020 mm	Max Temperature	65 °C
Radial Load Distance	4 mm	Thrust Play	0.150 mm	Min Temperature	-20 °C
Axial Load	0.80 N	Magnet Type	NdFeB	Max Winding Temp	85 °C
Press Fit Force - Max	15.00 N	Bearing Type	Sleeve Bearings	Mass	22 grams
Gearbox Options	P16 Planetary Gearbox				
Encoder Options	N/A				
Options - Other	Ball Bearings. Shaft length. Lubricants. Leads. Solder Tabs. Connectors.				

Global Motion Products

Distributed by:

Precision Motion Distributors: (925) 803-9565

Technical Support: (760) 451-2723

http://www.gmpwebsite.com Email: info@gmpwebsite.com

Commutation Type:

Precious Metal

Manufactured under a
Certified ISO 9001:2008
Quality System

RoHS Compliant

B - August 2011

Specifications Subject to change without notice

Coreless DC Motor - 16 mm Ø
C16P06SE000 - - - 6 Volts
Peak Output Power: 2 Watts

C16P06SE000
Voltage: 6 Volts
 No Load Speed: 10300 rpm
 No Load Current: 0.0202 Amps
 Terminal Resistance: 4.44 Ohms
 Stall Torque: 7.4 mNm
 Torque Constant: 5.48 mNm/A
 Peak Output Power: 2 Watts
 Peak Efficiency: 78.2%
 Stall Current: 1.35 Amps

Speed - rpm

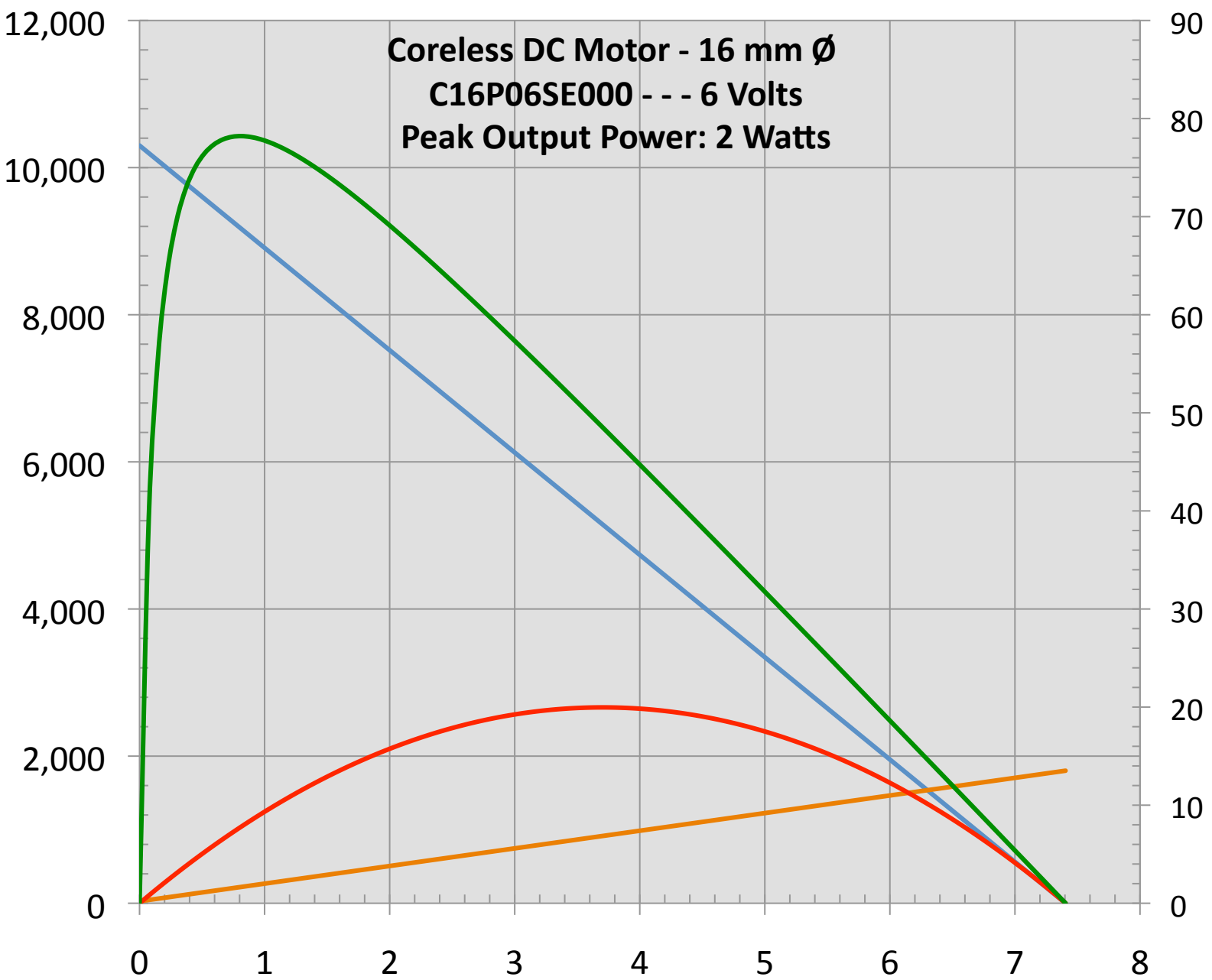

— A - Speed - rpm
 — A - Current - Amps / 10
 — A - Power Out - Watts / 10
 — A - Efficiency - %

Torque - mNm

Global Motion Products
 Distributed by Precision Motion Distributors
 (760) 451-2723, (925) 803-9565
<http://www.gmpwebsite.com>
 Email: info@gmpwebsite.com

This Graph is provided free of charge and without any representations or warranties, express or implied, as to its suitability, legal effect, completeness, currentness, accuracy, and/or appropriateness. The simulation is with Nominal Values. The Graph is provided "as is", "as available", and with "all faults" and we disclaim any warranties, including but not limited to the motor or gearmotor's warranties of merchantability and fitness for a particular purpose. This Graph may be inappropriate for your particular circumstances. This is a simple mathematical simulation of a speed/torque curve for information purposes only. **IT IS NOT TEST DATA.**

January 18, 2011

CAUTION: Peak Output Power is NOT a RATING. This is merely a calculated value and does not address Thermal Issues.

Coreless DC Motor - 16 mm Ø

C16P09SE000

2.3 Watts Peak Power



Global Motion Products

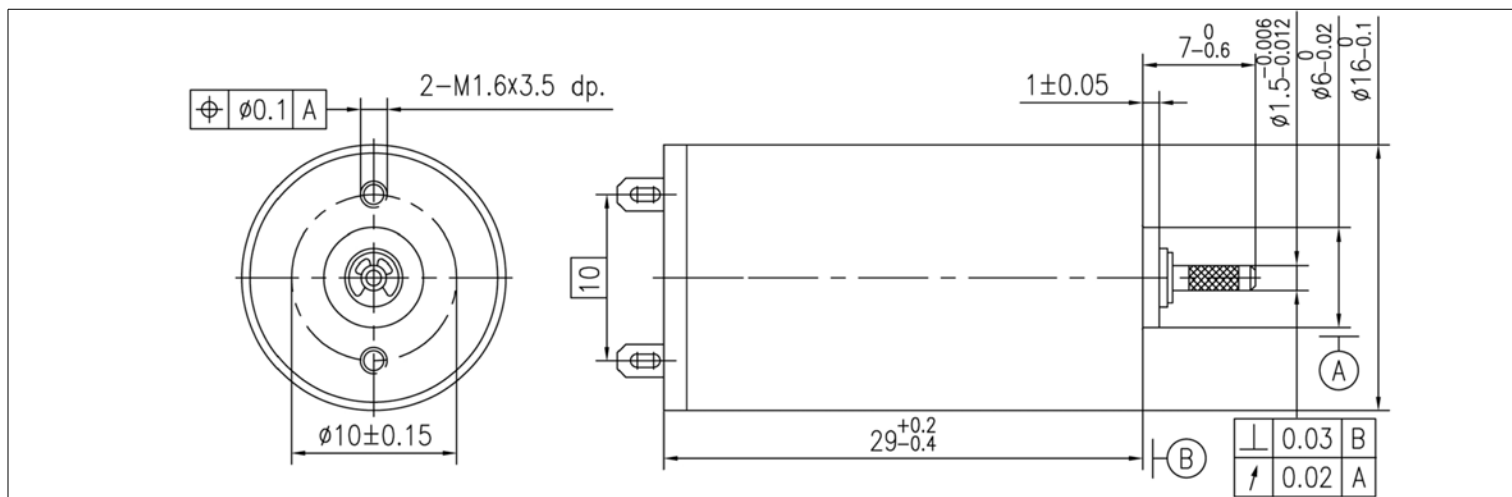

Not to Scale - Dimensions in millimeters (mm)

Nominal Voltage	9.0 Volts	9.0 Volts	9.0 Volts
No-Load Speed	10,600 rpm	10,600 rpm	10,600 rpm
Stall Torque	8.2 mNm	84.0 gcm	1.2 oz-in
No-Load Current	0.015 Amps	0.015 Amps	0.015 Amps
Peak Output Power	2.3 Watts	2.3 Watts	2.3 Watts
Torque Constant	7.99 mNm/A	81.46 gcm/A	1.13 oz-in/A
Terminal Resistance	8.73 Ohms	8.73 Ohms	8.73 Ohms
Back-EMF Constant	0.84 V/krpm	0.84 V/krpm	0.84 V/krpm
Mechanical Time Constant	18.2 msec	18.2 msec	18.2 msec
Rotor Inertia	1.33 kgm ² x10 ⁻⁷	1.33 gm cm ²	0.19 x10 ⁻⁴ oz-in-sec ²
Mechanical Time Constant	18.2 msec	18.2 msec	18.2 msec
Slope of Speed/Torque Curve	1,287.1 rpm/mNm	126.2 rpm/gcm	9,089.1 rpm/oz-in
Speed Constant	1,195 rpm/Volt	77 %	77 %
Motor Constant	2.70 mNm/√Watt	27.57 gcm/√Watt	0.38 oz-in/√Watt
Commutation Type	Precious Metal	Precious Metal	Precious Metal
Rated Power @ 7,958 rpm	1.7 Watts	1.7 Watts	1.7 Watts
Rated Torque @ 7,958 rpm	2.0 mNm	20.9 gcm	0.3 oz-in
Rated Current @ 7,958 rpm	0.257 Amps	0.257 Amps	0.257 Amps

Part Number: How to Order C16P09SE000

Ratings are at 25°C Ambient Temperature.

Radial Load Rating	1.4 N	Radial Play	0.020 mm	Max Temperature	65 °C
Radial Load Distance	4 mm	Thrust Play	0.150 mm	Min Temperature	-20 °C
Axial Load	0.80 N	Magnet Type	NdFeB	Max Winding Temp	85 °C
Press Fit Force - Max	15.00 N	Bearing Type	Sleeve Bearings	Mass	22 grams
Gearbox Options	P16 Planetary Gearbox				
Encoder Options	N/A				
Options - Other	Ball Bearings. Shaft length. Lubricants. Leads. Solder Tabs. Connectors.				

Global Motion Products

Distributed by:

Precision Motion Distributors: (925) 803-9565

Technical Support: (760) 451-2723

http://www.gmpwebsite.com Email: info@gmpwebsite.com

Commutation Type:

Precious Metal

Manufactured under a
Certified ISO 9001:2008
Quality System

RoHS Compliant

B - August 2011

Specifications Subject to change without notice

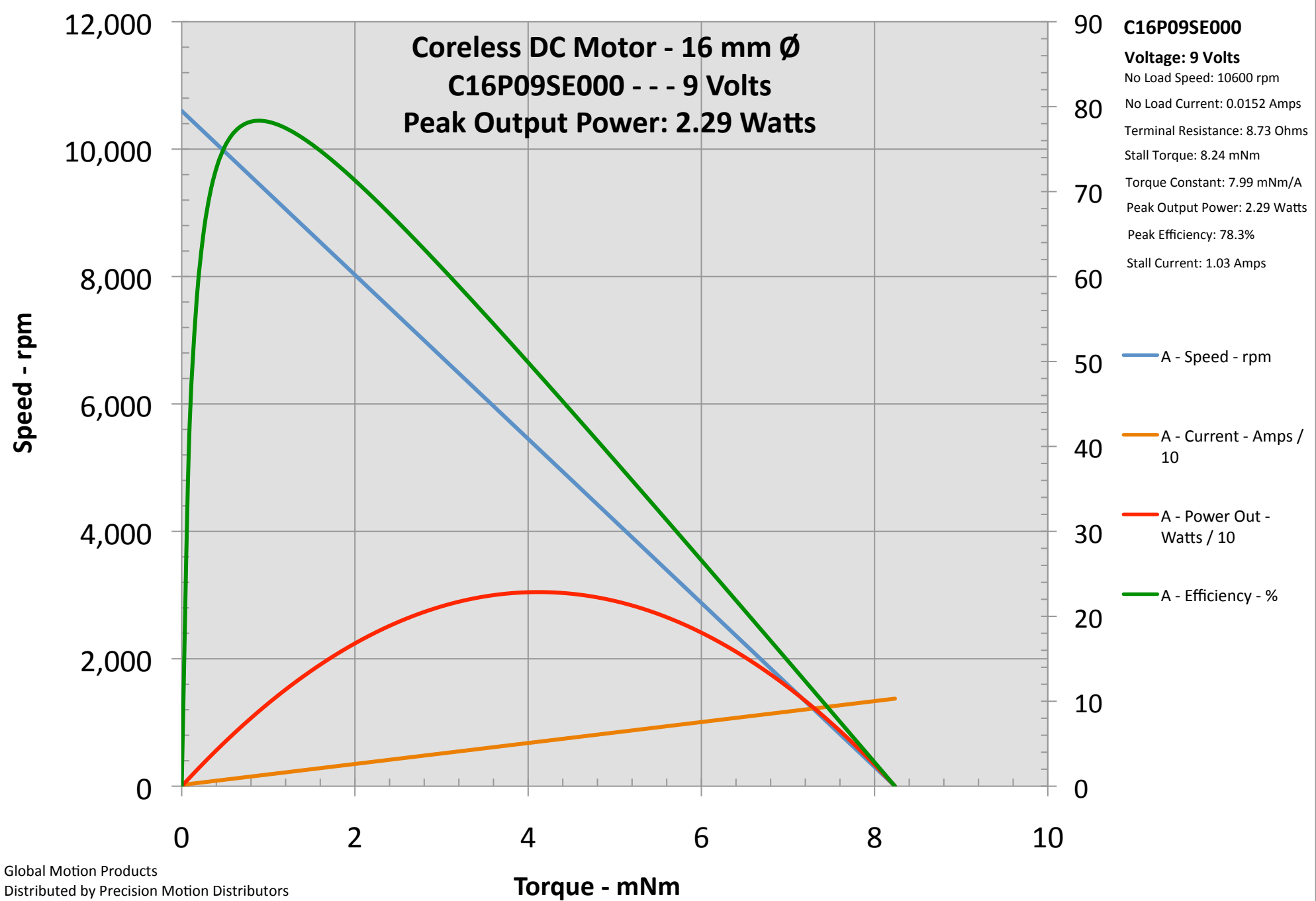

Global Motion Products
Distributed by Precision Motion Distributors
(760) 451-2723, (925) 803-9565
<http://www.gmpwebsite.com>
Email: info@gmpwebsite.com

This Graph is provided free of charge and without any representations or warranties, express or implied, as to its suitability, legal effect, completeness, currentness, accuracy, and/or appropriateness. The simulation is with Nominal Values. The Graph is provided "as is", "as available", and with "all faults" and we disclaim any warranties, including but not limited to the motor or gearmotor's warranties of merchantability and fitness for a particular purpose. This Graph may be inappropriate for your particular circumstances. This is a simple mathematical simulation of a speed/torque curve for information purposes only. **IT IS NOT TEST DATA.**

January 18, 2011

CAUTION: Peak Output Power is NOT a RATING. This is merely a calculated value and does not address Thermal Issues.

Coreless DC Motor - 16 mm Ø

C16P12SE000

1.9 Watts Peak Power



Global Motion Products

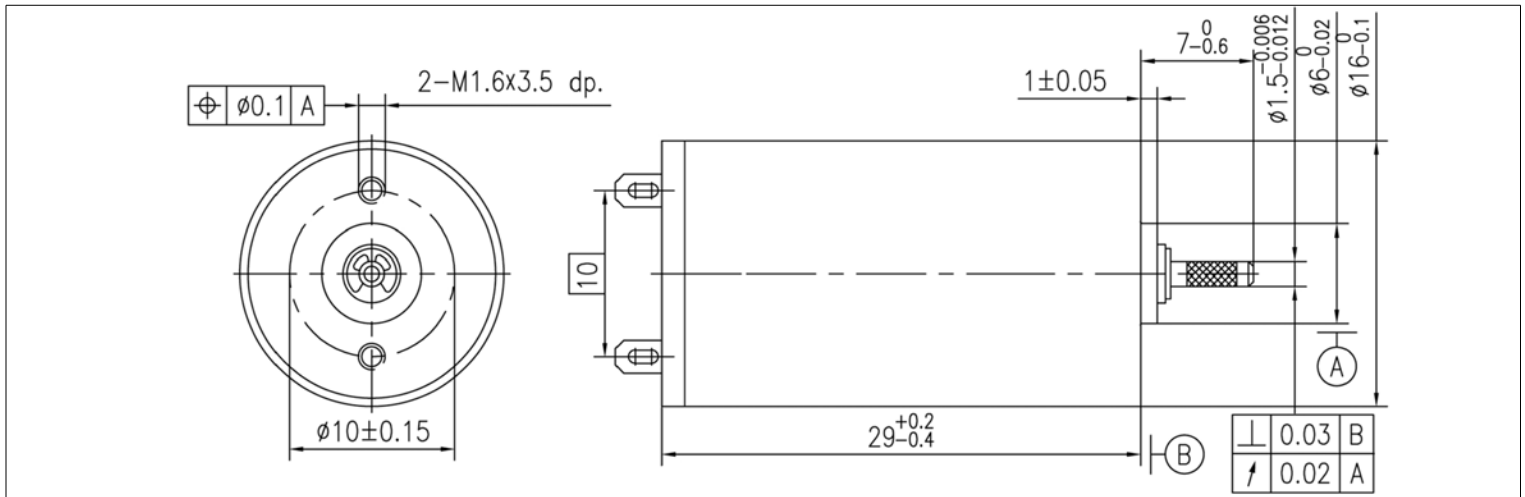

Not to Scale - Dimensions in millimeters (mm)

Nominal Voltage	12.0 Volts	12.0 Volts	12.0 Volts
No-Load Speed	10,200 rpm	10,200 rpm	10,200 rpm
Stall Torque	7.2 mNm	73.8 gcm	1.0 oz-in
No-Load Current	0.008 Amps	0.008 Amps	0.008 Amps
Peak Output Power	1.9 Watts	1.9 Watts	1.9 Watts
Torque Constant	11.09 mNm/A	113.14 gcm/A	1.57 oz-in/A
Terminal Resistance	18.40 Ohms	18.40 Ohms	18.40 Ohms
Back-EMF Constant	1.16 V/krpm	1.16 V/krpm	1.16 V/krpm
Mechanical Time Constant	16.4 msec	16.4 msec	16.4 msec
Rotor Inertia	1.10 kgm ² x10 ⁻⁷	1.10 gm cm ²	0.16 x10 ⁻⁴ oz-in-sec ²
Mechanical Time Constant	16.4 msec	16.4 msec	16.4 msec
Slope of Speed/Torque Curve	1,409.7 rpm/mNm	138.2 rpm/gcm	9,954.3 rpm/oz-in
Speed Constant	861 rpm/Volt	79 %	79 %
Motor Constant	2.59 mNm/√Watt	26.38 gcm/√Watt	0.37 oz-in/√Watt
Commutation Type	Precious Metal	Precious Metal	Precious Metal
Rated Power @ 7,651 rpm	1.4 Watts	1.4 Watts	1.4 Watts
Rated Torque @ 7,651 rpm	1.8 mNm	18.5 gcm	0.3 oz-in
Rated Current @ 7,651 rpm	0.163 Amps	0.163 Amps	0.163 Amps

Part Number: How to Order C16P12SE000

Ratings are at 25°C Ambient Temperature.

Radial Load Rating	1.4 N	Radial Play	0.020 mm	Max Temperature	65 °C
Radial Load Distance	4 mm	Thrust Play	0.150 mm	Min Temperature	-20 °C
Axial Load	0.80 N	Magnet Type	NdFeB	Max Winding Temp	85 °C
Press Fit Force - Max	15.00 N	Bearing Type	Sleeve Bearings	Mass	22 grams
Gearbox Options	P16 Planetary Gearbox				
Encoder Options	N/A				
Options - Other	Ball Bearings. Shaft length. Lubricants. Leads. Solder Tabs. Connectors.				

Global Motion Products

Distributed by:

Precision Motion Distributors: (925) 803-9565

Technical Support: (760) 451-2723

http://www.gmpwebsite.com Email: info@gmpwebsite.com

Commutation Type:

Precious Metal

Manufactured under a
Certified ISO 9001:2008
Quality System

RoHS Compliant

B - August 2011

Specifications Subject to change without notice

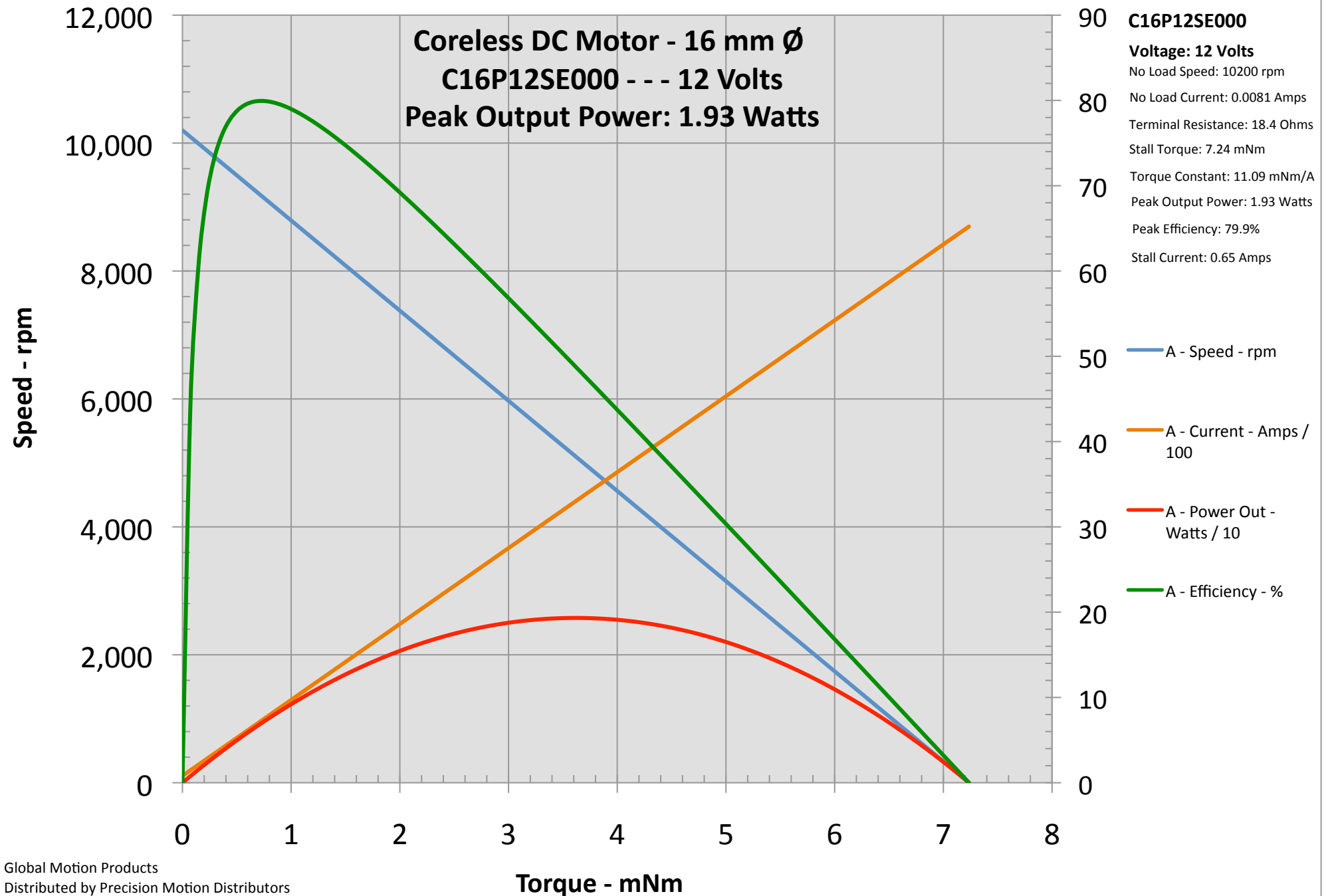

Global Motion Products
 Distributed by Precision Motion Distributors
 (760) 451-2723, (925) 803-9565
<http://www.gmpwebsite.com>
 Email: info@gmpwebsite.com

This Graph is provided free of charge and without any representations or warranties, express or implied, as to its suitability, legal effect, completeness, currentness, accuracy, and/or appropriateness. The simulation is with Nominal Values. The Graph is provided "as is", "as available", and with "all faults" and we disclaim any warranties, including but not limited to the motor or gearmotor's warranties of merchantability and fitness for a particular purpose. This Graph may be inappropriate for your particular circumstances. This is a simple mathematical simulation of a speed/torque curve for information purposes only. **IT IS NOT TEST DATA.**

January 18, 2011

CAUTION: Peak Output Power is NOT a RATING. This is merely a calculated value and does not address Thermal Issues.