

Coreless DC Motor - 16 mm Ø

C16P03SL000

3.3 Watts Peak Power



Global Motion Products

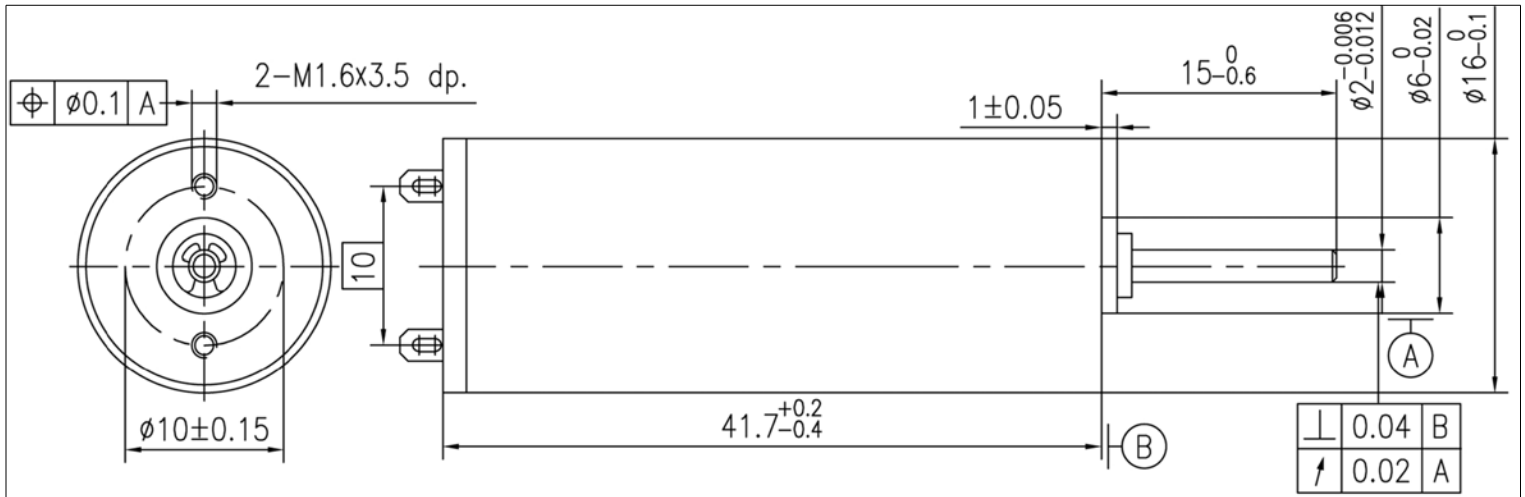

Not to Scale - Dimensions in millimeters (mm)

Nominal Voltage	3.0 Volts	3.0 Volts	3.0 Volts
No-Load Speed	8,400 rpm	8,400 rpm	8,400 rpm
Stall Torque	15.3 mNm	155.6 gcm	2.2 oz-in
No-Load Current	0.070 Amps	0.070 Amps	0.070 Amps
Peak Output Power	3.3 Watts	3.3 Watts	3.3 Watts

Torque Constant	3.36 mNm/A	34.24 gcm/A	0.48 oz-in/A
Terminal Resistance	0.66 Ohms	0.66 Ohms	0.66 Ohms
Back-EMF Constant	0.35 V/krpm	0.35 V/krpm	0.35 V/krpm
Mechanical Time Constant	10.9 msec	10.9 msec	10.9 msec
Rotor Inertia	1.86 kgm ² x10 ⁻⁷	1.86 gm cm ²	0.26 x10 ⁻⁴ oz-in-sec ²

Mechanical Time Constant	10.9 msec	10.9 msec	10.9 msec
Slope of Speed/Torque Curve	550.3 rpm/mNm	54.0 rpm/gcm	3,886.2 rpm/oz-in
Speed Constant	2,844 rpm/Volt	77 %	77 %
Motor Constant	4.13 mNm/√Watt	42.15 gcm/√Watt	0.59 oz-in/√Watt
Commutation Type	Precious Metal	Precious Metal	Precious Metal
Rated Power @ 7,328 rpm	1.5 Watts	1.5 Watts	1.5 Watts
Rated Torque @ 7,328 rpm	2.0 mNm	20.0 gcm	0.3 oz-in
Rated Current @ 7,328 rpm	0.460 Amps	0.460 Amps	0.460 Amps

Part Number: How to Order C16P03SL000

Ratings are at 25°C Ambient Temperature.

Radial Load Rating	1.4 N	Radial Play	0.020 mm	Max Temperature	65 °C
Radial Load Distance	4 mm	Thrust Play	0.150 mm	Min Temperature	-20 °C
Axial Load	0.80 N	Magnet Type	NdFeB	Max Winding Temp	85 °C
Press Fit Force - Max	15.00 N	Bearing Type	Sleeve Bearings	Mass	35 grams
Gearbox Options	P16 Planetary Gearbox				
Encoder Options	N/A				
Options - Other	Ball Bearings. Shaft length. Lubricants. Leads. Solder Tabs. Connectors.				

Global Motion Products

Distributed by:

Precision Motion Distributors: (925) 803-9565

Technical Support: (760) 451-2723

http://www.gmpwebsite.com Email: info@gmpwebsite.com

Commutation Type:

Precious Metal

Manufactured under a
Certified ISO 9001:2008
Quality System

RoHS Compliant

B - August 2011

Specifications Subject to change without notice

Coreless DC Motor - 16 mm Ø
C16P03SL000 - - - 3 Volts
Peak Output Power: 3.36 Watts

C16P03SL000
Voltage: 3 Volts
 No Load Speed: 8400 rpm
 No Load Current: 0.07 Amps
 Terminal Resistance: 0.66 Ohms
 Stall Torque: 15.26 mNm
 Torque Constant: 3.36 mNm/A
 Peak Output Power: 3.36 Watts
 Peak Efficiency: 77.9%
 Stall Current: 4.55 Amps

Speed - rpm

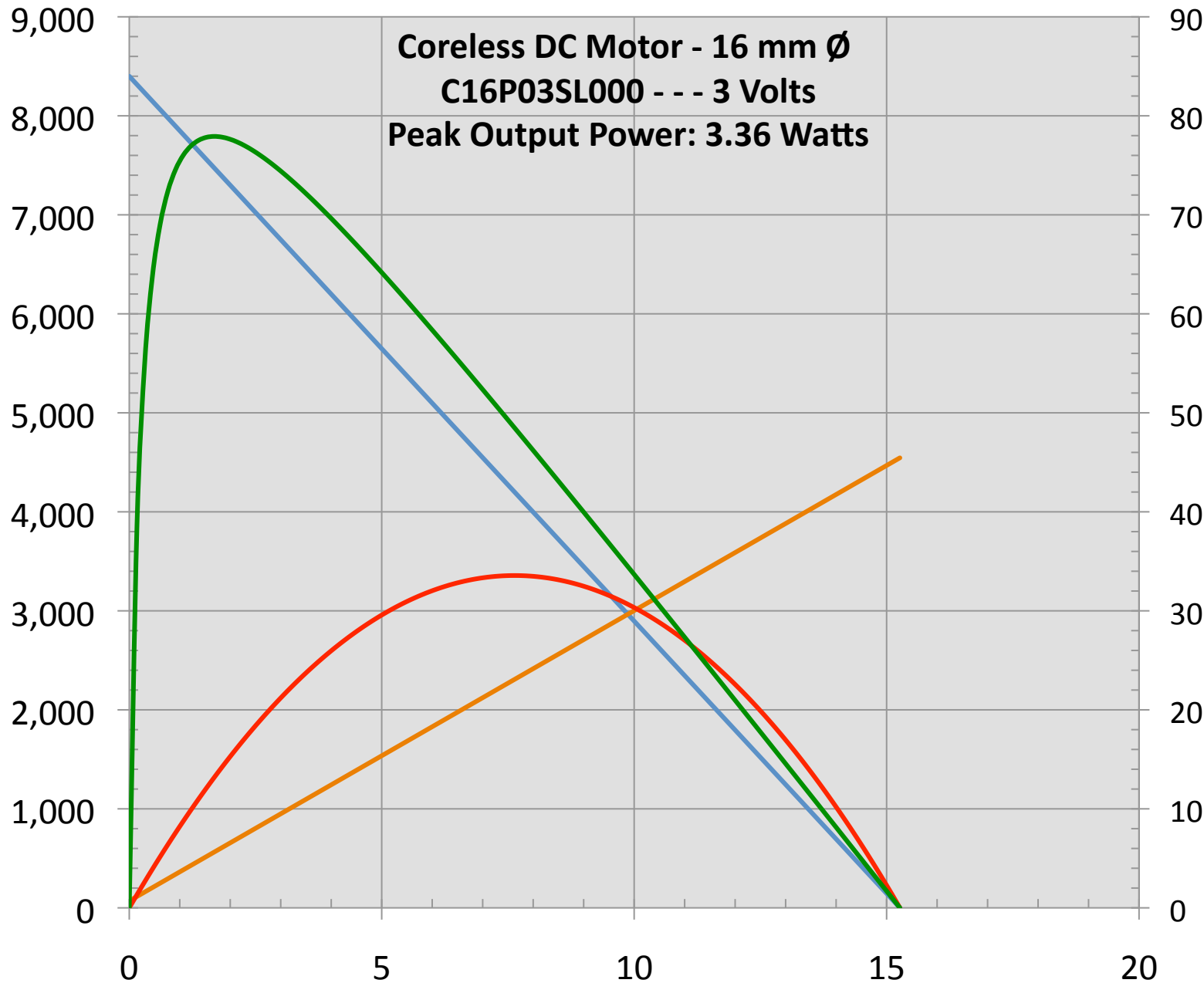

90
80
70
60
50
40
30
20
10
0

— A - Speed - rpm
 — A - Current - Amps / 10
 — A - Power Out - Watts / 10
 — A - Efficiency - %

Torque - mNm

Global Motion Products
 Distributed by Precision Motion Distributors
 (760) 451-2723, (925) 803-9565
<http://www.gmpwebsite.com>
 Email: info@gmpwebsite.com

This Graph is provided free of charge and without any representations or warranties, express or implied, as to its suitability, legal effect, completeness, currentness, accuracy, and/or appropriateness. The simulation is with Nominal Values. The Graph is provided "as is", "as available", and with "all faults" and we disclaim any warranties, including but not limited to the motor or gearmotor's warranties of merchantability and fitness for a particular purpose. This Graph may be inappropriate for your particular circumstances. This is a simple mathematical simulation of a speed/torque curve for information purposes only. **IT IS NOT TEST DATA.**

January 18, 2011

CAUTION: Peak Output Power is NOT a RATING. This is merely a calculated value and does not address Thermal Issues.

Coreless DC Motor - 16 mm Ø

C16P05SL000

4.2 Watts Peak Power



Global Motion Products

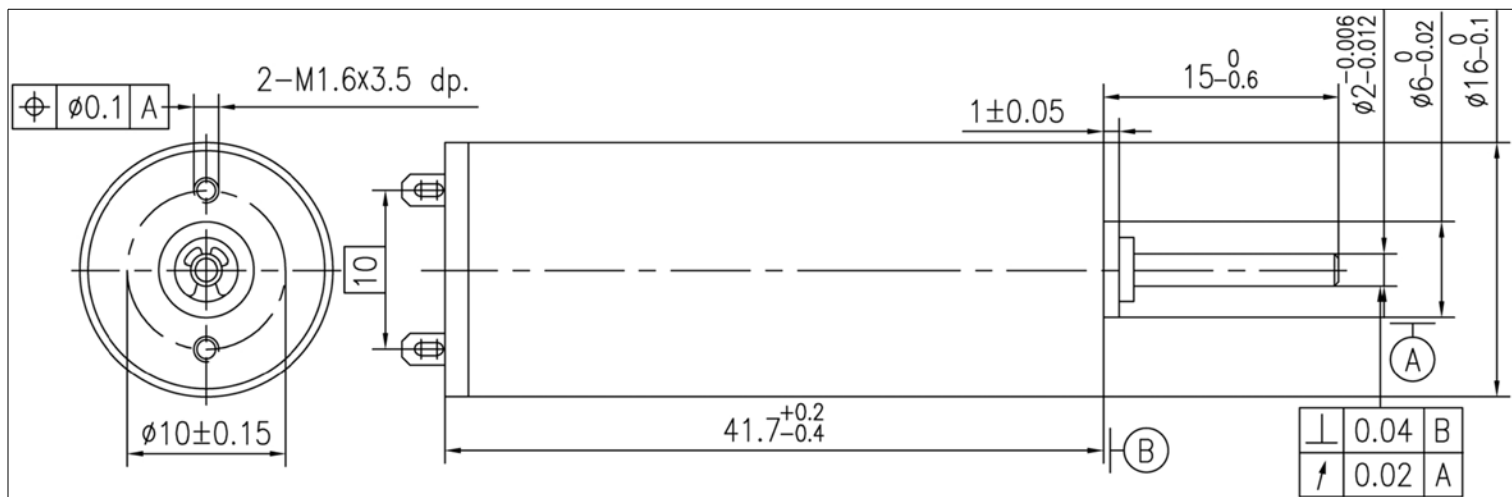

Not to Scale - Dimensions in millimeters (mm)

Nominal Voltage	4.5 Volts	4.5 Volts	4.5 Volts
No-Load Speed	8,450 rpm	8,450 rpm	8,450 rpm
Stall Torque	19.3 mNm	196.6 gcm	2.7 oz-in
No-Load Current	0.056 Amps	0.056 Amps	0.056 Amps
Peak Output Power	4.2 Watts	4.2 Watts	4.2 Watts
Torque Constant	5.01 mNm/A	51.10 gcm/A	0.71 oz-in/A
Terminal Resistance	1.17 Ohms	1.17 Ohms	1.17 Ohms
Back-EMF Constant	0.52 V/krpm	0.52 V/krpm	0.52 V/krpm
Mechanical Time Constant	7.9 msec	7.9 msec	7.9 msec
Rotor Inertia	1.69 kgm ² x10 ⁻⁷	1.69 gm cm ²	0.24 x10 ⁻⁴ oz-in-sec ²
Mechanical Time Constant	7.9 msec	7.9 msec	7.9 msec
Slope of Speed/Torque Curve	438.4 rpm/mNm	43.0 rpm/gcm	3,095.6 rpm/oz-in
Speed Constant	1,905 rpm/Volt	77 %	77 %
Motor Constant	4.63 mNm/√Watt	47.25 gcm/√Watt	0.66 oz-in/√Watt
Commutation Type	Precious Metal	Precious Metal	Precious Metal
Rated Power @ 7,439 rpm	1.8 Watts	1.8 Watts	1.8 Watts
Rated Torque @ 7,439 rpm	2.3 mNm	23.6 gcm	0.3 oz-in
Rated Current @ 7,439 rpm	0.460 Amps	0.460 Amps	0.460 Amps

Part Number: How to Order C16P05SL000

Ratings are at 25°C Ambient Temperature.

Radial Load Rating	1.4 N	Radial Play	0.020 mm	Max Temperature	65 °C
Radial Load Distance	4 mm	Thrust Play	0.150 mm	Min Temperature	-20 °C
Axial Load	0.80 N	Magnet Type	NdFeB	Max Winding Temp	85 °C
Press Fit Force - Max	15.00 N	Bearing Type	Sleeve Bearings	Mass	35 grams
Gearbox Options	P16 Planetary Gearbox				
Encoder Options	N/A				
Options - Other	Ball Bearings. Shaft length. Lubricants. Leads. Solder Tabs. Connectors.				

Global Motion Products

Distributed by:

Precision Motion Distributors: (925) 803-9565

Technical Support: (760) 451-2723

http://www.gmpwebsite.com Email: info@gmpwebsite.com

Commutation Type:

Precious Metal

Manufactured under a
Certified ISO 9001:2008
Quality System

RoHS Compliant

B - August 2011

Specifications Subject to change without notice

Coreless DC Motor - 16 mm Ø
C16P05SL000 - - - 4.5 Volts
Peak Output Power: 4.26 Watts

C16P05SL000
Voltage: 4.5 Volts
 No Load Speed: 8450 rpm
 No Load Current: 0.0558 Amps
 Terminal Resistance: 1.17 Ohms
 Stall Torque: 19.28 mNm
 Torque Constant: 5.01 mNm/A
 Peak Output Power: 4.26 Watts
 Peak Efficiency: 78.5%
 Stall Current: 3.85 Amps

Speed - rpm

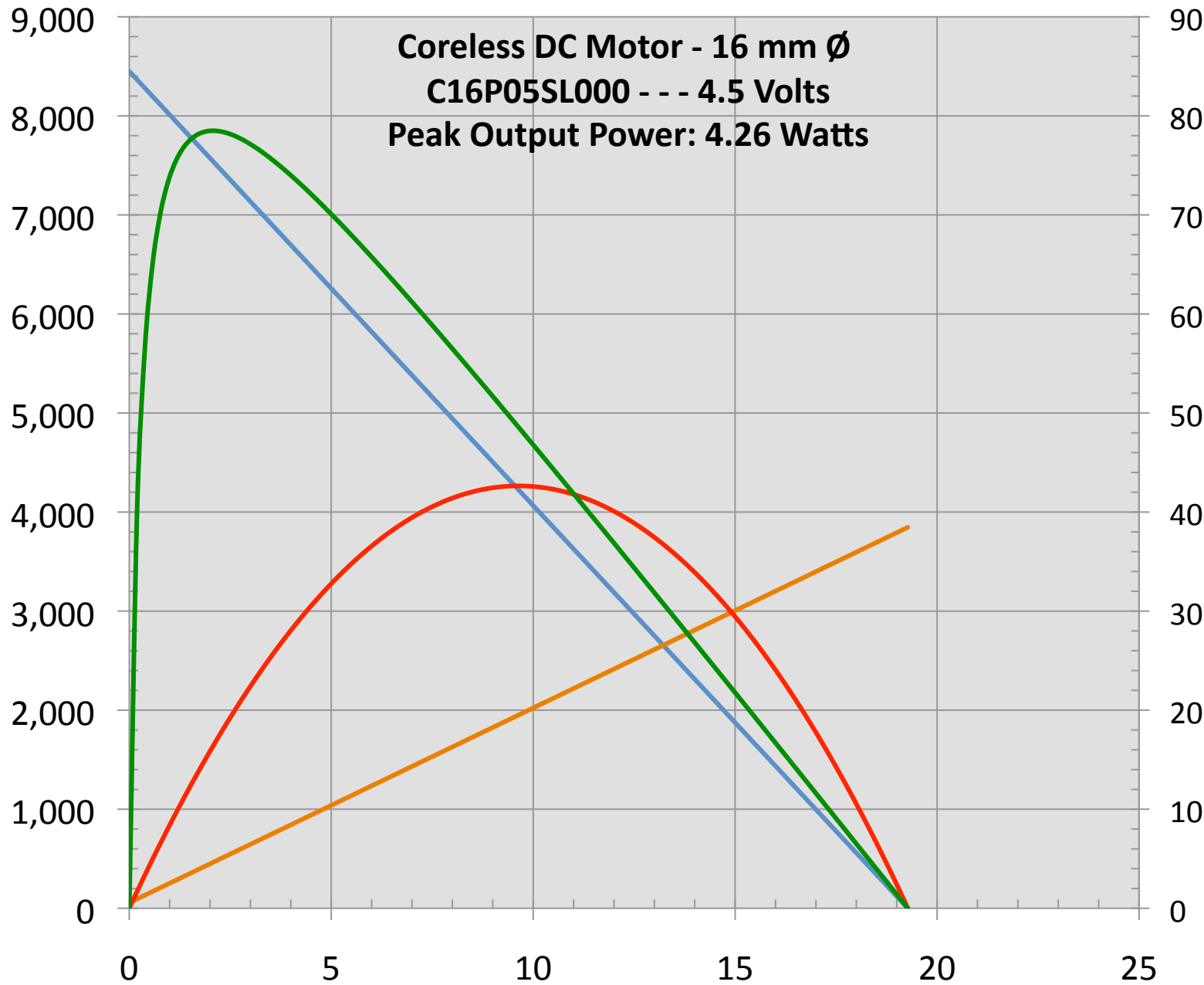

90
80
70
60
50
40
30
20
10
0

— A - Speed - rpm
 — A - Current - Amps / 10
 — A - Power Out - Watts / 10
 — A - Efficiency - %

Torque - mNm

Global Motion Products
 Distributed by Precision Motion Distributors
 (760) 451-2723, (925) 803-9565
<http://www.gmpwebsite.com>
 Email: info@gmpwebsite.com

This Graph is provided free of charge and without any representations or warranties, express or implied, as to its suitability, legal effect, completeness, currentness, accuracy, and/or appropriateness. The simulation is with Nominal Values. The Graph is provided "as is", "as available", and with "all faults" and we disclaim any warranties, including but not limited to the motor or gearmotor's warranties of merchantability and fitness for a particular purpose. This Graph may be inappropriate for your particular circumstances. This is a simple mathematical simulation of a speed/torque curve for information purposes only. **IT IS NOT TEST DATA.**

January 18, 2011

CAUTION: Peak Output Power is NOT a RATING. This is merely a calculated value and does not address Thermal Issues.

Coreless DC Motor - 16 mm Ø

C16P06SL000

3.6 Watts Peak Power



Global Motion Products

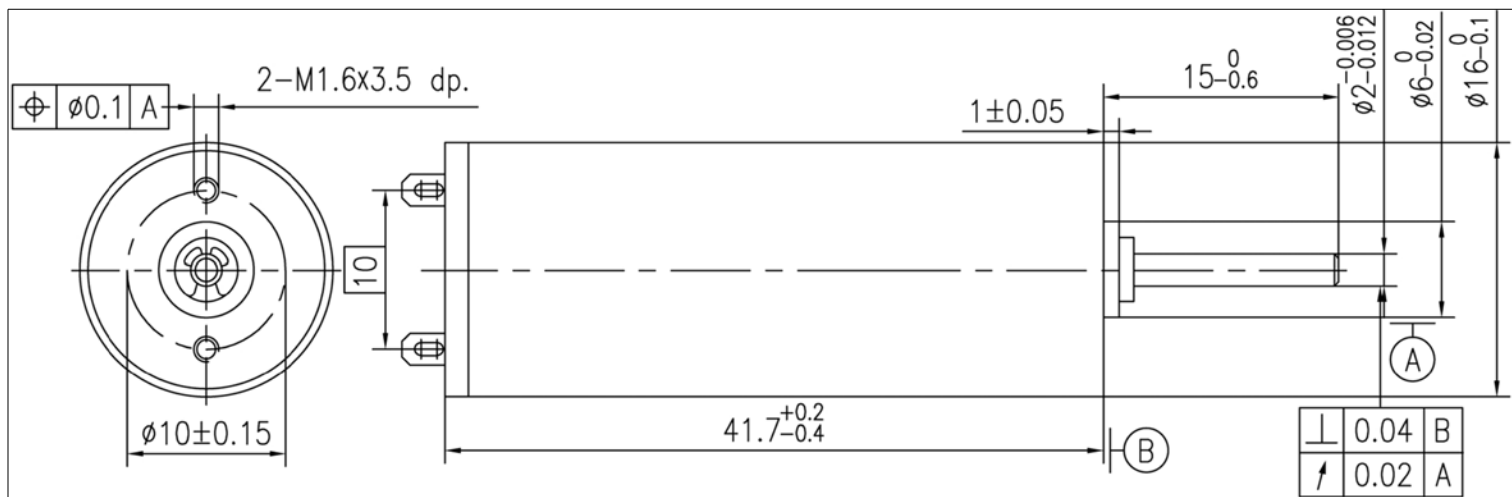

Not to Scale - Dimensions in millimeters (mm)

Nominal Voltage	6.0 Volts	6.0 Volts	6.0 Volts
No-Load Speed	8,700 rpm	8,700 rpm	8,700 rpm
Stall Torque	15.9 mNm	162.0 gcm	2.2 oz-in
No-Load Current	0.037 Amps	0.037 Amps	0.037 Amps
Peak Output Power	3.6 Watts	3.6 Watts	3.6 Watts
Torque Constant	6.49 mNm/A	66.15 gcm/A	0.92 oz-in/A
Terminal Resistance	2.45 Ohms	2.45 Ohms	2.45 Ohms
Back-EMF Constant	0.68 V/krpm	0.68 V/krpm	0.68 V/krpm
Mechanical Time Constant	8.0 msec	8.0 msec	8.0 msec
Rotor Inertia	1.37 kgm ² x10 ⁻⁷	1.37 gm cm ²	0.19 x10 ⁻⁴ oz-in-sec ²
Mechanical Time Constant	8.0 msec	8.0 msec	8.0 msec
Slope of Speed/Torque Curve	547.6 rpm/mNm	53.7 rpm/gcm	3,867.1 rpm/oz-in
Speed Constant	1,472 rpm/Volt	77 %	77 %
Motor Constant	4.14 mNm/√Watt	42.26 gcm/√Watt	0.59 oz-in/√Watt
Commutation Type	Precious Metal	Precious Metal	Precious Metal
Rated Power @ 7,346 rpm	1.9 Watts	1.9 Watts	1.9 Watts
Rated Torque @ 7,346 rpm	2.5 mNm	25.2 gcm	0.3 oz-in
Rated Current @ 7,346 rpm	0.381 Amps	0.381 Amps	0.381 Amps

Part Number: How to Order C16P06SL000

Ratings are at 25°C Ambient Temperature.

Radial Load Rating	1.4 N	Radial Play	0.020 mm	Max Temperature	65 °C
Radial Load Distance	4 mm	Thrust Play	0.150 mm	Min Temperature	-20 °C
Axial Load	0.80 N	Magnet Type	NdFeB	Max Winding Temp	85 °C
Press Fit Force - Max	15.00 N	Bearing Type	Sleeve Bearings	Mass	35 grams
Gearbox Options	P16 Planetary Gearbox				
Encoder Options	N/A				
Options - Other	Ball Bearings. Shaft length. Lubricants. Leads. Solder Tabs. Connectors.				

Global Motion Products

Distributed by:

Precision Motion Distributors: (925) 803-9565

Technical Support: (760) 451-2723

http://www.gmpwebsite.com Email: info@gmpwebsite.com

Commutation Type:

Precious Metal

Manufactured under a
Certified ISO 9001:2008
Quality System

RoHS Compliant

B - August 2011

Specifications Subject to change without notice

Coreless DC Motor - 16 mm Ø
C16P06SL000 - - - 6 Volts
Peak Output Power: 3.62 Watts

C16P06SL000
Voltage: 6 Volts
 No Load Speed: 8700 rpm
 No Load Current: 0.0367 Amps
 Terminal Resistance: 2.45 Ohms
 Stall Torque: 15.89 mNm
 Torque Constant: 6.49 mNm/A
 Peak Output Power: 3.62 Watts
 Peak Efficiency: 78.2%
 Stall Current: 2.45 Amps

Speed - rpm

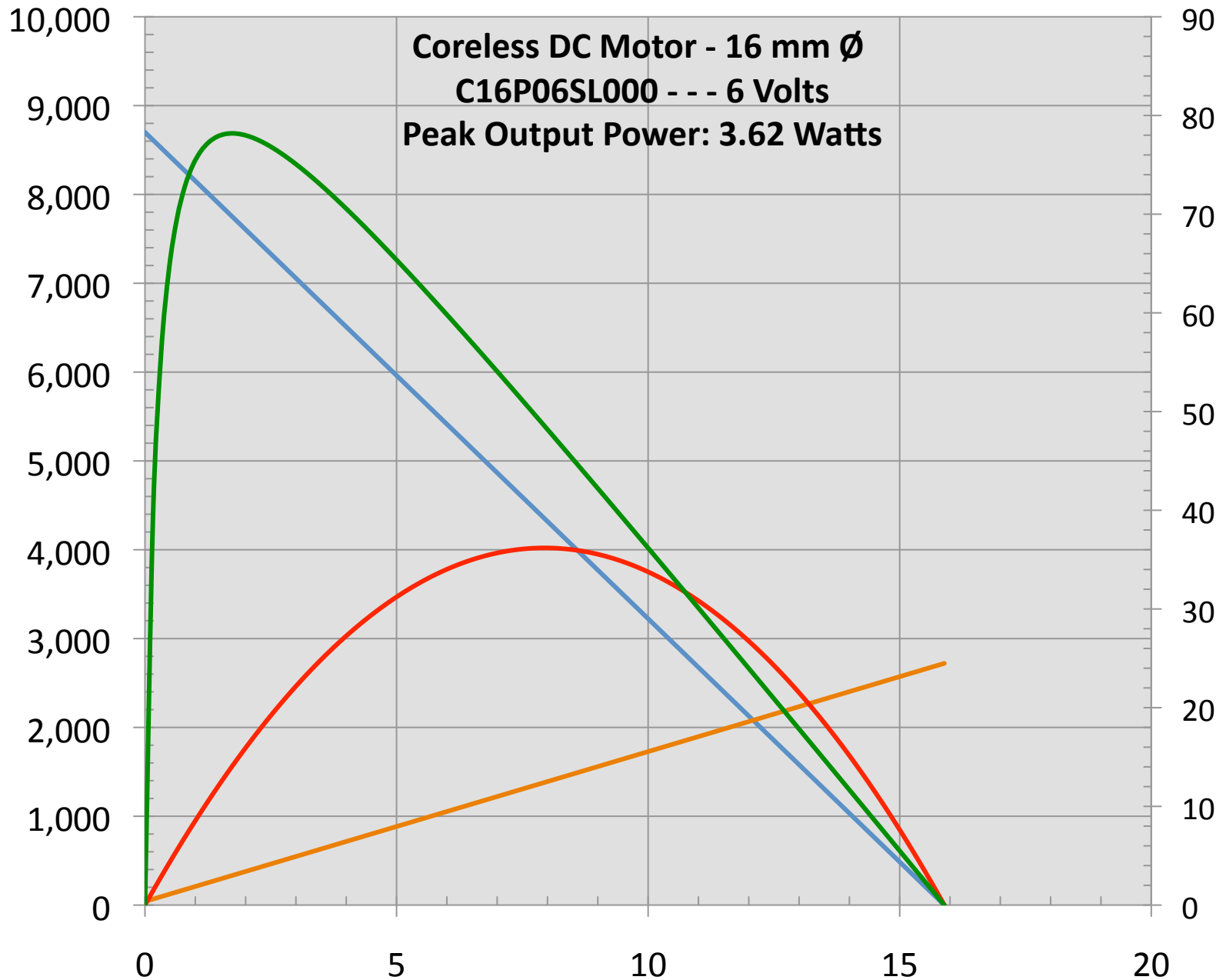

90
80
70
60
50
40
30
20
10
0

— A - Speed - rpm
 — A - Current - Amps / 10
 — A - Power Out - Watts / 10
 — A - Efficiency - %

Torque - mNm

Global Motion Products
 Distributed by Precision Motion Distributors
 (760) 451-2723, (925) 803-9565
<http://www.gmpwebsite.com>
 Email: info@gmpwebsite.com

This Graph is provided free of charge and without any representations or warranties, express or implied, as to its suitability, legal effect, completeness, currentness, accuracy, and/or appropriateness. The simulation is with Nominal Values. The Graph is provided "as is", "as available", and with "all faults" and we disclaim any warranties, including but not limited to the motor or gearmotor's warranties of merchantability and fitness for a particular purpose. This Graph may be inappropriate for your particular circumstances. This is a simple mathematical simulation of a speed/torque curve for information purposes only. **IT IS NOT TEST DATA.**

January 18, 2011

CAUTION: Peak Output Power is NOT a RATING. This is merely a calculated value and does not address Thermal Issues.

Coreless DC Motor - 16 mm Ø

C16P09SL000

3.2 Watts Peak Power



Global Motion Products

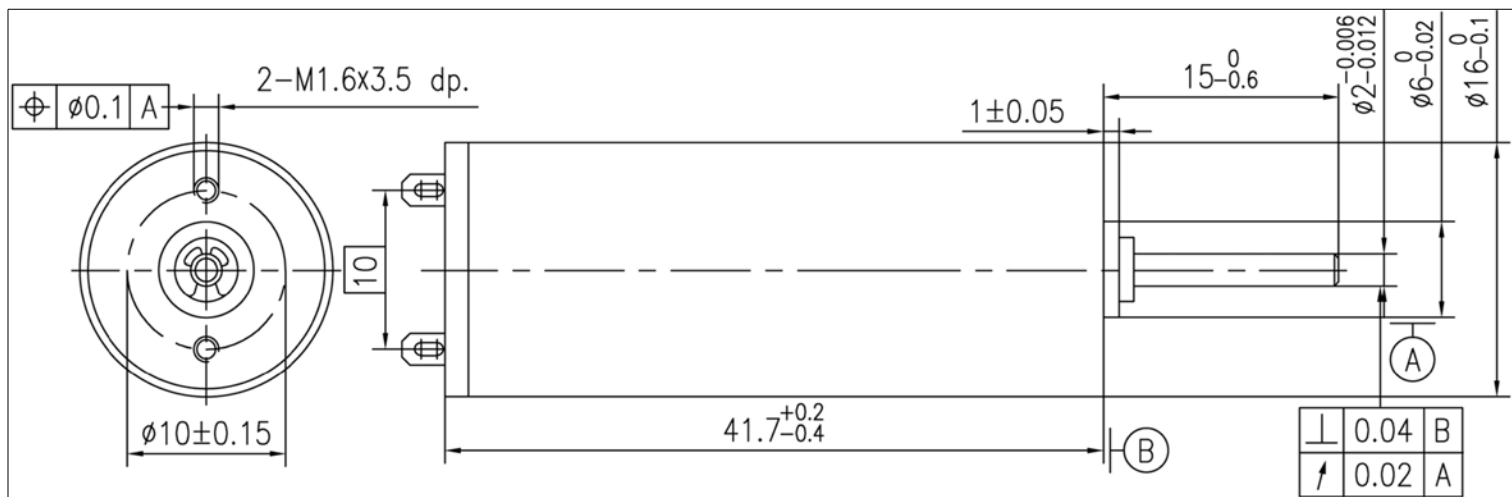

Not to Scale - Dimensions in millimeters (mm)

Nominal Voltage	9.0 Volts	9.0 Volts	9.0 Volts
No-Load Speed	8,580 rpm	8,580 rpm	8,580 rpm
Stall Torque	14.6 mNm	148.4 gcm	2.1 oz-in
No-Load Current	0.023 Amps	0.023 Amps	0.023 Amps
Peak Output Power	3.2 Watts	3.2 Watts	3.2 Watts
Torque Constant	9.86 mNm/A	100.56 gcm/A	1.40 oz-in/A
Terminal Resistance	6.10 Ohms	6.10 Ohms	6.10 Ohms
Back-EMF Constant	1.03 V/krpm	1.03 V/krpm	1.03 V/krpm
Mechanical Time Constant	6.8 msec	6.8 msec	6.8 msec
Rotor Inertia	1.08 kgm ² x10 ⁻⁷	1.08 gm cm ²	0.15 x10 ⁻⁴ oz-in-sec ²
Mechanical Time Constant	6.8 msec	6.8 msec	6.8 msec
Slope of Speed/Torque Curve	589.7 rpm/mNm	57.8 rpm/gcm	4,164.0 rpm/oz-in
Speed Constant	968 rpm/Volt	77 %	77 %
Motor Constant	3.99 mNm/√Watt	40.72 gcm/√Watt	0.57 oz-in/√Watt
Commutation Type	Precious Metal	Precious Metal	Precious Metal
Rated Power @ 7,068 rpm	1.9 Watts	1.9 Watts	1.9 Watts
Rated Torque @ 7,068 rpm	2.6 mNm	26.2 gcm	0.4 oz-in
Rated Current @ 7,068 rpm	0.260 Amps	0.260 Amps	0.260 Amps

Part Number: How to Order C16P09SL000

Ratings are at 25°C Ambient Temperature.

Radial Load Rating	1.4 N	Radial Play	0.020 mm	Max Temperature	65 °C
Radial Load Distance	4 mm	Thrust Play	0.150 mm	Min Temperature	-20 °C
Axial Load	0.80 N	Magnet Type	NdFeB	Max Winding Temp	85 °C
Press Fit Force - Max	15.00 N	Bearing Type	Sleeve Bearings	Mass	35 grams
Gearbox Options	P16 Planetary Gearbox				
Encoder Options	N/A				
Options - Other	Ball Bearings. Shaft length. Lubricants. Leads. Solder Tabs. Connectors.				

Global Motion Products

Distributed by:

Precision Motion Distributors: (925) 803-9565

Technical Support: (760) 451-2723

http://www.gmpwebsite.com Email: info@gmpwebsite.com

Commutation Type:

Precious Metal

Manufactured under a
Certified ISO 9001:2008
Quality System

RoHS Compliant

B - August 2011

Specifications Subject to change without notice

Coreless DC Motor - 16 mm Ø
C16P09SL000 - - - 9 Volts
Peak Output Power: 3.27 Watts

C16P09SL000
Voltage: 9 Volts
 No Load Speed: 8580 rpm
 No Load Current: 0.0228 Amps
 Terminal Resistance: 6.1 Ohms
 Stall Torque: 14.55 mNm
 Torque Constant: 9.86 mNm/A
 Peak Output Power: 3.27 Watts
 Peak Efficiency: 77.9%
 Stall Current: 1.48 Amps

Speed - rpm

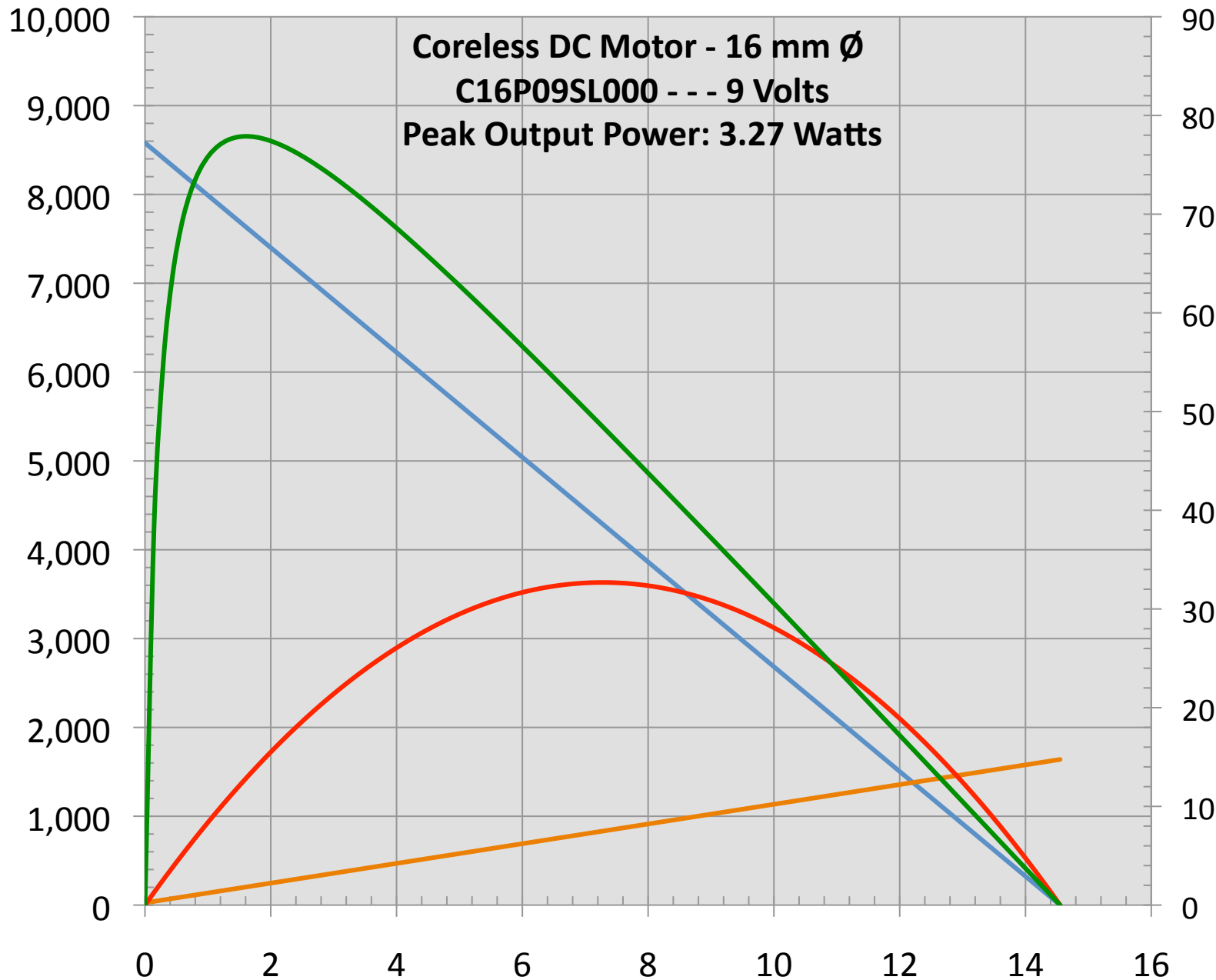

— A - Speed - rpm
 — A - Current - Amps / 10
 — A - Power Out - Watts / 10
 — A - Efficiency - %

Global Motion Products
 Distributed by Precision Motion Distributors
 (760) 451-2723, (925) 803-9565
<http://www.gmpwebsite.com>
 Email: info@gmpwebsite.com

This Graph is provided free of charge and without any representations or warranties, express or implied, as to its suitability, legal effect, completeness, currentness, accuracy, and/or appropriateness. The simulation is with Nominal Values. The Graph is provided "as is", "as available", and with "all faults" and we disclaim any warranties, including but not limited to the motor or gearmotor's warranties of merchantability and fitness for a particular purpose. This Graph may be inappropriate for your particular circumstances. This is a simple mathematical simulation of a speed/torque curve for information purposes only. **IT IS NOT TEST DATA.**

January 18, 2011

CAUTION: Peak Output Power is NOT a RATING. This is merely a calculated value and does not address Thermal Issues.

Coreless DC Motor - 16 mm Ø

C16P12SL000

2.6 Watts Peak Power



Global Motion Products

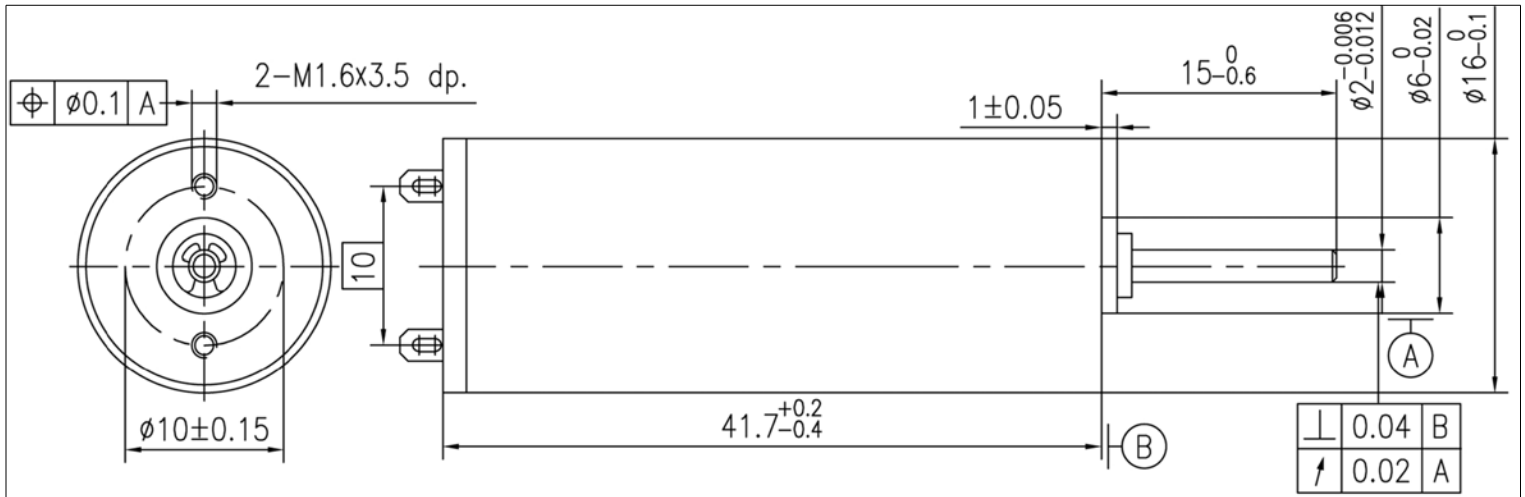

Not to Scale - Dimensions in millimeters (mm)

Nominal Voltage	12.0 Volts	12.0 Volts	12.0 Volts
No-Load Speed	8,570 rpm	8,570 rpm	8,570 rpm
Stall Torque	11.8 mNm	120.3 gcm	1.7 oz-in
No-Load Current	0.013 Amps	0.013 Amps	0.013 Amps
Peak Output Power	2.6 Watts	2.6 Watts	2.6 Watts
Torque Constant	13.17 mNm/A	134.31 gcm/A	1.87 oz-in/A
Terminal Resistance	13.40 Ohms	13.40 Ohms	13.40 Ohms
Back-EMF Constant	1.38 V/krpm	1.38 V/krpm	1.38 V/krpm
Mechanical Time Constant	6.8 msec	6.8 msec	6.8 msec
Rotor Inertia	0.88 kgm ² x10 ⁻⁷	0.88 gm cm ²	0.12 x10 ⁻⁴ oz-in-sec ²
Mechanical Time Constant	6.8 msec	6.8 msec	6.8 msec
Slope of Speed/Torque Curve	726.6 rpm/mNm	71.3 rpm/gcm	5,130.7 rpm/oz-in
Speed Constant	725 rpm/Volt	77 %	77 %
Motor Constant	3.60 mNm/√Watt	36.69 gcm/√Watt	0.51 oz-in/√Watt
Commutation Type	Precious Metal	Precious Metal	Precious Metal
Rated Power @ 7,087 rpm	1.5 Watts	1.5 Watts	1.5 Watts
Rated Torque @ 7,087 rpm	2.0 mNm	20.8 gcm	0.3 oz-in
Rated Current @ 7,087 rpm	0.155 Amps	0.155 Amps	0.155 Amps

Part Number: How to Order C16P12SL000

Ratings are at 25°C Ambient Temperature.

Radial Load Rating	1.4 N	Radial Play	0.020 mm	Max Temperature	65 °C
Radial Load Distance	4 mm	Thrust Play	0.150 mm	Min Temperature	-20 °C
Axial Load	0.80 N	Magnet Type	NdFeB	Max Winding Temp	85 °C
Press Fit Force - Max	15.00 N	Bearing Type	Sleeve Bearings	Mass	35 grams
Gearbox Options	P16 Planetary Gearbox				
Encoder Options	N/A				
Options - Other	Ball Bearings. Shaft length. Lubricants. Leads. Solder Tabs. Connectors.				

Global Motion Products

Distributed by:

Precision Motion Distributors: (925) 803-9565

Technical Support: (760) 451-2723

http://www.gmpwebsite.com Email: info@gmpwebsite.com

Commutation Type:

Precious Metal

Manufactured under a
Certified ISO 9001:2008
Quality System

RoHS Compliant

B - August 2011

Specifications Subject to change without notice

Coreless DC Motor - 16 mm Ø
C16P12SL000 - - - 12 Volts
Peak Output Power: 2.65 Watts

100 C16P12SL000
Voltage: 12 Volts
 No Load Speed: 8570 rpm
 No Load Current: 0.0134 Amps
 Terminal Resistance: 13.4 Ohms
 Stall Torque: 11.8 mNm
 Torque Constant: 13.17 mNm/A
 Peak Output Power: 2.65 Watts
 Peak Efficiency: 78.2%
 Stall Current: 0.9 Amps

Speed - rpm

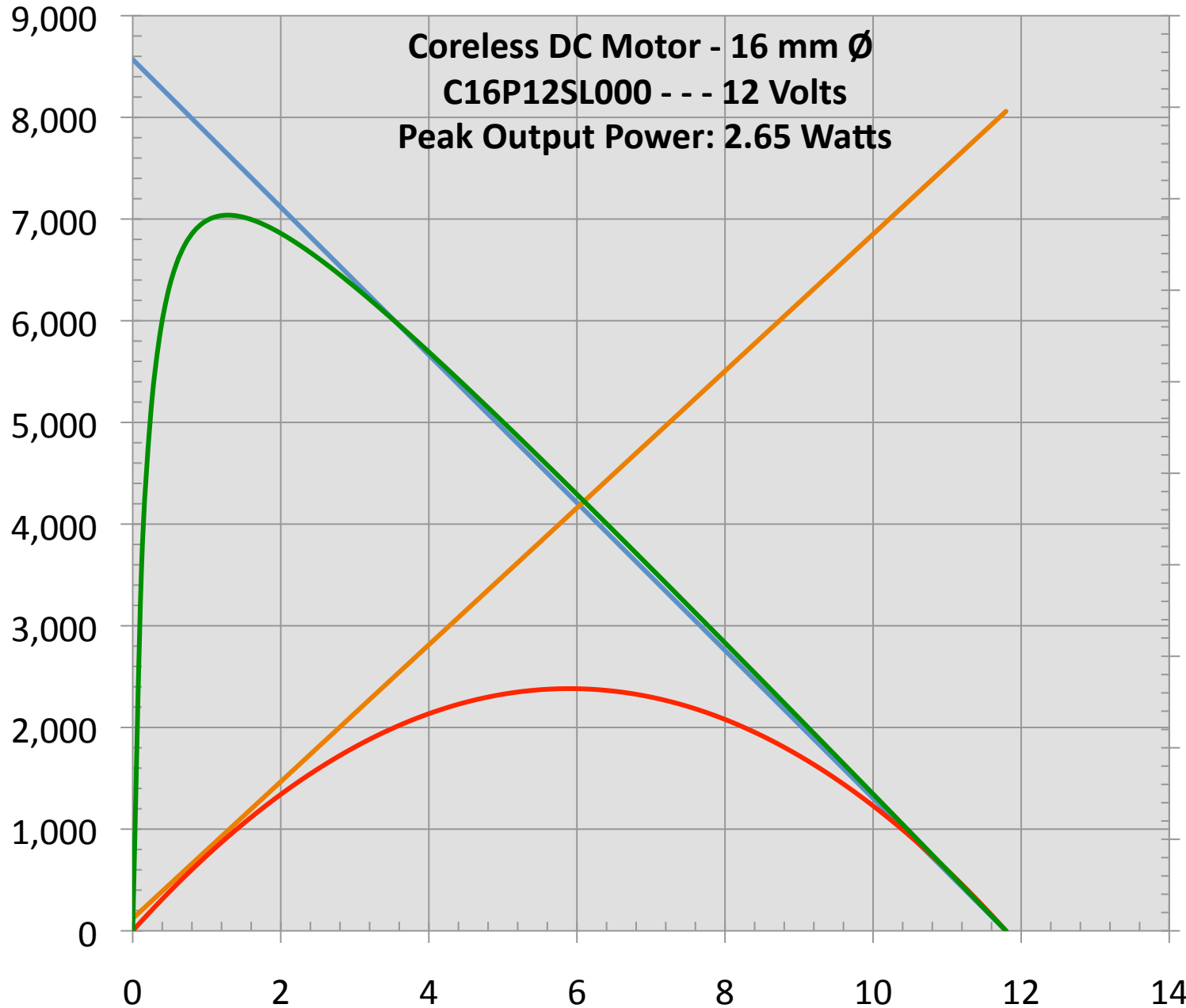

- A - Speed - rpm
- A - Current - Amps / 100
- A - Power Out - Watts / 10
- A - Efficiency - %

Torque - mNm

Global Motion Products
 Distributed by Precision Motion Distributors
 (760) 451-2723, (925) 803-9565
<http://www.gmpwebsite.com>
 Email: info@gmpwebsite.com

This Graph is provided free of charge and without any representations or warranties, express or implied, as to its suitability, legal effect, completeness, currentness, accuracy, and/or appropriateness. The simulation is with Nominal Values. The Graph is provided "as is", "as available", and with "all faults" and we disclaim any warranties, including but not limited to the motor or gearmotor's warranties of merchantability and fitness for a particular purpose. This Graph may be inappropriate for your particular circumstances. This is a simple mathematical simulation of a speed/torque curve for information purposes only. **IT IS NOT TEST DATA.**

January 18, 2011

CAUTION: Peak Output Power is NOT a RATING. This is merely a calculated value and does not address Thermal Issues.

Coreless DC Motor - 16 mm Ø

C16P18SL000

3.9 Watts Peak Power



Global Motion Products

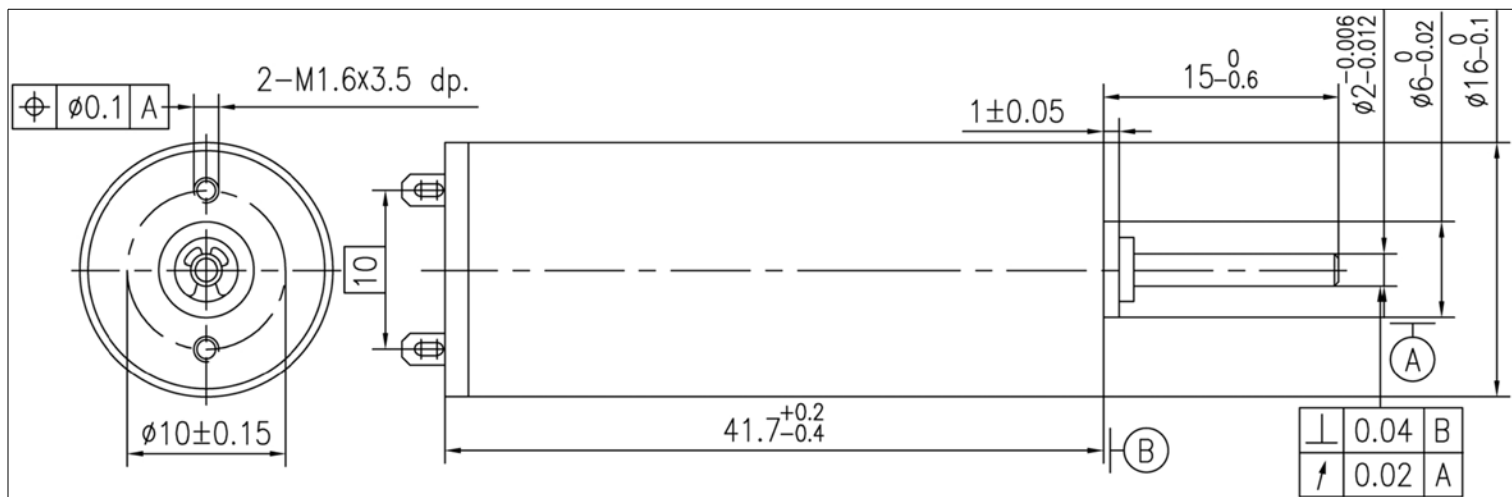

Not to Scale - Dimensions in millimeters (mm)

Nominal Voltage	18.0 Volts	18.0 Volts	18.0 Volts
No-Load Speed	8,530 rpm	8,530 rpm	8,530 rpm
Stall Torque	17.7 mNm	180.6 gcm	2.5 oz-in
No-Load Current	0.012 Amps	0.012 Amps	0.012 Amps
Peak Output Power	3.9 Watts	3.9 Watts	3.9 Watts
Torque Constant	19.88 mNm/A	202.69 gcm/A	2.81 oz-in/A
Terminal Resistance	20.20 Ohms	20.20 Ohms	20.20 Ohms
Back-EMF Constant	2.08 V/krpm	2.08 V/krpm	2.08 V/krpm
Mechanical Time Constant	6.9 msec	6.9 msec	6.9 msec
Rotor Inertia	1.35 kgm ² x10 ⁻⁷	1.35 gm cm ²	0.19 x10 ⁻⁴ oz-in-sec ²
Mechanical Time Constant	6.9 msec	6.9 msec	6.9 msec
Slope of Speed/Torque Curve	481.6 rpm/mNm	47.2 rpm/gcm	3,400.7 rpm/oz-in
Speed Constant	480 rpm/Volt	78 %	78 %
Motor Constant	4.42 mNm/√Watt	45.10 gcm/√Watt	0.63 oz-in/√Watt
Commutation Type	Precious Metal	Precious Metal	Precious Metal
Rated Power @ 6,826 rpm	2.5 Watts	2.5 Watts	2.5 Watts
Rated Torque @ 6,826 rpm	3.5 mNm	36.1 gcm	0.5 oz-in
Rated Current @ 6,826 rpm	0.178 Amps	0.178 Amps	0.178 Amps

Part Number: How to Order C16P18SL000

Ratings are at 25°C Ambient Temperature.

Radial Load Rating	1.4 N	Radial Play	0.020 mm	Max Temperature	65 °C
Radial Load Distance	4 mm	Thrust Play	0.150 mm	Min Temperature	-20 °C
Axial Load	0.80 N	Magnet Type	NdFeB	Max Winding Temp	85 °C
Press Fit Force - Max	15.00 N	Bearing Type	Sleeve Bearings	Mass	35 grams
Gearbox Options	P16 Planetary Gearbox				
Encoder Options	N/A				
Options - Other	Ball Bearings. Shaft length. Lubricants. Leads. Solder Tabs. Connectors.				

Global Motion Products

Distributed by:

Precision Motion Distributors: (925) 803-9565

Technical Support: (760) 451-2723

http://www.gmpwebsite.com Email: info@gmpwebsite.com

Commutation Type:

Precious Metal

Manufactured under a
Certified ISO 9001:2008
Quality System

RoHS Compliant

B - August 2011

Specifications Subject to change without notice

Coreless DC Motor - 16 mm Ø
C16P18SL000 - - - 18 Volts
Peak Output Power: 3.96 Watts

100 C16P18SL000
Voltage: 18 Volts
 No Load Speed: 8530 rpm
 No Load Current: 0.0121 Amps
 Terminal Resistance: 20.2 Ohms
 Stall Torque: 17.71 mNm
 Torque Constant: 19.88 mNm/A
 Peak Output Power: 3.96 Watts
 Peak Efficiency: 79.1%
 Stall Current: 0.89 Amps

Speed - rpm

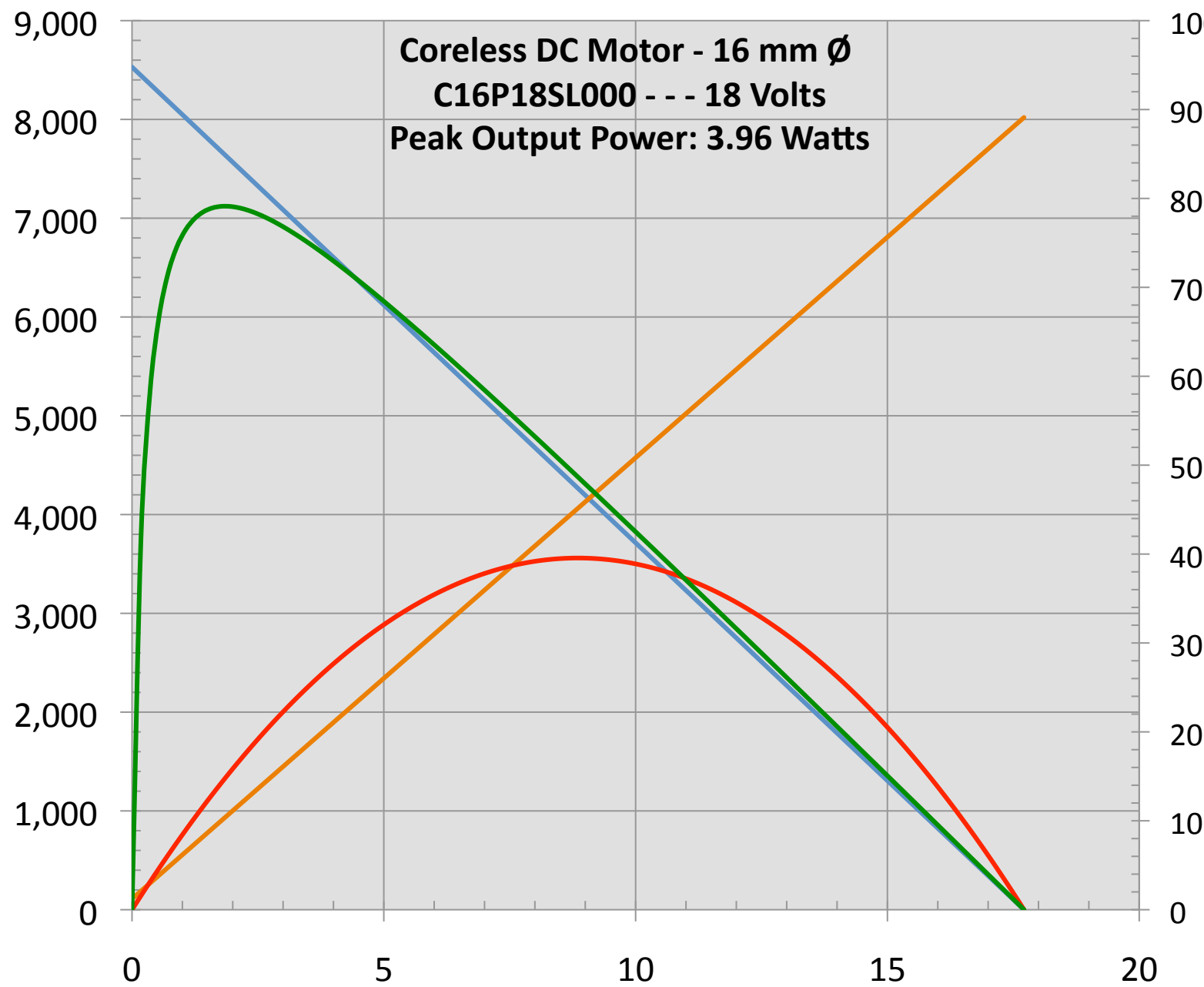

— A - Speed - rpm
 — A - Current - Amps / 100
 — A - Power Out - Watts / 10
 — A - Efficiency - %

Torque - mNm

Global Motion Products
 Distributed by Precision Motion Distributors
 (760) 451-2723, (925) 803-9565
<http://www.gmpwebsite.com>
 Email: info@gmpwebsite.com

This Graph is provided free of charge and without any representations or warranties, express or implied, as to its suitability, legal effect, completeness, currentness, accuracy, and/or appropriateness. The simulation is with Nominal Values. The Graph is provided "as is", "as available", and with "all faults" and we disclaim any warranties, including but not limited to the motor or gearmotor's warranties of merchantability and fitness for a particular purpose. This Graph may be inappropriate for your particular circumstances. This is a simple mathematical simulation of a speed/torque curve for information purposes only. **IT IS NOT TEST DATA.**

January 18, 2011

CAUTION: Peak Output Power is NOT a RATING. This is merely a calculated value and does not address Thermal Issues.

Coreless DC Motor - 16 mm Ø



C16P24SL000

2.7 Watts Peak Power

Global Motion Products

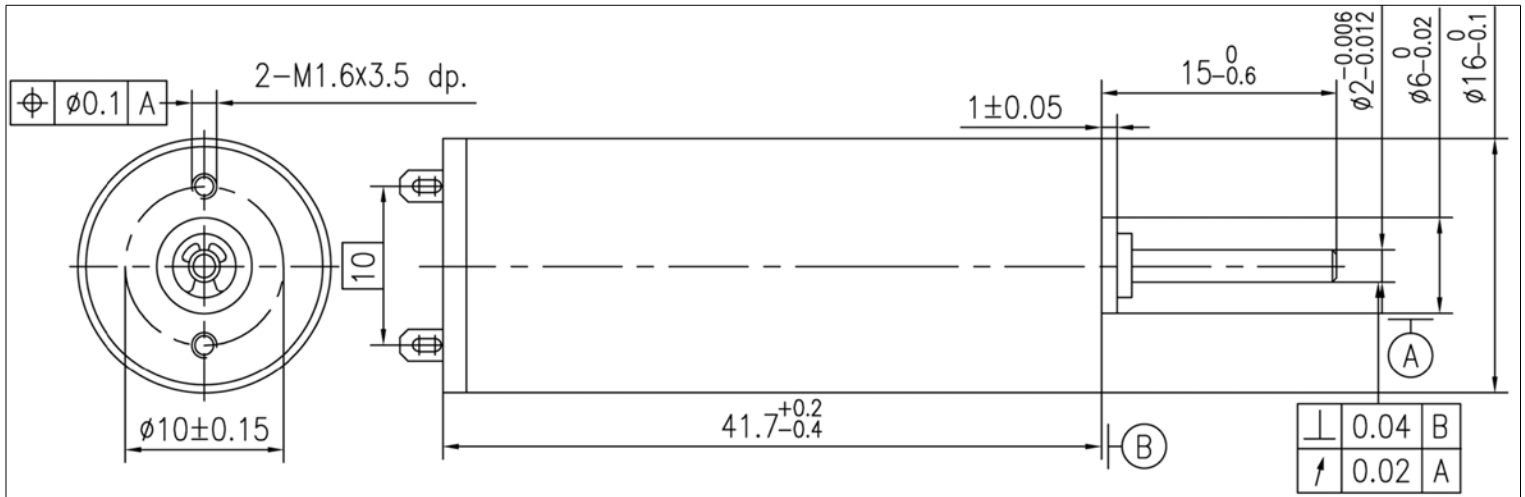

Not to Scale - Dimensions in millimeters (mm)

Nominal Voltage	24.0 Volts	24.0 Volts	24.0 Volts
No-Load Speed	8,640 rpm	8,640 rpm	8,640 rpm
Stall Torque	12.4 mNm	126.1 gcm	1.8 oz-in
No-Load Current	0.009 Amps	0.009 Amps	0.009 Amps
Peak Output Power	2.7 Watts	2.7 Watts	2.7 Watts
Torque Constant	26.03 mNm/A	265.42 gcm/A	3.69 oz-in/A
Terminal Resistance	50.50 Ohms	50.50 Ohms	50.50 Ohms
Back-EMF Constant	2.73 V/krpm	2.73 V/krpm	2.73 V/krpm
Mechanical Time Constant	7.7 msec	7.7 msec	7.7 msec
Rotor Inertia	1.03 kgm ² x10 ⁻⁷	1.03 gm cm ²	0.15 x10 ⁻⁴ oz-in-sec ²
Mechanical Time Constant	7.7 msec	7.7 msec	7.7 msec
Slope of Speed/Torque Curve	698.4 rpm/mNm	68.5 rpm/gcm	4,932.1 rpm/oz-in
Speed Constant	367 rpm/Volt	75 %	75 %
Motor Constant	3.66 mNm/√Watt	37.35 gcm/√Watt	0.52 oz-in/√Watt
Commutation Type	Precious Metal	Precious Metal	Precious Metal
Rated Power @ 6,913 rpm	1.8 Watts	1.8 Watts	1.8 Watts
Rated Torque @ 6,913 rpm	2.5 mNm	25.2 gcm	0.3 oz-in
Rated Current @ 6,913 rpm	0.095 Amps	0.095 Amps	0.095 Amps

Part Number: How to Order C16P24SL000

Ratings are at 25°C Ambient Temperature.

Radial Load Rating	1.4 N	Radial Play	0.020 mm	Max Temperature	65 °C
Radial Load Distance	4 mm	Thrust Play	0.150 mm	Min Temperature	-20 °C
Axial Load	0.80 N	Magnet Type	NdFeB	Max Winding Temp	85 °C
Press Fit Force - Max	15.00 N	Bearing Type	Sleeve Bearings	Mass	35 grams
Gearbox Options	P16 Planetary Gearbox				
Encoder Options	N/A				
Options - Other	Ball Bearings. Shaft length. Lubricants. Leads. Solder Tabs. Connectors.				

Global Motion Products

Distributed by:

Precision Motion Distributors: (925) 803-9565

Technical Support: (760) 451-2723

http://www.gmpwebsite.com Email: info@gmpwebsite.com

Commutation Type:

Precious Metal

Manufactured under a
Certified ISO 9001:2008
Quality System

RoHS Compliant

B - August 2011

Specifications Subject to change without notice

Speed - rpm

10,000
9,000
8,000
7,000
6,000
5,000
4,000
3,000
2,000
1,000
0

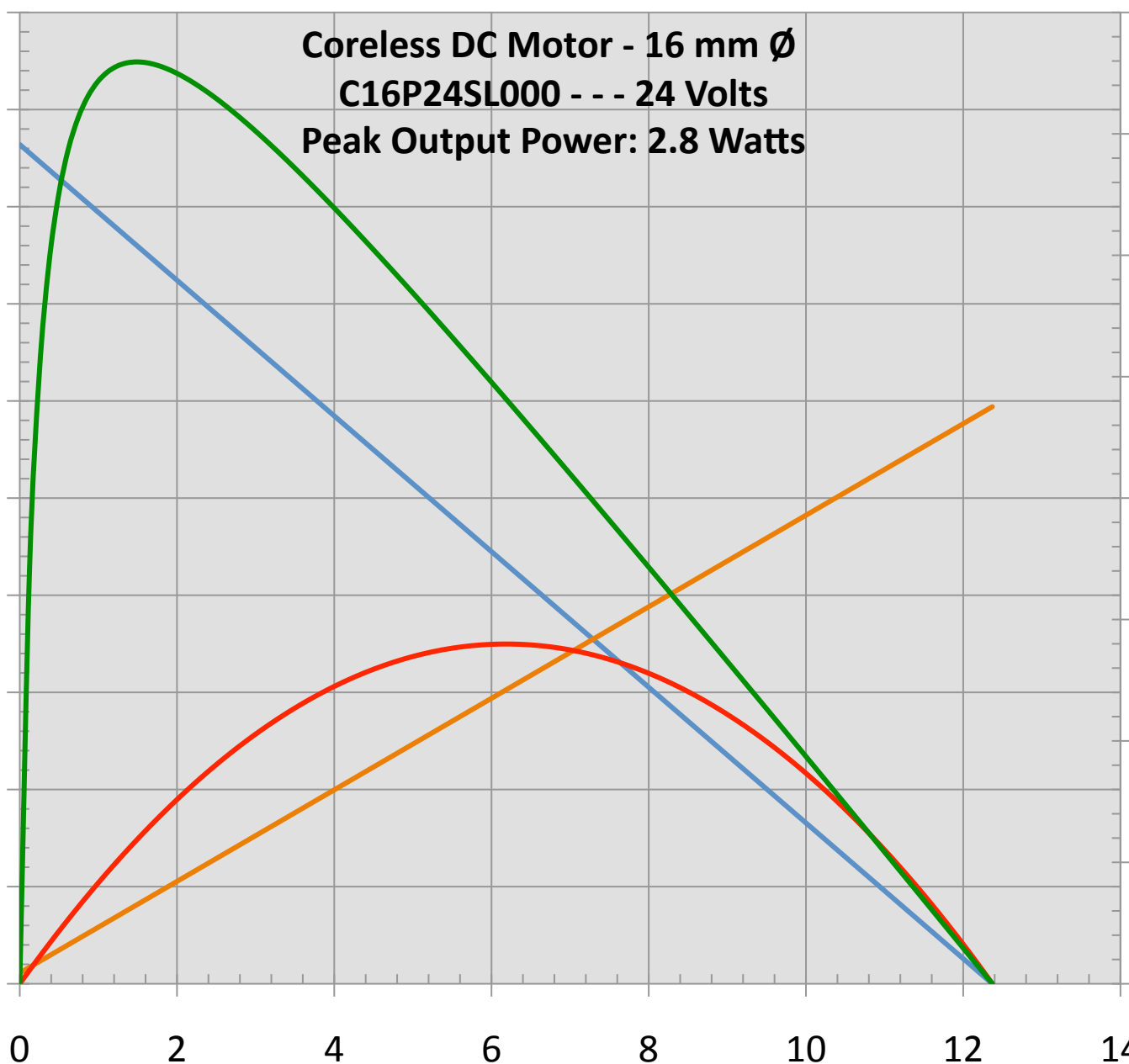

Coreless DC Motor - 16 mm Ø
C16P24SL000 - - - 24 Volts
Peak Output Power: 2.8 Watts

C16P24SL000
Voltage: 24 Volts
No Load Speed: 8640 rpm
No Load Current: 0.0089 Amps
Terminal Resistance: 50.5 Ohms
Stall Torque: 12.37 mNm
Torque Constant: 26.03 mNm/A
Peak Output Power: 2.8 Watts
Peak Efficiency: 75.9%
Stall Current: 0.48 Amps

— A - Speed - rpm
— A - Current - Amps / 100
— A - Power Out - Watts / 10
— A - Efficiency - %

Torque - mNm

Global Motion Products
Distributed by Precision Motion Distributors
(760) 451-2723, (925) 803-9565
<http://www.gmpwebsite.com>
Email: info@gmpwebsite.com

This Graph is provided free of charge and without any representations or warranties, express or implied, as to its suitability, legal effect, completeness, currentness, accuracy, and/or appropriateness. The simulation is with Nominal Values. The Graph is provided "as is", "as available", and with "all faults" and we disclaim any warranties, including but not limited to the motor or gearmotor's warranties of merchantability and fitness for a particular purpose. This Graph may be inappropriate for your particular circumstances. This is a simple mathematical simulation of a speed/torque curve for information purposes only. **IT IS NOT TEST DATA.**

January 18, 2011

CAUTION: Peak Output Power is NOT a RATING. This is merely a calculated value and does not address Thermal Issues.