

Coreless DC Motor - 20 mm Ø

C20P11SE000

9.1 Watts Peak Power



Global Motion Products

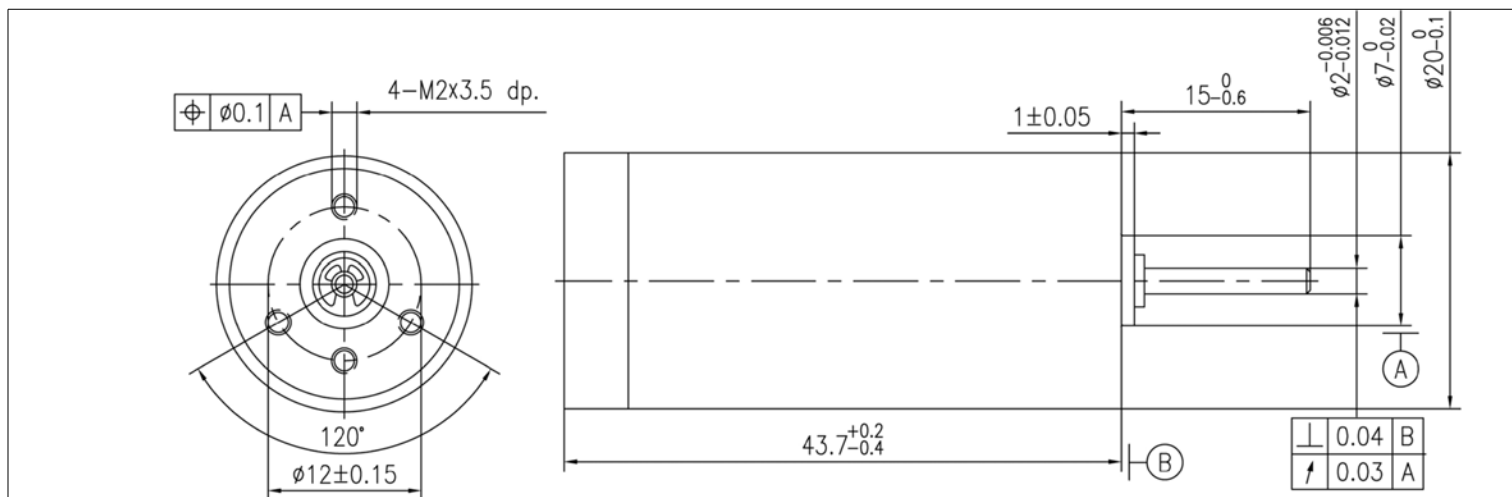

Not to Scale - Dimensions in millimeters (mm)

Nominal Voltage	9.0 Volts	9.0 Volts	9.0 Volts
No-Load Speed	8,030 rpm	8,030 rpm	8,030 rpm
Stall Torque	43.5 mNm	443.4 gcm	6.2 oz-in
No-Load Current	0.028 Amps	0.028 Amps	0.028 Amps
Peak Output Power	9.1 Watts	9.1 Watts	9.1 Watts
Torque Constant	10.63 mNm/A	108.39 gcm/A	1.51 oz-in/A
Terminal Resistance	2.20 Ohms	2.20 Ohms	2.20 Ohms
Back-EMF Constant	1.11 V/krpm	1.11 V/krpm	1.11 V/krpm
Mechanical Time Constant	6.1 msec	6.1 msec	6.1 msec
Rotor Inertia	3.15 kgm ² x10 ⁻⁷	3.15 gm cm ²	0.45 x10 ⁻⁴ oz-in-sec ²
Mechanical Time Constant	6.1 msec	6.1 msec	6.1 msec
Slope of Speed/Torque Curve	184.7 rpm/mNm	18.1 rpm/gcm	1,304.1 rpm/oz-in
Speed Constant	898 rpm/Volt	84 %	84 %
Motor Constant	7.17 mNm/√Watt	73.07 gcm/√Watt	1.01 oz-in/√Watt
Commutation Type	Precious Metal	Precious Metal	Precious Metal
Rated Power @ 7,253 rpm	3.2 Watts	3.2 Watts	3.2 Watts
Rated Torque @ 7,253 rpm	4.2 mNm	42.9 gcm	0.6 oz-in
Rated Current @ 7,253 rpm	0.396 Amps	0.396 Amps	0.396 Amps

Part Number: How to Order C20P11SE000

Ratings are at 25°C Ambient Temperature.

Radial Load Rating	2.7 N	Radial Play	0.020 mm	Max Temperature	65 °C
Radial Load Distance	4 mm	Thrust Play	0.150 mm	Min Temperature	-20 °C
Axial Load	1.00 N	Magnet Type	NdFeB	Max Winding Temp	85 °C
Press Fit Force - Max	80.00 N	Bearing Type	Sleeve Bearings	Mass	61 grams
Gearbox Options	P22 Series Planetary Gearboxes				
Encoder Options	N/A				
Options - Other	Ball Bearings. Shaft length. Lubricants. Leads. Solder Tabs. Connectors.				

Global Motion Products

Distributed by:

Precision Motion Distributors: (925) 803-9565

Technical Support: (760) 451-2723

http://www.gmpwebsite.com Email: info@gmpwebsite.com

Commutation Type:

Precious Metal

Manufactured under a
Certified ISO 9001:2008
Quality System

RoHS Compliant

B - August 2011

Specifications Subject to change without notice

Coreless DC Motor - 20 mm Ø
C20P11SE000 - - - 9 Volts
Peak Output Power: 9.14 Watts

100 C20P11SE000
Voltage: 9 Volts
 No Load Speed: 8030 rpm
 No Load Current: 0.0282 Amps
 Terminal Resistance: 2.2 Ohms
 Stall Torque: 43.48 mNm
 Torque Constant: 10.63 mNm/A
 Peak Output Power: 9.14 Watts
 Peak Efficiency: 84.7%
 Stall Current: 4.09 Amps

Speed - rpm

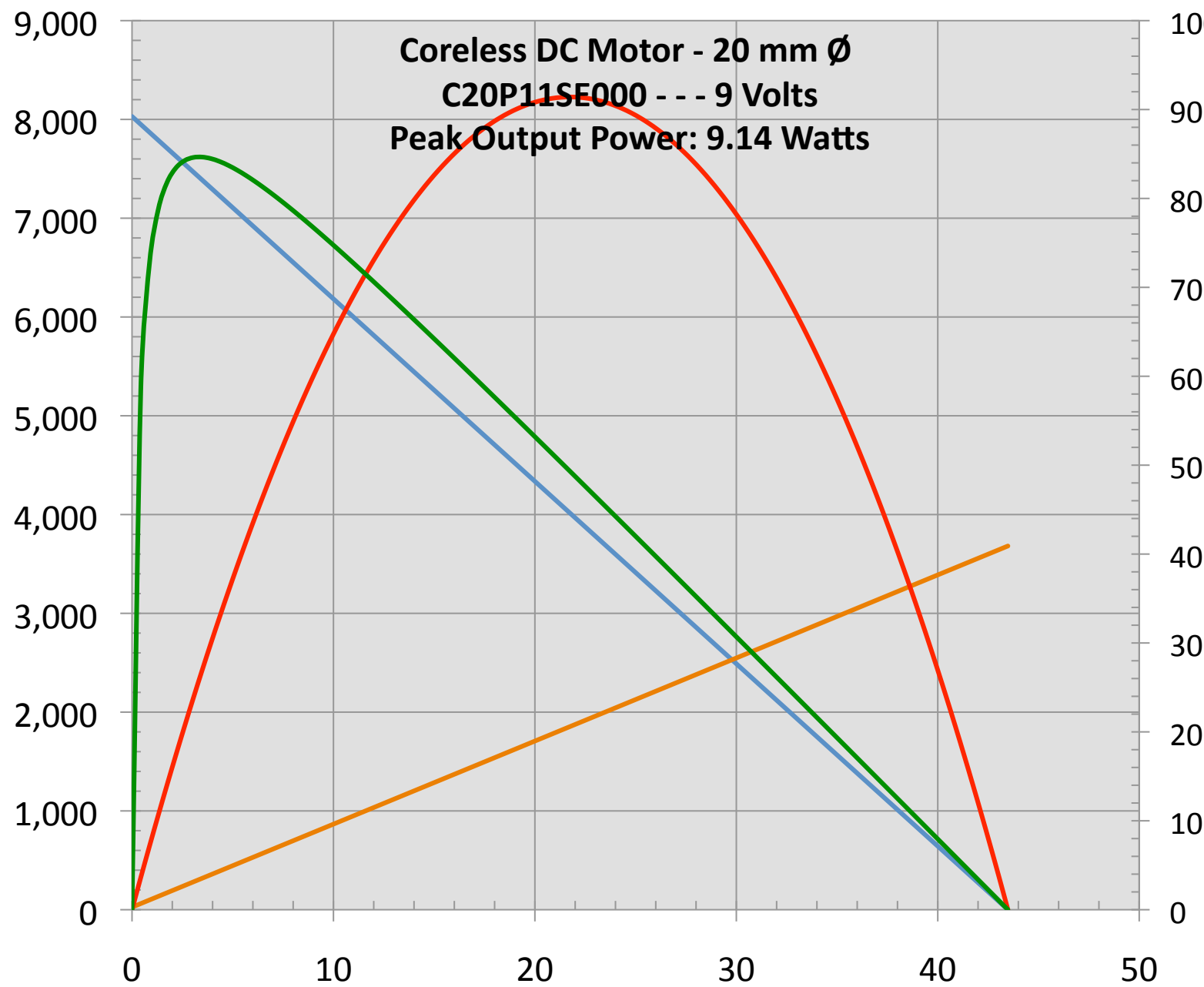

- A - Speed - rpm
- A - Current - Amps / 10
- A - Power Out - Watts / 10
- A - Efficiency - %

Global Motion Products
 Distributed by Precision Motion Distributors
 (760) 451-2723, (925) 803-9565
<http://www.gmpwebsite.com>
 Email: info@gmpwebsite.com

This Graph is provided free of charge and without any representations or warranties, express or implied, as to its suitability, legal effect, completeness, currentness, accuracy, and/or appropriateness. The simulation is with Nominal Values. The Graph is provided "as is", "as available", and with "all faults" and we disclaim any warranties, including but not limited to the motor or gearmotor's warranties of merchantability and fitness for a particular purpose. This Graph may be inappropriate for your particular circumstances. This is a simple mathematical simulation of a speed/torque curve for information purposes only. **IT IS NOT TEST DATA.**

January 18, 2011

CAUTION: Peak Output Power is NOT a RATING. This is merely a calculated value and does not address Thermal Issues.