

Coreless DC Motor - 36 mm Ø

C36G12BD000 62.8 Watts Peak Power

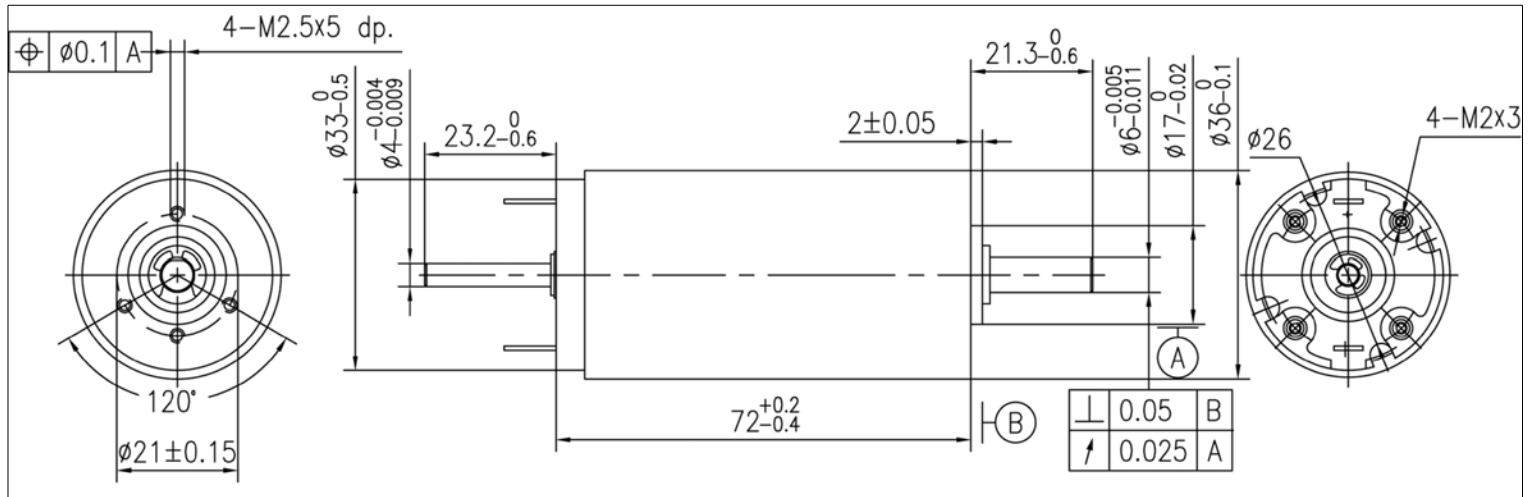

Global Motion Products



Not to Scale - Dimensions in millimeters (mm)

Nominal Voltage	12.0 Volts	12.0 Volts	12.0 Volts
No-Load Speed	6,010 rpm	6,010 rpm	6,010 rpm
Stall Torque	403.8 mNm	4,118.1 gcm	57.2 oz-in
No-Load Current	0.248 Amps	0.248 Amps	0.248 Amps
Peak Output Power	62.8 Watts	62.8 Watts	62.8 Watts
Torque Constant	18.85 mNm/A	192.18 gcm/A	2.67 oz-in/A
Terminal Resistance	0.56 Ohms	0.56 Ohms	0.56 Ohms
Back-EMF Constant	1.97 V/krpm	1.97 V/krpm	1.97 V/krpm
Mechanical Time Constant	11.8 msec	11.8 msec	11.8 msec
Rotor Inertia	75.10 kgm ² x10 ⁻⁷	75.10 gm cm ²	10.63 x10 ⁻⁴ oz-in-sec ²
Mechanical Time Constant	11.8 msec	11.8 msec	11.8 msec
Slope of Speed/Torque Curve	14.9 rpm/mNm	1.5 rpm/gcm	105.1 rpm/oz-in
Speed Constant	507 rpm/Volt	80 %	80 %
Motor Constant	25.18 mNm/√Watt	256.81 gcm/√Watt	3.57 oz-in/√Watt
Commutation Type	Metal Graphite	Metal Graphite	Metal Graphite
Rated Power @ 4,810 rpm	40.5 Watts	40.5 Watts	40.5 Watts
Rated Torque @ 4,810 rpm	80.5 mNm	821.0 gcm	11.4 oz-in
Rated Current @ 4,810 rpm	4.270 Amps	4.270 Amps	4.270 Amps

Part Number: How to Order C36G12BD000

Ratings are at 25°C Ambient Temperature.

Radial Load Rating	28.0 N	Radial Play	0.030 mm	Max Temperature	65 °C
Radial Load Distance	4 mm	Thrust Play	0.150 mm	Min Temperature	-20 °C
Axial Load	2.40 N	Magnet Type	NdFeB	Max Winding Temp	85 °C
Press Fit Force - Max	110.00 N	Bearing Type	Sleeve	Mass	340 grams
Gearbox Options	Planetary				
Encoder Options	22 mm Optical - 3 Channel				
Options - Other	Shaft length. Lubricants. Leads. Solder Tabs. Connectors.				

Global Motion Products

Distributed by:

Precision Motion Distributors: (925) 803-9565

Technical Support: (760) 451-2723

http://www.gmpwebsite.com Email: info@gmpwebsite.com

Commutation Type:

Metal Graphite

Manufactured under a
Certified ISO 9001:2008
Quality System

RoHS Compliant

B - August 2011

Specifications Subject to change without notice

Coreless DC Motor - 36 mm Ø
C36G12BD000 - - 12 Volts
Peak Output Power: 64 Watts

- 90 C36G12BD000**
Voltage: 12 Volts
 No Load Speed: 6010 rpm
 No Load Current: 0.248 Amps
 Terminal Resistance: 0.56 Ohms
 Stall Torque: 403.85 mNm
 Torque Constant: 18.85 mNm/A
 Peak Output Power: 63.5 Watts
 Peak Efficiency: 80.6%
 Stall Current: 21.43 Amps
- A - Speed - rpm
 - A - Current - Amps
 - A - Power Out - Watts
 - A - Efficiency - %

Speed - rpm

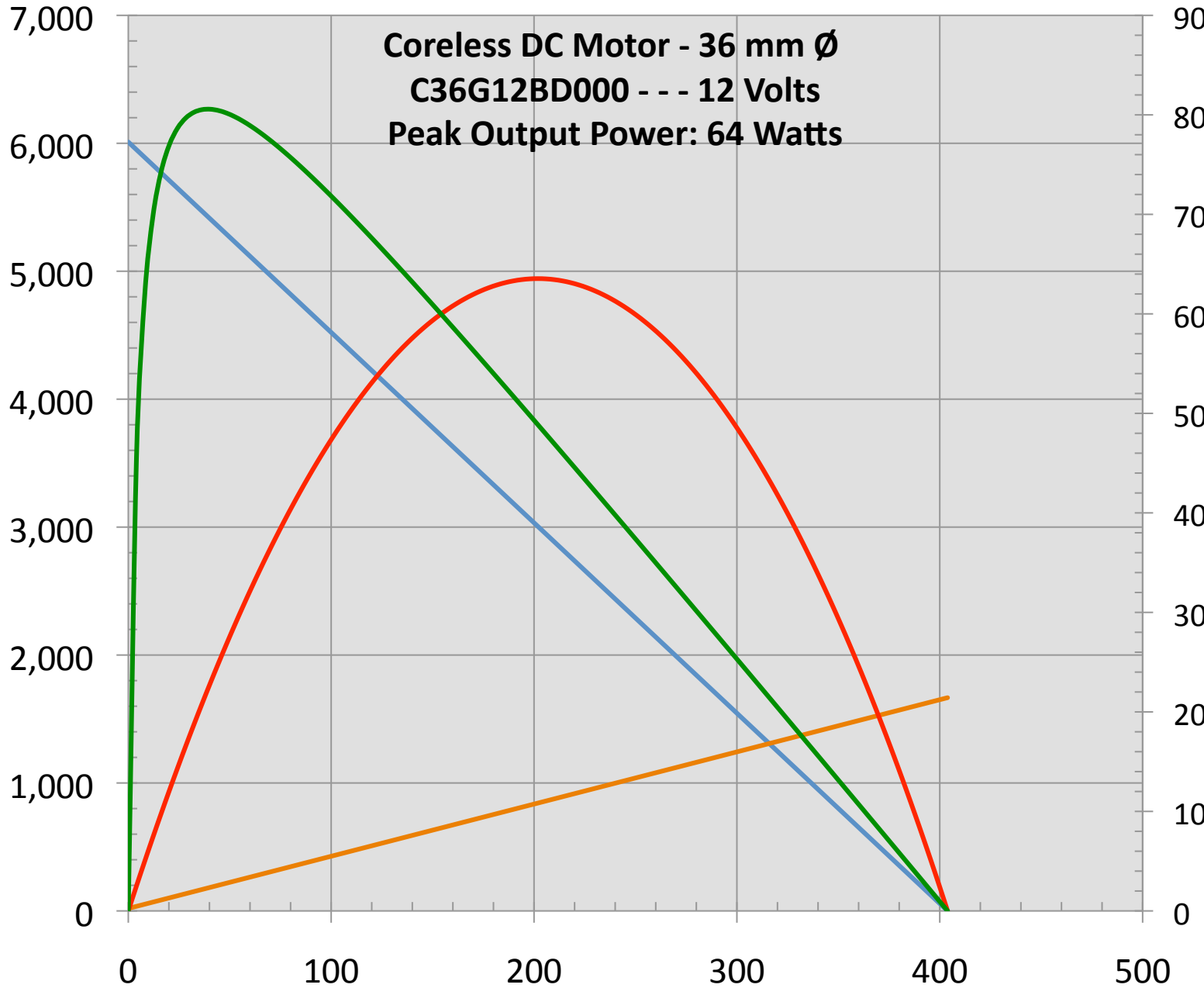

Torque - mNm

Global Motion Products
 Distributed by Precision Motion Distributors
 (760) 451-2723, (925) 803-9565
<http://www.gmpwebsite.com>
 Email: info@gmpwebsite.com

This Graph is provided free of charge and without any representations or warranties, express or implied, as to its suitability, legal effect, completeness, currentness, accuracy, and/or appropriateness. The simulation is with Nominal Values. The Graph is provided "as is", "as available", and with "all faults" and we disclaim any warranties, including but not limited to the motor or gearmotor's warranties of merchantability and fitness for a particular purpose. This Graph may be inappropriate for your particular circumstances. This is a simple mathematical simulation of a speed/torque curve for information purposes only. **IT IS NOT TEST DATA.**

January 18, 2011

CAUTION: Peak Output Power is NOT a RATING. This is merely a calculated value and does not address Thermal Issues.

Coreless DC Motor - 36 mm Ø

C36G15BD000 80.1 Watts Peak Power



Global Motion Products

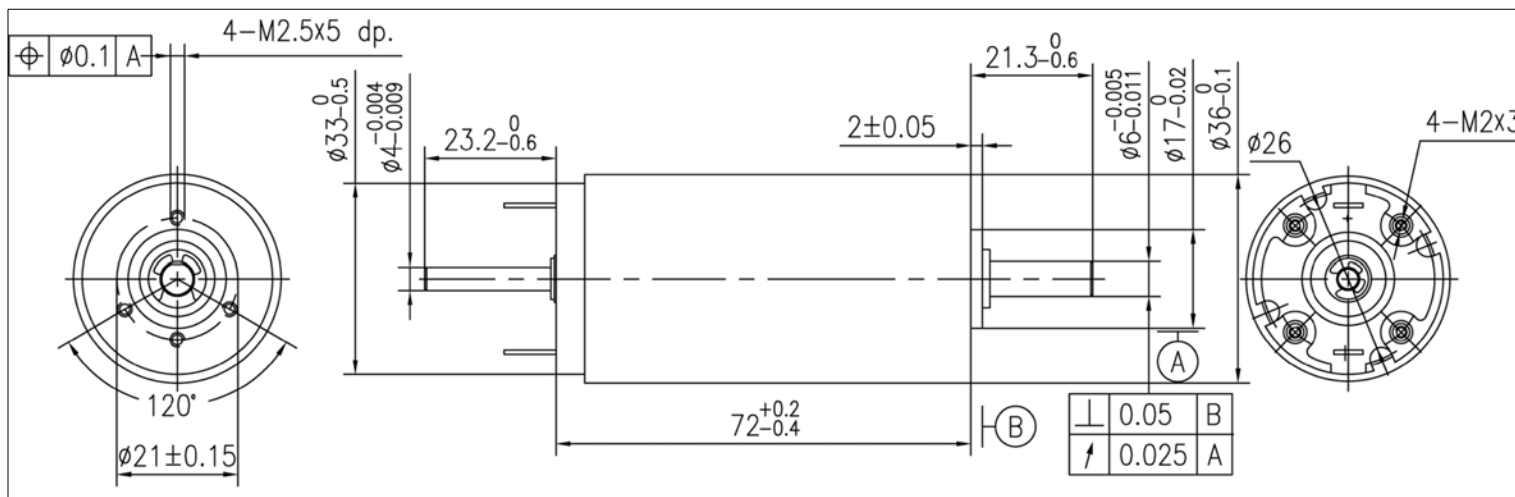

Not to Scale - Dimensions in millimeters (mm)

Nominal Voltage	15.0 Volts	15.0 Volts	15.0 Volts
No-Load Speed	6,260 rpm	6,260 rpm	6,260 rpm
Stall Torque	493.1 mNm	5,028.0 gcm	69.8 oz-in
No-Load Current	0.190 Amps	0.190 Amps	0.190 Amps
Peak Output Power	80.1 Watts	80.1 Watts	80.1 Watts
Torque Constant	22.68 mNm/A	231.29 gcm/A	3.21 oz-in/A
Terminal Resistance	0.69 Ohms	0.69 Ohms	0.69 Ohms
Back-EMF Constant	2.38 V/krpm	2.38 V/krpm	2.38 V/krpm
Mechanical Time Constant	9.2 msec	9.2 msec	9.2 msec
Rotor Inertia	68.60 kgm ² x10 ⁻⁷	68.60 gm cm ²	9.71 x10 ⁻⁴ oz-in-sec ²
Mechanical Time Constant	9.2 msec	9.2 msec	9.2 msec
Slope of Speed/Torque Curve	12.7 rpm/mNm	1.2 rpm/gcm	89.7 rpm/oz-in
Speed Constant	421 rpm/Volt	82 %	82 %
Motor Constant	27.31 mNm/√Watt	278.44 gcm/√Watt	3.87 oz-in/√Watt
Commutation Type	Metal Graphite	Metal Graphite	Metal Graphite
Rated Power @ 5,288 rpm	42.3 Watts	42.3 Watts	42.3 Watts
Rated Torque @ 5,288 rpm	76.3 mNm	778.5 gcm	10.8 oz-in
Rated Current @ 5,288 rpm	3.364 Amps	3.364 Amps	3.364 Amps

Part Number: How to Order C36G15BD000

Ratings are at 25°C Ambient Temperature.

Radial Load Rating	28.0 N	Radial Play	0.030 mm	Max Temperature	65 °C
Radial Load Distance	4 mm	Thrust Play	0.150 mm	Min Temperature	-20 °C
Axial Load	2.40 N	Magnet Type	NdFeB	Max Winding Temp	85 °C
Press Fit Force - Max	110.00 N	Bearing Type	Sleeve	Mass	340 grams
Gearbox Options	Planetary				
Encoder Options	22 mm Optical - 3 Channel				
Options - Other	Shaft length. Lubricants. Leads. Solder Tabs. Connectors.				

Global Motion Products

Distributed by:

Precision Motion Distributors: (925) 803-9565

Technical Support: (760) 451-2723

http://www.gmpwebsite.com Email: info@gmpwebsite.com

Commutation Type:

Metal Graphite

Manufactured under a
Certified ISO 9001:2008
Quality System

RoHS Compliant

B - August 2011

Specifications Subject to change without notice

Coreless DC Motor - 36 mm Ø
C36G15BD000 - - - 15 Volts
Peak Output Power: 81 Watts

90 C36G15BD000
Voltage: 15 Volts
 No Load Speed: 6260 rpm
 No Load Current: 0.19 Amps
 Terminal Resistance: 0.69 Ohms
 Stall Torque: 493.08 mNm
 Torque Constant: 22.68 mNm/A
 Peak Output Power: 80.8 Watts
 Peak Efficiency: 82.9%
 Stall Current: 21.74 Amps

Speed - rpm

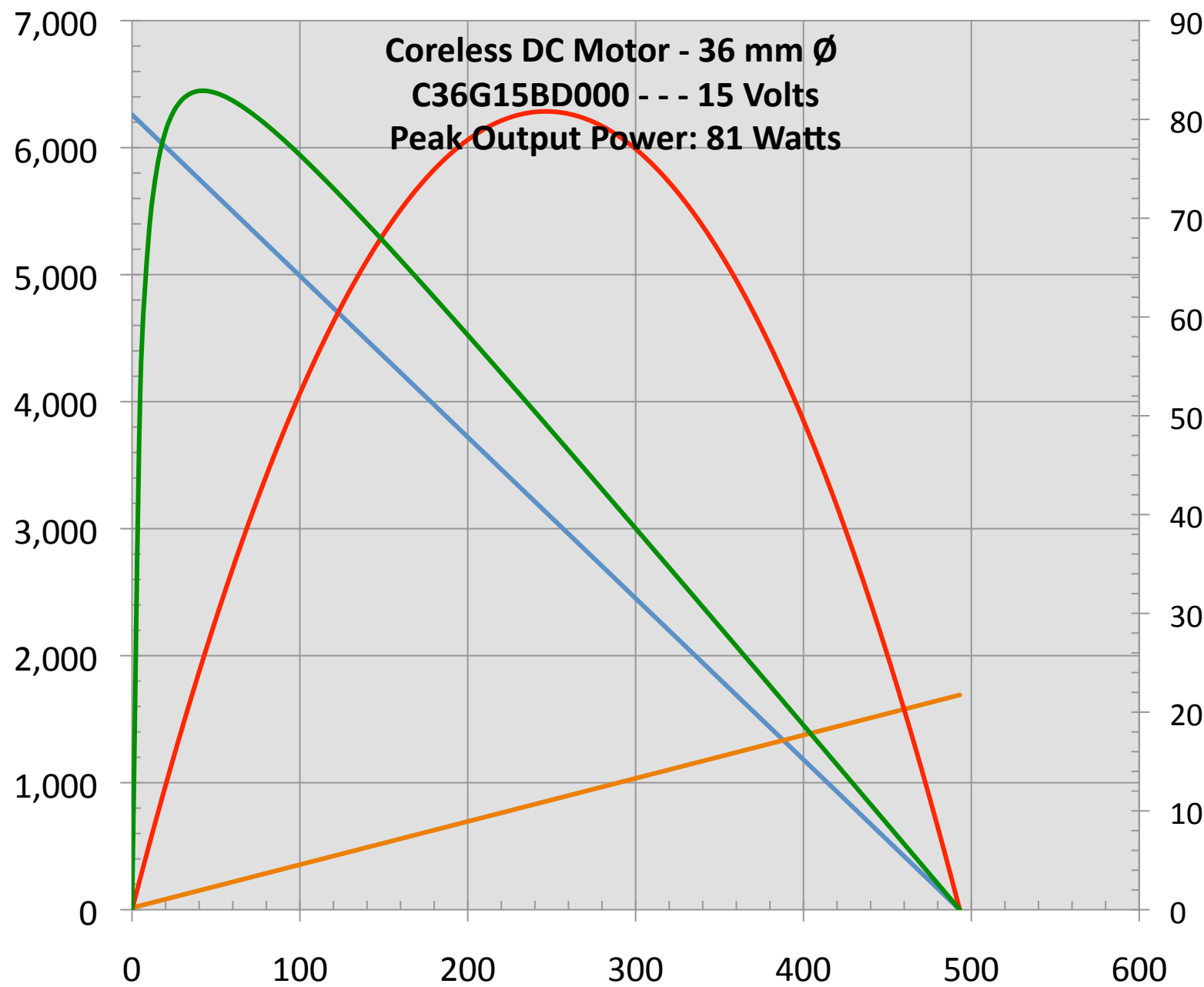

— A - Speed - rpm
 — A - Current - Amps
 — A - Power Out - Watts
 — A - Efficiency - %

Torque - mNm

Global Motion Products
 Distributed by Precision Motion Distributors
 (760) 451-2723, (925) 803-9565
<http://www.gmpwebsite.com>
 Email: info@gmpwebsite.com

This Graph is provided free of charge and without any representations or warranties, express or implied, as to its suitability, legal effect, completeness, currentness, accuracy, and/or appropriateness. The simulation is with Nominal Values. The Graph is provided "as is", "as available", and with "all faults" and we disclaim any warranties, including but not limited to the motor or gearmotor's warranties of merchantability and fitness for a particular purpose. This Graph may be inappropriate for your particular circumstances. This is a simple mathematical simulation of a speed/torque curve for information purposes only. **IT IS NOT TEST DATA.**

January 18, 2011

CAUTION: Peak Output Power is NOT a RATING. This is merely a calculated value and does not address Thermal Issues.

Coreless DC Motor - 36 mm Ø

C36G18BD000 87.5 Watts Peak Power



Global Motion Products

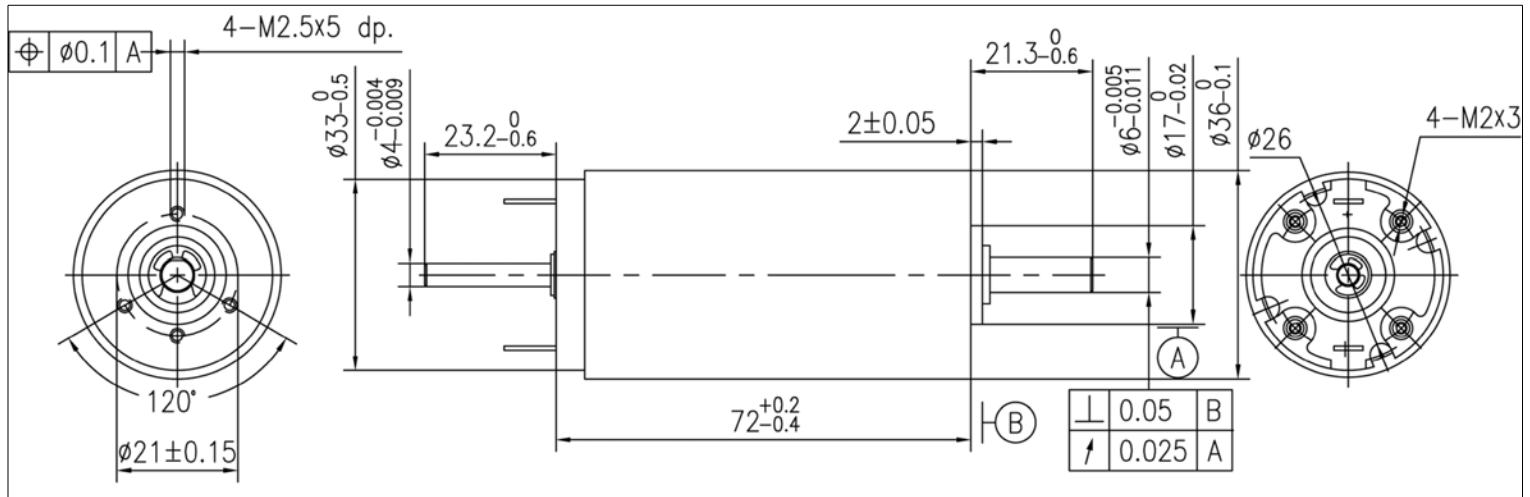

Not to Scale - Dimensions in millimeters (mm)

Nominal Voltage	18.0 Volts	18.0 Volts	18.0 Volts
No-Load Speed	6,100 rpm	6,100 rpm	6,100 rpm
Stall Torque	552.6 mNm	5,634.8 gcm	78.3 oz-in
No-Load Current	0.170 Amps	0.170 Amps	0.170 Amps
Peak Output Power	87.5 Watts	87.5 Watts	87.5 Watts
Torque Constant	27.94 mNm/A	284.87 gcm/A	3.96 oz-in/A
Terminal Resistance	0.91 Ohms	0.91 Ohms	0.91 Ohms
Back-EMF Constant	2.93 V/krpm	2.93 V/krpm	2.93 V/krpm
Mechanical Time Constant	8.6 msec	8.6 msec	8.6 msec
Rotor Inertia	73.80 kgm ² x10 ⁻⁷	73.80 gm cm ²	10.45 x10 ⁻⁴ oz-in-sec ²
Mechanical Time Constant	8.6 msec	8.6 msec	8.6 msec
Slope of Speed/Torque Curve	11.0 rpm/mNm	1.1 rpm/gcm	78.0 rpm/oz-in
Speed Constant	342 rpm/Volt	82 %	82 %
Motor Constant	29.28 mNm/√Watt	298.62 gcm/√Watt	4.15 oz-in/√Watt
Commutation Type	Metal Graphite	Metal Graphite	Metal Graphite
Rated Power @ 5,282 rpm	40.9 Watts	40.9 Watts	40.9 Watts
Rated Torque @ 5,282 rpm	74.0 mNm	754.7 gcm	10.5 oz-in
Rated Current @ 5,282 rpm	2.648 Amps	2.648 Amps	2.648 Amps

Part Number: How to Order C36G18BD000

Ratings are at 25°C Ambient Temperature.

Radial Load Rating	28.0 N	Radial Play	0.030 mm	Max Temperature	65 °C
Radial Load Distance	4 mm	Thrust Play	0.150 mm	Min Temperature	-20 °C
Axial Load	2.40 N	Magnet Type	NdFeB	Max Winding Temp	85 °C
Press Fit Force - Max	110.00 N	Bearing Type	Sleeve	Mass	340 grams
Gearbox Options	Planetary				
Encoder Options	22 mm Optical - 3 Channel				
Options - Other	Shaft length. Lubricants. Leads. Solder Tabs. Connectors.				

Global Motion Products

Distributed by:

Precision Motion Distributors: (925) 803-9565

Technical Support: (760) 451-2723

http://www.gmpwebsite.com Email: info@gmpwebsite.com

Commutation Type:

Metal Graphite

Manufactured under a
Certified ISO 9001:2008
Quality System

RoHS Compliant

B - August 2011

Specifications Subject to change without notice

Coreless DC Motor - 36 mm Ø
C36G18BD000 - - - 18 Volts
Peak Output Power: 88 Watts

100 C36G18BD000
Voltage: 18 Volts
 No Load Speed: 6100 rpm
 No Load Current: 0.17 Amps
 Terminal Resistance: 0.91 Ohms
 Stall Torque: 552.58 mNm
 Torque Constant: 27.94 mNm/A
 Peak Output Power: 88.2 Watts
 Peak Efficiency: 83%
 Stall Current: 19.78 Amps

Speed - rpm

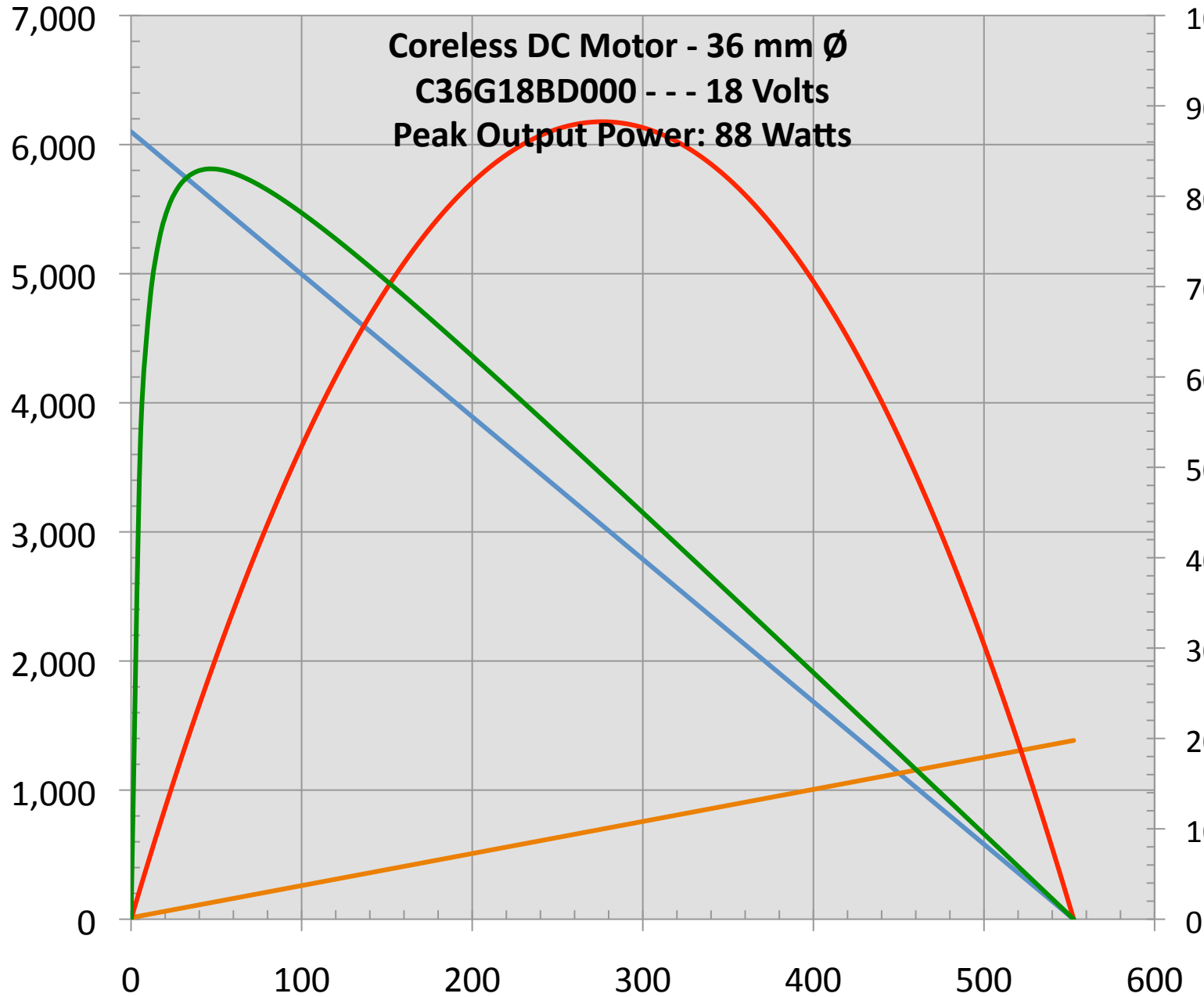

— A - Speed - rpm
 — A - Current - Amps
 — A - Power Out - Watts
 — A - Efficiency - %

Global Motion Products
 Distributed by Precision Motion Distributors
 (760) 451-2723, (925) 803-9565
<http://www.gmpwebsite.com>
 Email: info@gmpwebsite.com

This Graph is provided free of charge and without any representations or warranties, express or implied, as to its suitability, legal effect, completeness, currentness, accuracy, and/or appropriateness. The simulation is with Nominal Values. The Graph is provided "as is", "as available", and with "all faults" and we disclaim any warranties, including but not limited to the motor or gearmotor's warranties of merchantability and fitness for a particular purpose. This Graph may be inappropriate for your particular circumstances. This is a simple mathematical simulation of a speed/torque curve for information purposes only. **IT IS NOT TEST DATA.**

January 18, 2011

CAUTION: Peak Output Power is NOT a RATING. This is merely a calculated value and does not address Thermal Issues.

Coreless DC Motor - 36 mm Ø

C36G24BD000 131.1 Watts Peak Power



Global Motion Products

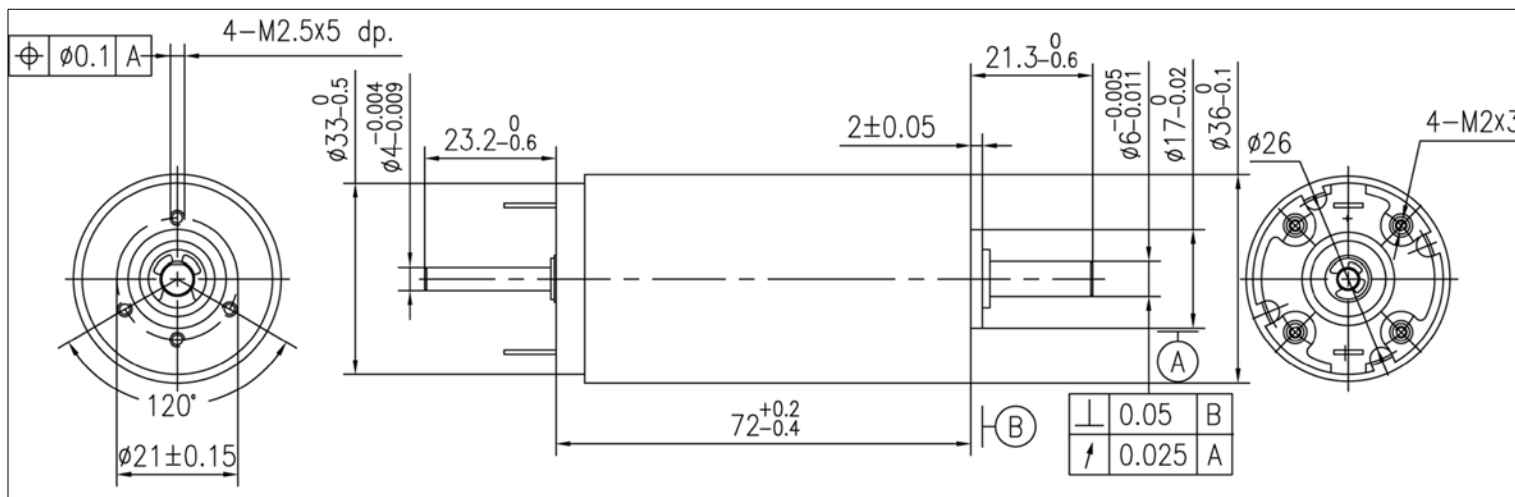

Not to Scale - Dimensions in millimeters (mm)

Nominal Voltage	24.0 Volts	24.0 Volts	24.0 Volts
No-Load Speed	6,360 rpm	6,360 rpm	6,360 rpm
Stall Torque	790.3 mNm	8,058.5 gcm	111.9 oz-in
No-Load Current	0.088 Amps	0.088 Amps	0.088 Amps
Peak Output Power	131.1 Watts	131.1 Watts	131.1 Watts
Torque Constant	35.89 mNm/A	365.99 gcm/A	5.08 oz-in/A
Terminal Resistance	1.09 Ohms	1.09 Ohms	1.09 Ohms
Back-EMF Constant	3.76 V/krpm	3.76 V/krpm	3.76 V/krpm
Mechanical Time Constant	6.8 msec	6.8 msec	6.8 msec
Rotor Inertia	80.30 kgm ² x10 ⁻⁷	80.30 gm cm ²	11.37 x10 ⁻⁴ oz-in-sec ²
Mechanical Time Constant	6.8 msec	6.8 msec	6.8 msec
Slope of Speed/Torque Curve	8.0 rpm/mNm	0.8 rpm/gcm	56.8 rpm/oz-in
Speed Constant	266 rpm/Volt	88 %	88 %
Motor Constant	34.38 mNm/√Watt	350.56 gcm/√Watt	4.87 oz-in/√Watt
Commutation Type	Metal Graphite	Metal Graphite	Metal Graphite
Rated Power @ 5,580 rpm	56.7 Watts	56.7 Watts	56.7 Watts
Rated Torque @ 5,580 rpm	97.0 mNm	989.4 gcm	13.7 oz-in
Rated Current @ 5,580 rpm	2.702 Amps	2.702 Amps	2.702 Amps

Part Number: How to Order C36G24BD000

Ratings are at 25°C Ambient Temperature.

Radial Load Rating	28.0 N	Radial Play	0.030 mm	Max Temperature	65 °C
Radial Load Distance	4 mm	Thrust Play	0.150 mm	Min Temperature	-20 °C
Axial Load	2.40 N	Magnet Type	NdFeB	Max Winding Temp	85 °C
Press Fit Force - Max	110.00 N	Bearing Type	Sleeve	Mass	340 grams
Gearbox Options	Planetary				
Encoder Options	22 mm Optical - 3 Channel				
Options - Other	Shaft length. Lubricants. Leads. Solder Tabs. Connectors.				

Global Motion Products

Distributed by:

Precision Motion Distributors: (925) 803-9565

Technical Support: (760) 451-2723

http://www.gmpwebsite.com Email: info@gmpwebsite.com

Commutation Type:

Metal Graphite

Manufactured under a
Certified ISO 9001:2008
Quality System

RoHS Compliant

B - August 2011

Specifications Subject to change without notice

Coreless DC Motor - 36 mm Ø
C36G24BD000 - - - 24 Volts
Peak Output Power: 132 Watts

140 C36G24BD000
Voltage: 24 Volts
 No Load Speed: 6360 rpm
 No Load Current: 0.0878 Amps
 Terminal Resistance: 1.09 Ohms
 Stall Torque: 790.27 mNm
 Torque Constant: 35.89 mNm/A
 Peak Output Power: 131.6 Watts
 Peak Efficiency: 88.1%
 Stall Current: 22.02 Amps

Speed - rpm

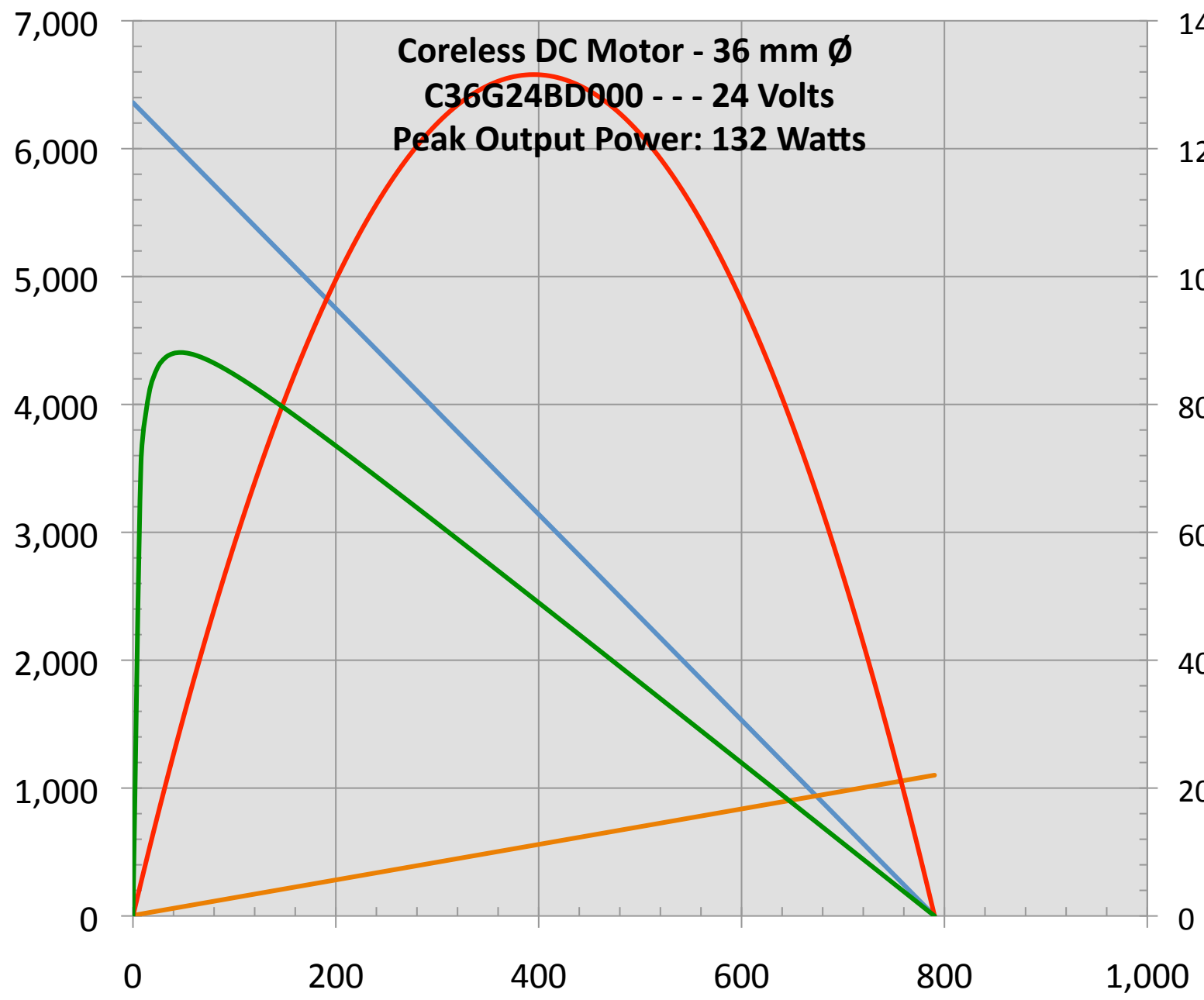

- A - Speed - rpm
- A - Current - Amps
- A - Power Out - Watts
- A - Efficiency - %

Torque - mNm

Global Motion Products
 Distributed by Precision Motion Distributors
 (760) 451-2723, (925) 803-9565
<http://www.gmpwebsite.com>
 Email: info@gmpwebsite.com

This Graph is provided free of charge and without any representations or warranties, express or implied, as to its suitability, legal effect, completeness, currentness, accuracy, and/or appropriateness. The simulation is with Nominal Values. The Graph is provided "as is", "as available", and with "all faults" and we disclaim any warranties, including but not limited to the motor or gearmotor's warranties of merchantability and fitness for a particular purpose. This Graph may be inappropriate for your particular circumstances. This is a simple mathematical simulation of a speed/torque curve for information purposes only. **IT IS NOT TEST DATA.**

January 18, 2011

CAUTION: Peak Output Power is NOT a RATING. This is merely a calculated value and does not address Thermal Issues.

Coreless DC Motor - 36 mm Ø

C36G30BD000 111.7 Watts Peak Power



Global Motion Products

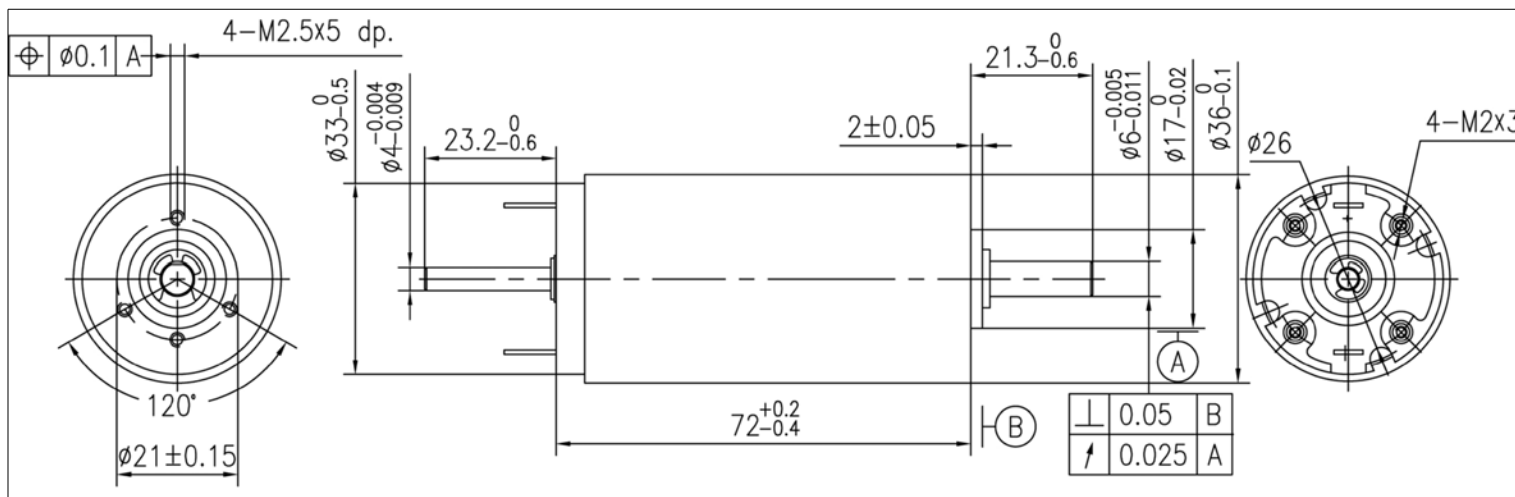

Not to Scale - Dimensions in millimeters (mm)

Nominal Voltage	30.0 Volts	30.0 Volts	30.0 Volts
No-Load Speed	6,090 rpm	6,090 rpm	6,090 rpm
Stall Torque	703.1 mNm	7,169.4 gcm	99.6 oz-in
No-Load Current	0.054 Amps	0.054 Amps	0.054 Amps
Peak Output Power	111.7 Watts	111.7 Watts	111.7 Watts
Torque Constant	46.87 mNm/A	477.96 gcm/A	6.64 oz-in/A
Terminal Resistance	2.00 Ohms	2.00 Ohms	2.00 Ohms
Back-EMF Constant	4.91 V/krpm	4.91 V/krpm	4.91 V/krpm
Mechanical Time Constant	6.4 msec	6.4 msec	6.4 msec
Rotor Inertia	70.10 kgm ² x10 ⁻⁷	70.10 gm cm ²	9.93 x10 ⁻⁴ oz-in-sec ²
Mechanical Time Constant	6.4 msec	6.4 msec	6.4 msec
Slope of Speed/Torque Curve	8.7 rpm/mNm	0.8 rpm/gcm	61.2 rpm/oz-in
Speed Constant	204 rpm/Volt	88 %	88 %
Motor Constant	33.14 mNm/√Watt	337.97 gcm/√Watt	4.69 oz-in/√Watt
Commutation Type	Metal Graphite	Metal Graphite	Metal Graphite
Rated Power @ 5,407 rpm	44.6 Watts	44.6 Watts	44.6 Watts
Rated Torque @ 5,407 rpm	78.9 mNm	804.4 gcm	11.2 oz-in
Rated Current @ 5,407 rpm	1.682 Amps	1.682 Amps	1.682 Amps

Part Number: How to Order C36G30BD000

Ratings are at 25°C Ambient Temperature.

Radial Load Rating	28.0 N	Radial Play	0.030 mm	Max Temperature	65 °C
Radial Load Distance	4 mm	Thrust Play	0.150 mm	Min Temperature	-20 °C
Axial Load	2.40 N	Magnet Type	NdFeB	Max Winding Temp	85 °C
Press Fit Force - Max	110.00 N	Bearing Type	Ball Bearings	Mass	340 grams
Gearbox Options	Planetary				
Encoder Options	22 mm Optical - 3 Channel				
Options - Other	Shaft length. Lubricants. Leads. Solder Tabs. Connectors.				

Global Motion Products

Distributed by:

Precision Motion Distributors: (925) 803-9565

Technical Support: (760) 451-2723

http://www.gmpwebsite.com Email: info@gmpwebsite.com

Commutation Type:

Metal Graphite

Manufactured under a
Certified ISO 9001:2008
Quality System

RoHS Compliant

B - August 2011

Specifications Subject to change without notice

**Coreless DC Motor - 36 mm Ø
C36G30BD000 - - - 30 Volts
Peak Output Power: 112 Watts**

120 C36G30BD000
Voltage: 30 Volts
 No Load Speed: 6090 rpm
 No Load Current: 0.0539 Amps
 Terminal Resistance: 2 Ohms
 Stall Torque: 703.08 mNm
 Torque Constant: 46.87 mNm/A
 Peak Output Power: 112.1 Watts
 Peak Efficiency: 88.7%
 Stall Current: 15 Amps

Speed - rpm

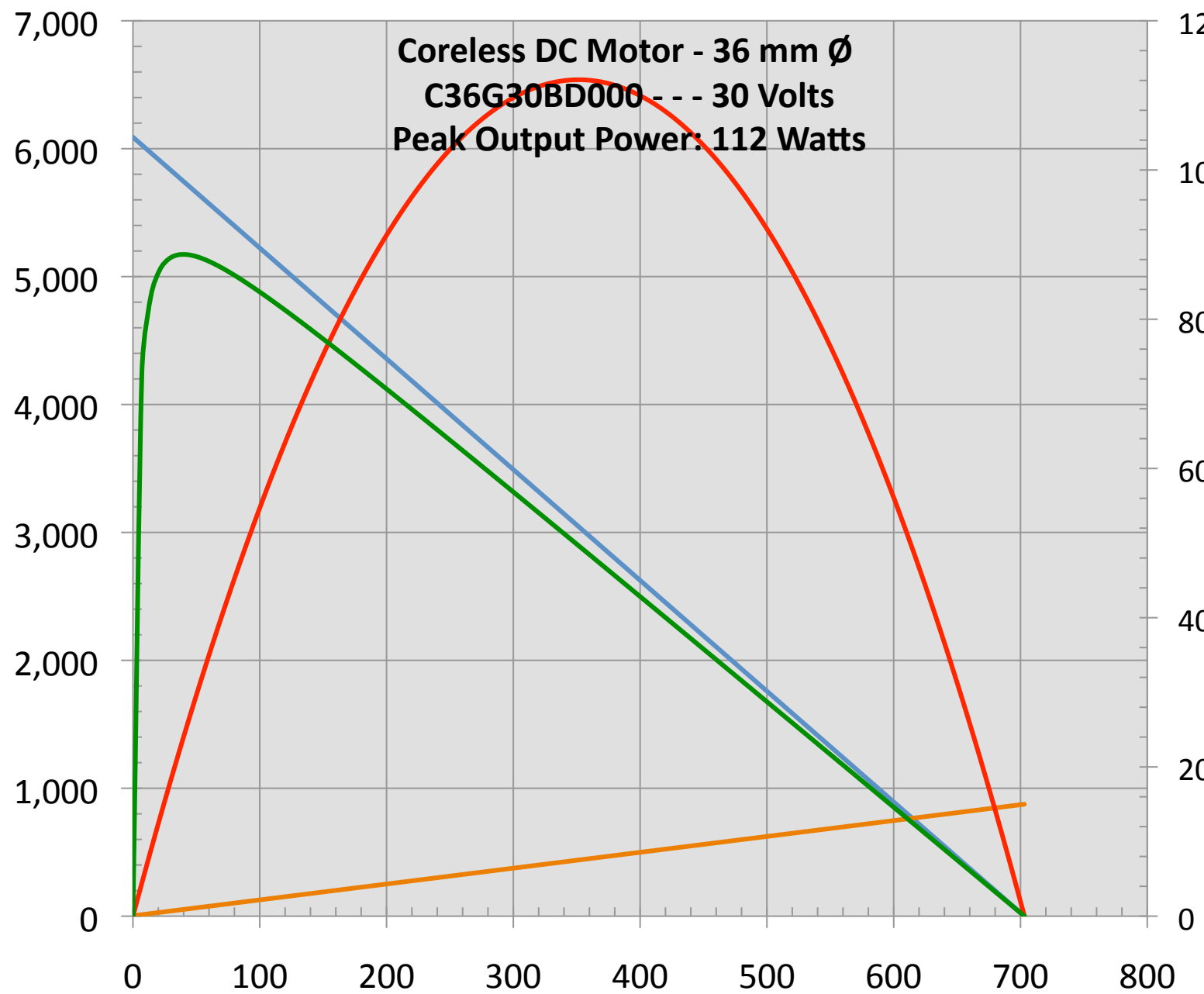

— A - Speed - rpm
 — A - Current - Amps
 — A - Power Out - Watts
 — A - Efficiency - %

Torque - mNm

Global Motion Products
 Distributed by Precision Motion Distributors
 (760) 451-2723, (925) 803-9565
<http://www.gmpwebsite.com>
 Email: info@gmpwebsite.com

This Graph is provided free of charge and without any representations or warranties, express or implied, as to its suitability, legal effect, completeness, currentness, accuracy, and/or appropriateness. The simulation is with Nominal Values. The Graph is provided "as is", "as available", and with "all faults" and we disclaim any warranties, including but not limited to the motor or gearmotor's warranties of merchantability and fitness for a particular purpose. This Graph may be inappropriate for your particular circumstances. This is a simple mathematical simulation of a speed/torque curve for information purposes only. **IT IS NOT TEST DATA.**

January 18, 2011

CAUTION: Peak Output Power is NOT a RATING. This is merely a calculated value and does not address Thermal Issues.

Coreless DC Motor - 36 mm Ø

C36G36BD000 110.8 Watts Peak Power



Global Motion Products

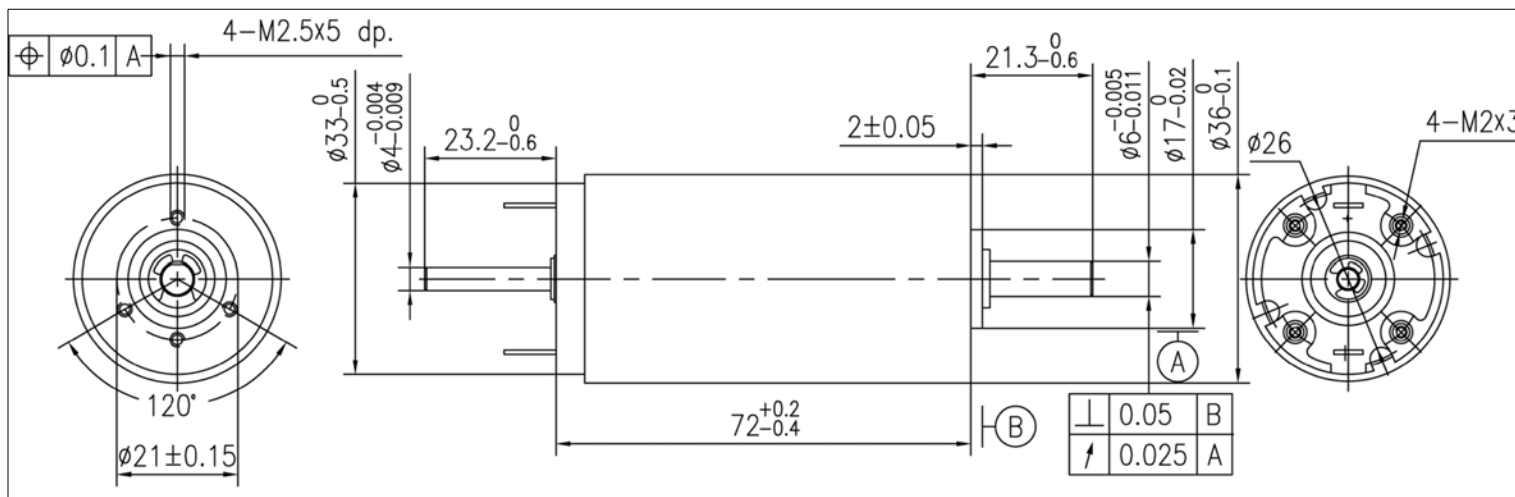

Not to Scale - Dimensions in millimeters (mm)

Nominal Voltage	36.0 Volts	36.0 Volts	36.0 Volts
No-Load Speed	6,220 rpm	6,220 rpm	6,220 rpm
Stall Torque	683.4 mNm	6,968.3 gcm	96.8 oz-in
No-Load Current	0.050 Amps	0.050 Amps	0.050 Amps
Peak Output Power	110.8 Watts	110.8 Watts	110.8 Watts
Torque Constant	55.05 mNm/A	561.34 gcm/A	7.80 oz-in/A
Terminal Resistance	2.90 Ohms	2.90 Ohms	2.90 Ohms
Back-EMF Constant	5.76 V/krpm	5.76 V/krpm	5.76 V/krpm
Mechanical Time Constant	6.9 msec	6.9 msec	6.9 msec
Rotor Inertia	71.90 kgm ² x10 ⁻⁷	71.90 gm cm ²	10.18 x10 ⁻⁴ oz-in-sec ²
Mechanical Time Constant	6.9 msec	6.9 msec	6.9 msec
Slope of Speed/Torque Curve	9.1 rpm/mNm	0.9 rpm/gcm	64.3 rpm/oz-in
Speed Constant	173 rpm/Volt	88 %	88 %
Motor Constant	32.33 mNm/√Watt	329.63 gcm/√Watt	4.58 oz-in/√Watt
Commutation Type	Metal Graphite	Metal Graphite	Metal Graphite
Rated Power @ 5,557 rpm	42.4 Watts	42.4 Watts	42.4 Watts
Rated Torque @ 5,557 rpm	72.9 mNm	743.6 gcm	10.3 oz-in
Rated Current @ 5,557 rpm	1.324 Amps	1.324 Amps	1.324 Amps

Part Number: How to Order C36G36BD000

Ratings are at 25°C Ambient Temperature.

Radial Load Rating	28.0 N	Radial Play	0.030 mm	Max Temperature	65 °C
Radial Load Distance	4 mm	Thrust Play	0.150 mm	Min Temperature	-20 °C
Axial Load	2.40 N	Magnet Type	NdFeB	Max Winding Temp	85 °C
Press Fit Force - Max	110.00 N	Bearing Type	Ball Bearings	Mass	340 grams
Gearbox Options	Planetary				
Encoder Options	22 mm Optical - 3 Channel				
Options - Other	Shaft length. Lubricants. Leads. Solder Tabs. Connectors.				

Global Motion Products

Distributed by:

Precision Motion Distributors: (925) 803-9565

Technical Support: (760) 451-2723

http://www.gmpwebsite.com Email: info@gmpwebsite.com

Commutation Type:

Metal Graphite

Manufactured under a
Certified ISO 9001:2008
Quality System

RoHS Compliant

B - August 2011

Specifications Subject to change without notice

Coreless DC Motor - 36 mm Ø
C36G36BD000 - - - 36 Volts
Peak Output Power: 111 Watts

120 C36G36BD000
Voltage: 36 Volts
 No Load Speed: 6220 rpm
 No Load Current: 0.0496 Amps
 Terminal Resistance: 2.9 Ohms
 Stall Torque: 683.36 mNm
 Torque Constant: 55.05 mNm/A
 Peak Output Power: 111.3 Watts
 Peak Efficiency: 88.1%
 Stall Current: 12.41 Amps

Speed - rpm

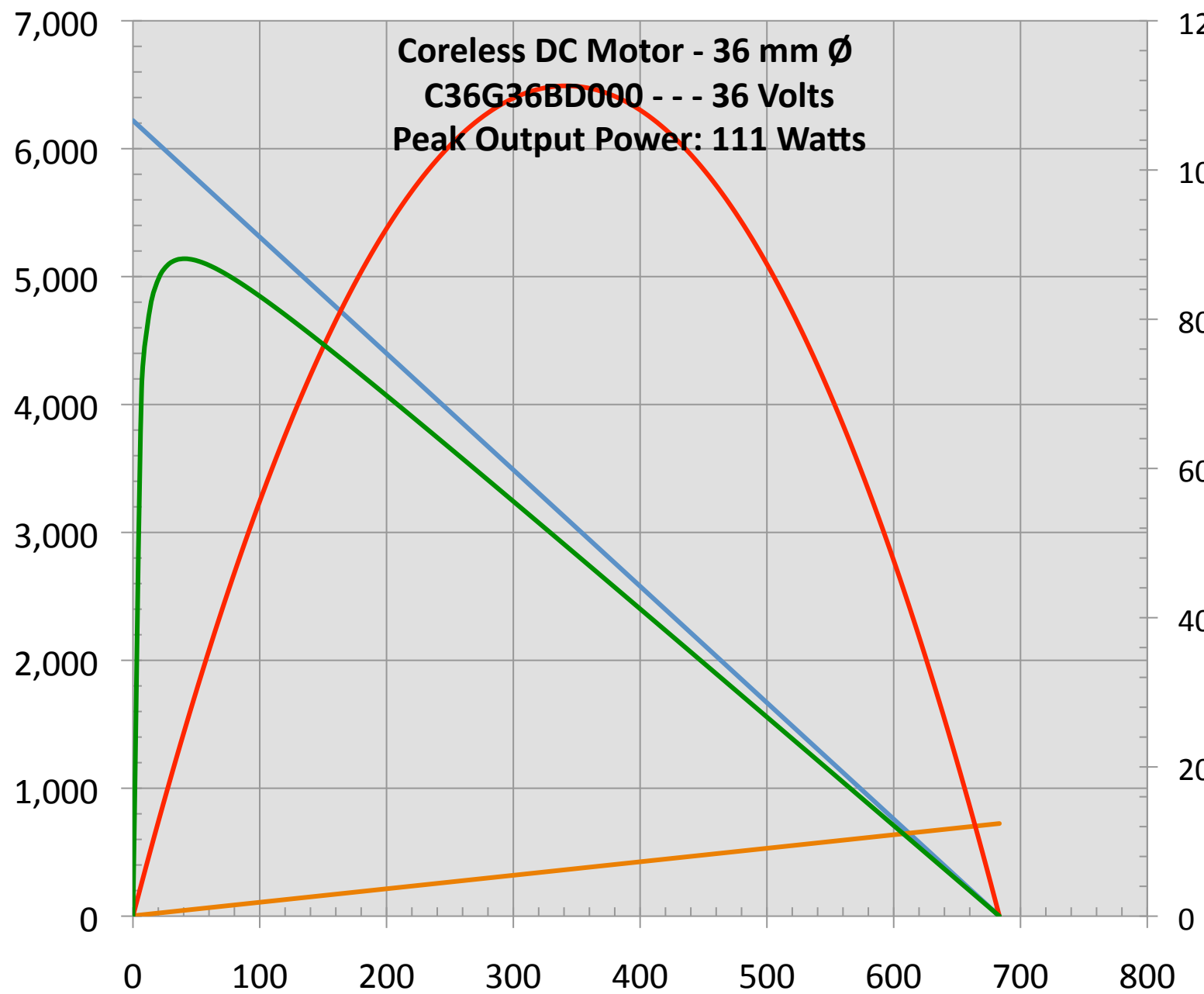

- A - Speed - rpm
- A - Current - Amps
- A - Power Out - Watts
- A - Efficiency - %

Global Motion Products
 Distributed by Precision Motion Distributors
 (760) 451-2723, (925) 803-9565
<http://www.gmpwebsite.com>
 Email: info@gmpwebsite.com

This Graph is provided free of charge and without any representations or warranties, express or implied, as to its suitability, legal effect, completeness, currentness, accuracy, and/or appropriateness. The simulation is with Nominal Values. The Graph is provided "as is", "as available", and with "all faults" and we disclaim any warranties, including but not limited to the motor or gearmotor's warranties of merchantability and fitness for a particular purpose. This Graph may be inappropriate for your particular circumstances. This is a simple mathematical simulation of a speed/torque curve for information purposes only. **IT IS NOT TEST DATA.**

January 18, 2011

CAUTION: Peak Output Power is NOT a RATING. This is merely a calculated value and does not address Thermal Issues.