

BLDC Slotless Motor - 12 mm Ø

B12E07SG000

12.9 Watts Peak Power



Global Motion Products

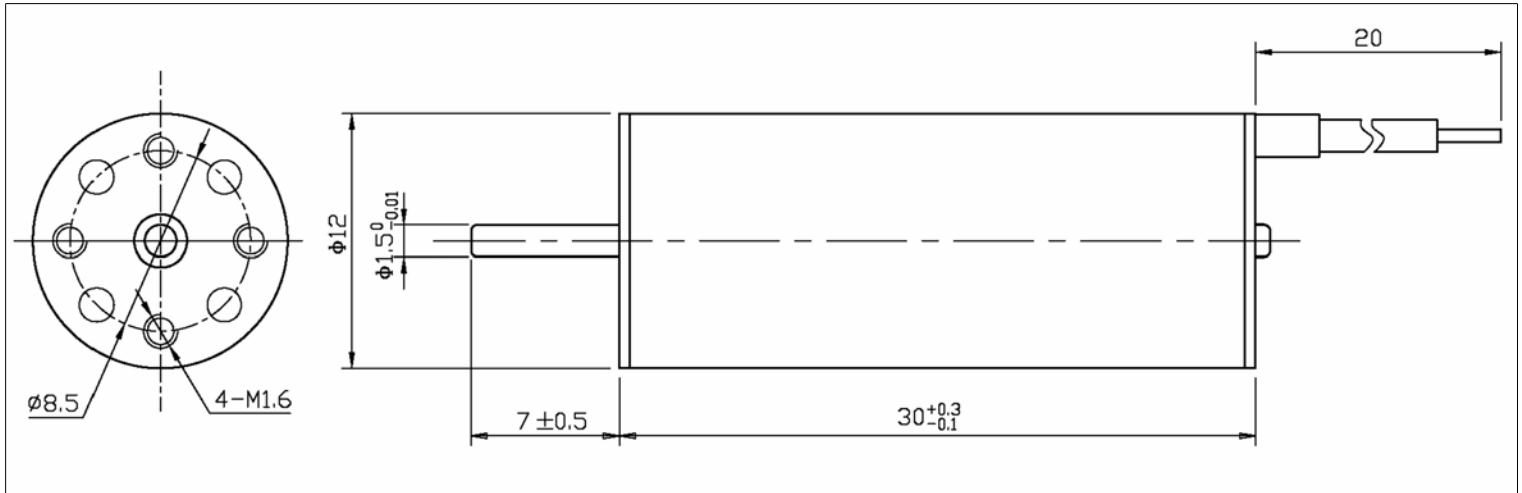

Not to Scale - Dimensions in millimeters (mm)

Nominal Voltage	7.4 Volts	7.4 Volts	7.4 Volts
No-Load Speed	27,000 rpm	27,000 rpm	27,000 rpm
Stall Torque	18.8 mNm	192.0 gcm	2.66 oz-in
No-Load Current	0.220 Amps	0.220 Amps	0.220 Amps
Peak Output Power	12.9 Watts	12.9 Watts	12.9 Watts
Torque Constant	2.54 mNm/A	25.89 gcm/A	0.36 oz-in/A
Terminal Resistance	1.00 Ohms	1.00 Ohms	1.00 Ohms
Back-EMF Constant	0.27 V/krpm	0.27 V/krpm	0.27 V/krpm
Inductance			
Rotor Inertia	0.220 kg-m ² x10 ⁻⁷	0.220 gm cm ²	0.031 x10 ⁻⁴ oz in sec ²
Mechanical Time Constant	3.4 msec	3.4 msec	3.4 msec
Slope of Speed/Torque Curve	1,436.8 rpm/mNm	140.6 rpm/gcm	10,146.1 rpm/oz-in
Speed Constant	3,760 rpm/Volt	3,760 rpm/Volt	3,760 rpm/Volt
Motor Constant	2.54 mNm/√Watt	25.89 gcm/√Watt	0.36 oz-in/√Watt

Zero Cogging High Speed Capable 3 Phase Brushless DC Motor featuring Neodymium Iron Boron Magnets.

Part Number:	How to Order	Characteristics - Specifications at		22 °C
	B12E07SG000			
Radial Load Rating	Radial Play	Max Temperature	45 °C	
Radial Load Distance	Thrust Play	Min Temperature	-15 °C	
Axial Load	Magnet Type	Max Winding Temp	130 °C	
Press Fit Force - Max	Bearing Type	Mass	18.0 grams	
Gearbox Options	Metal Planetary Gearbox. 12 mm diameter.			
Encoder Options				
Options - Other	Winding Changes. Lead length and connectors. Shaft Length and flat options. POM Pinions.			

Global Motion Products
 Distributed by:
 Precision Motion Distributors: (925) 803-9565
 Technical Support: (760) 451-2723
<http://www.gmpwebsite.com> Email: info@gmpwebsite.com

Commutation Type: **Manufactured under a Certified ISO 9001 Quality System and ISO 14001 Environmental Management System.**
 Electronic - Sensorless

RoHS Compliant

Preliminary - November Specifications Subject to change without notice

BLDC Slotless Motor - 12 mm Ø
B12E07SG000 - - - 7.4 Volts
Peak Output Power: 13 Watts

B12E07SG000

Voltage: 7.4 Volts
 No Load Speed: 27000 rpm
 No Load Current: 0.22 Amps
 Terminal Resistance: 1 Ohms
 Stall Torque: 18.79 mNm
 Torque Constant: 2.54 mNm/A
 Peak Output Power: 13.3 Watts
 Peak Efficiency: 70.6%
 Stall Current: 7.4 Amps
 Max Winding Temp: 130 °C

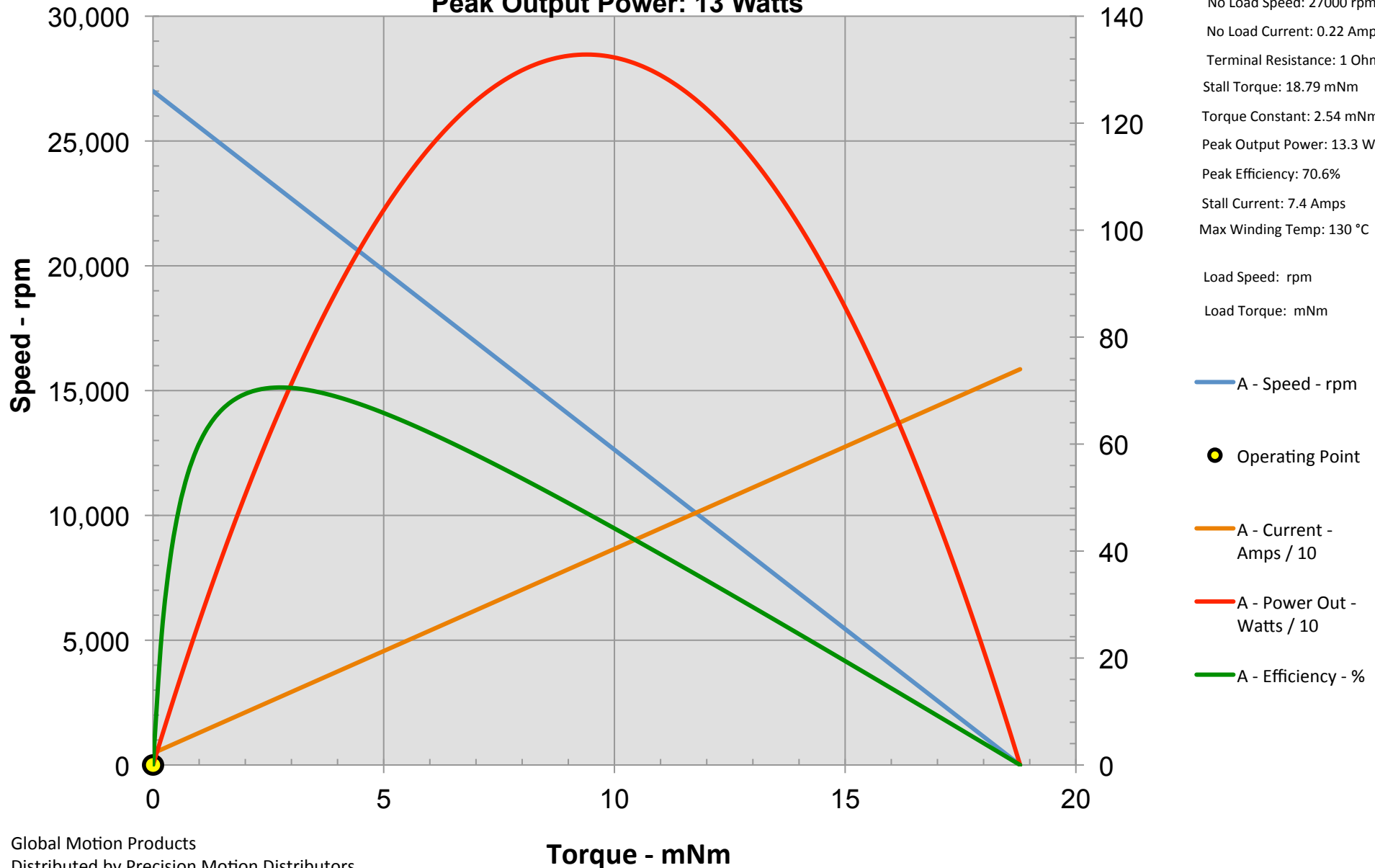

Global Motion Products
 Distributed by Precision Motion Distributors
 (760) 451-2723, (925) 803-9565
<http://www.gmpwebsite.com>
 Email: info@gmpwebsite.com

This Graph is provided free of charge and without any representations or warranties, express or implied, as to its suitability, legal effect, completeness, currentness, accuracy, and appropriateness. The simulation is with Nominal Values. The Graph is provided "as is", "as available", and with "all faults" and we disclaim any warranties, including but not limited to the motor or gearmotor's warranties of merchantability and fitness for a particular purpose. This Graph may be inappropriate for your particular circumstances. This is a simple mathematical simulation of a speed/torque curve for information purposes only.

IT IS NOT TEST DATA. Stall Torque ignores motor coulomb and viscous torque losses. Voltage divided by Resistance multiplied by Torque Constant equals Stall Torque for motor only simulations. **CAUTION:** Peak Output Power is NOT a RATING. This is merely a calculated value and does not address Thermal Issues.

November 30, 2012

© Copyright 2012 George A. Beauchemin, All Rights Reserved

BLDC Slotless Motor - 12 mm Ø

B12E09SG000

7.9 Watts Peak Power



Global Motion Products

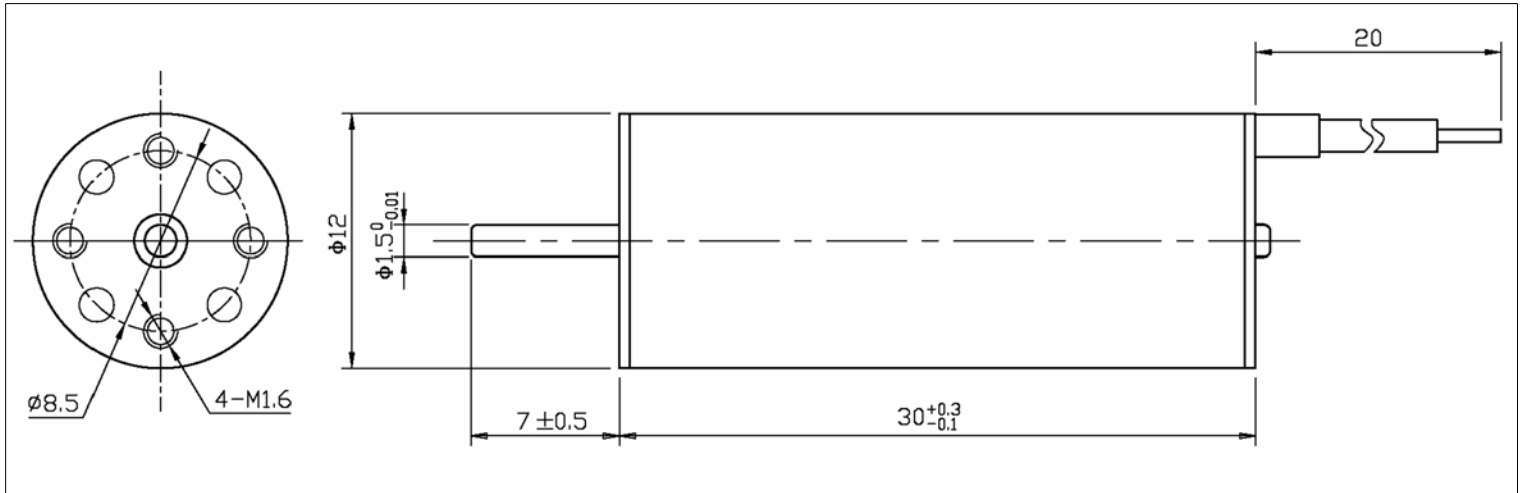

Not to Scale - Dimensions in millimeters (mm)

Nominal Voltage	9.0 Volts	9.0 Volts	9.0 Volts
No-Load Speed	18,000 rpm	18,000 rpm	18,000 rpm
Stall Torque	17.3 mNm	176.0 gcm	2.45 oz-in
No-Load Current	0.130 Amps	0.130 Amps	0.130 Amps
Peak Output Power	7.9 Watts	7.9 Watts	7.9 Watts
Torque Constant	4.61 mNm/A	47.00 gcm/A	0.65 oz-in/A
Terminal Resistance	2.40 Ohms	2.40 Ohms	2.40 Ohms
Back-EMF Constant	0.48 V/krpm	0.48 V/krpm	0.48 V/krpm
Inductance			
Rotor Inertia	0.220 kg-m ² x10 ⁻⁷	0.220 gm cm ²	0.031 x10 ⁻⁴ oz in sec ²
Mechanical Time Constant	2.5 msec	2.5 msec	2.5 msec
Slope of Speed/Torque Curve	1,041.4 rpm/mNm	102.3 rpm/gcm	7,354.0 rpm/oz-in
Speed Constant	2,072 rpm/Volt	2,072 rpm/Volt	2,072 rpm/Volt
Motor Constant	2.98 mNm/√Watt	30.34 gcm/√Watt	0.42 oz-in/√Watt

Zero Cogging High Speed Capable 3 Phase Brushless DC Motor featuring Neodymium Iron Boron Magnets.

Part Number:	How to Order	B12E09SG000	Characteristics - Specifications at	22 °C
Radial Load Rating	Radial Play		Max Temperature	45 °C
Radial Load Distance	Thrust Play		Min Temperature	-15 °C
Axial Load	Magnet Type	NdFeB	Max Winding Temp	130 °C
Press Fit Force - Max	Bearing Type	Sleeve Bearings	Mass	18.0 grams
Gearbox Options	Metal Planetary Gearbox. 12 mm diameter.			
Encoder Options				
Options - Other	Winding Changes. Lead length and connectors. Shaft Length and flat options. POM Pinions.			

Global Motion Products
 Distributed by:
 Precision Motion Distributors: (925) 803-9565
 Technical Support: (760) 451-2723
<http://www.gmpwebsite.com> Email: info@gmpwebsite.com

Commutation Type: **Manufactured under a Certified ISO 9001 Quality System and ISO 14001 Environmental Management System.**
 Electronic - Sensorless

RoHS Compliant

Preliminary - November Specifications Subject to change without notice

BLDC Slotless Motor - 12 mm Ø
B12E09SG000 - - - 9 Volts
Peak Output Power: 8.15 Watts

B12E09SG000

Voltage: 9 Volts
 No Load Speed: 18000 rpm
 No Load Current: 0.13 Amps
 Terminal Resistance: 2.4 Ohm
 Stall Torque: 17.28 mNm
 Torque Constant: 4.61 mNm/A
 Peak Output Power: 8.15 Watts
 Peak Efficiency: 68.6%
 Stall Current: 3.75 Amps
 Max Winding Temp: 130 °C

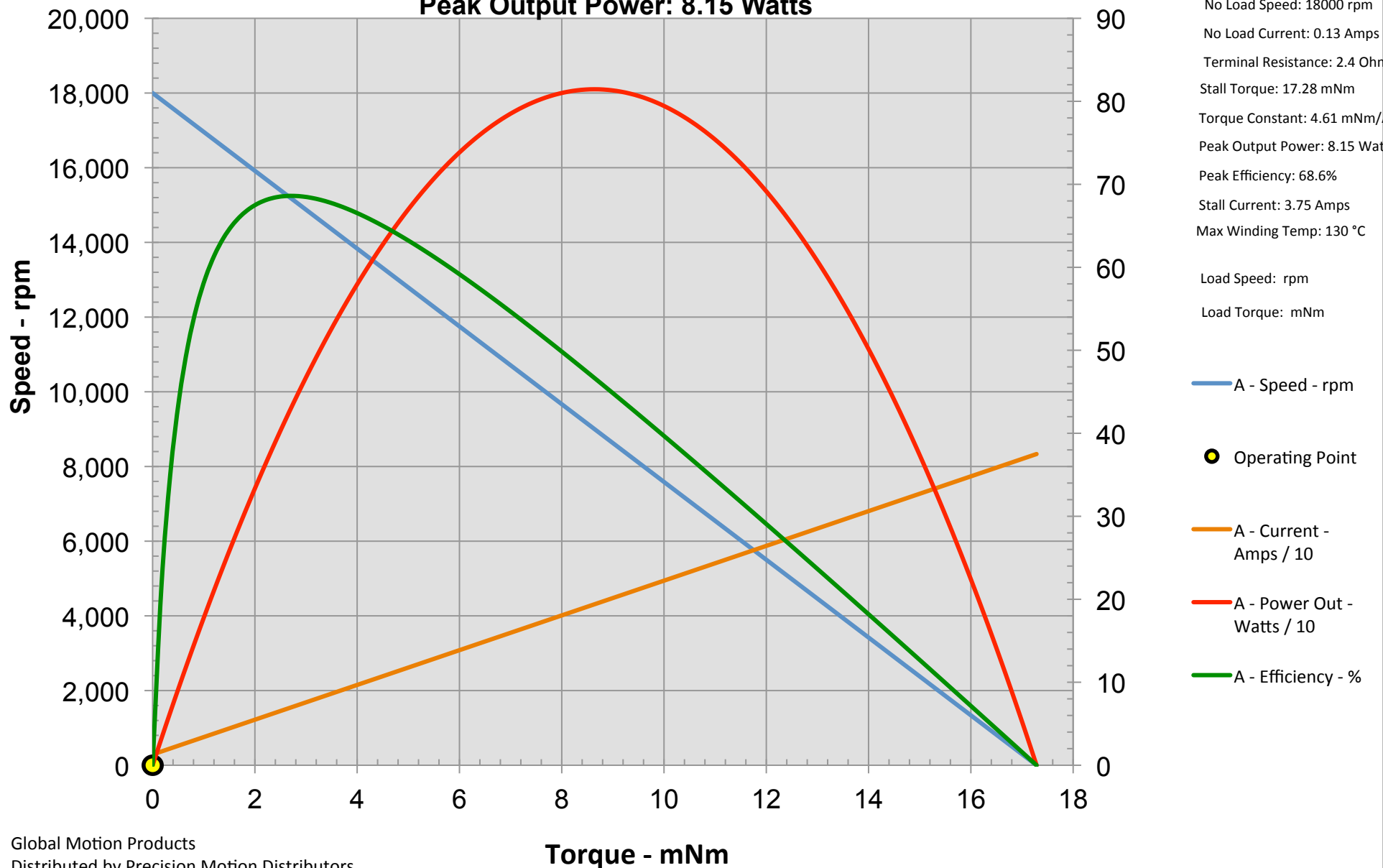

Global Motion Products
 Distributed by Precision Motion Distributors
 (760) 451-2723, (925) 803-9565
<http://www.gmpwebsite.com>
 Email: info@gmpwebsite.com

This Graph is provided free of charge and without any representations or warranties, express or implied, as to its suitability, legal effect, completeness, currentness, accuracy, and appropriateness. The simulation is with Nominal Values. The Graph is provided "as is", "as available", and with "all faults" and we disclaim any warranties, including but not limited to the motor or gearmotor's warranties of merchantability and fitness for a particular purpose. This Graph may be inappropriate for your particular circumstances. This is a simple mathematical simulation of a speed/torque curve for information purposes only.

IT IS NOT TEST DATA. Stall Torque ignores motor coulomb and viscous torque losses. Voltage divided by Resistance multiplied by Torque Constant equals Stall Torque for motor only simulations. **CAUTION:** Peak Output Power is NOT a RATING. This is merely a calculated value and does not address Thermal Issues.

November 30, 2012

© Copyright 2012 George A. Beauchemin, All Rights Reserved