

Planetary Gearbox - 38 mm Ø

All Metal - Sleeve Bearings - 2.9 Nm Continuous

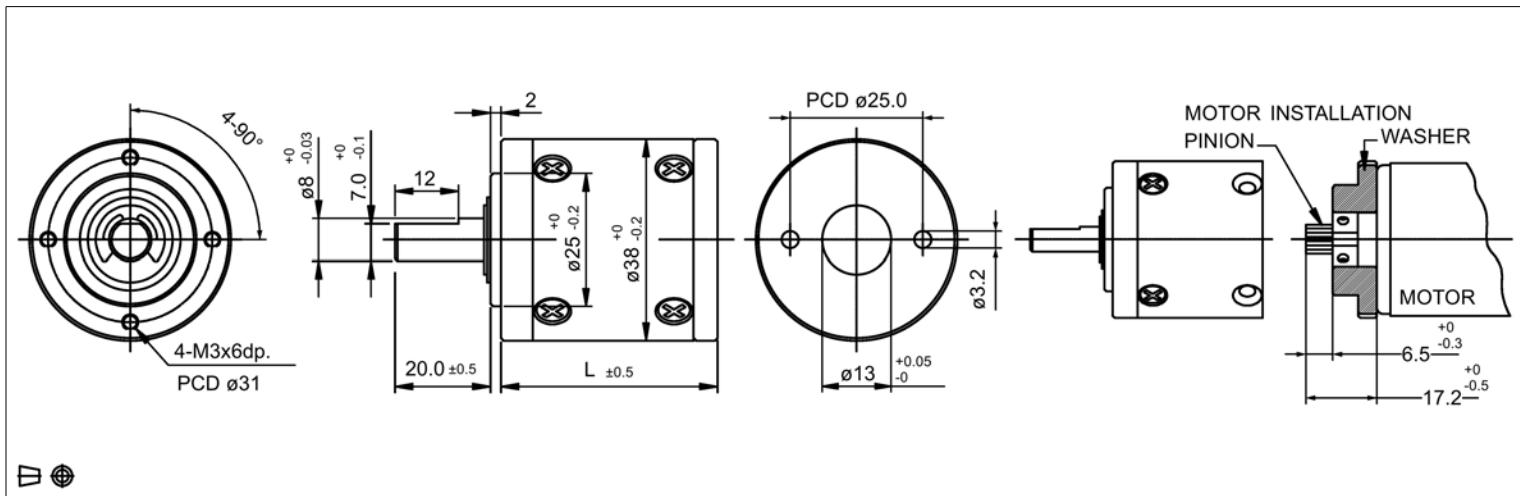

Global Motion Products



Not to Scale - Dimensions in millimeters (mm)

Ratio	Efficiency %	Continuous Torque Nm	Continuous Torque oz-in	Length L mm	Mass grams	Direction of Rotation*	Order Part Number
3.71:1	80 %	0.29 Nm	41.7 oz-in	33.10	147.0	Same	P380004AS00
5.18:1	80 %	0.29 Nm	41.7 oz-in	33.10	147.0	Same	P380005AS00
13.73:1	70 %	0.78 Nm	111.1 oz-in	41.80	195.0	Same	P380014AS00
19.20:1	70 %	0.78 Nm	111.1 oz-in	41.80	195.0	Same	P380019AS00
26.85:1	70 %	0.98 Nm	138.9 oz-in	41.80	195.0	Same	P380027AS00
50.89:1	70 %	1.77 Nm	250.0 oz-in	50.50	243.0	Same	P380051AS00
71.16:1	60 %	1.96 Nm	277.7 oz-in	50.50	243.0	Same	P380071AS00
99.51:1	60 %	1.96 Nm	277.7 oz-in	50.50	243.0	Same	P380100AS00
139.14:1	60 %	1.96 Nm	277.7 oz-in	59.20	243.0	Same	P380139AS00
188.61:1	50 %	2.45 Nm	347.2 oz-in	59.20	291.0	Same	P380189AS00
263.73:1	50 %	2.45 Nm	347.2 oz-in	59.20	291.0	Same	P380264AS00
515.63:1	50 %	2.94 Nm	416.6 oz-in	59.20	291.0	Same	P380516AS00
720.99:1	50 %	2.94 Nm	416.6 oz-in	59.20	291.0	Same	P380721AS00

Radial Load Rating	≤ 49.0 N	Radial Play	≤ 0.08 mm	Max Temperature Operating	60°C
Radial Load Distance	10 mm	Axial Play	≤ 0.30 mm	Min Temperature Operating	-10°C
Axial Load	≤ 29.4 N	Backlash	≤ 3.0 °	Relative Humidity Operating	20% to 85%
Press Fit Force - Max	≤ 147.1 N	Bearing	Sleeve	Characteristics and Specifications at 22°C	

The P38 is available as a complete gearmotor with Low Cost Iron Core dc motors, Brushless DC Motors, or Integral Electronics Brushless DC Motors. GMP offers gearboxes and gearmotors from 6 mm diameter to 90 mm Plus.

Options: Ball or Sleeve Bearings. Configurable for Customer Supplied or Specified Motors. Lubrication options. 16 Watt Iron Core DC motor available as a factory assembled option, with optional magnetic encoder. Brushless DC slotless 58 Watt Motor also offered.

* Rotational Sense of Gearbox Output Shaft to Motor Shaft

Global Motion Products
 Distributed by:
 Precision Motion Distributors: (925) 803-9565
 Technical Support: (760) 451-2723
<http://www.gmpwebsite.com> Email: info@gmpwebsite.com

Manufactured under a Certified ISO
 9001 Quality System and ISO 14001
 Environmental Management System.

RoHS Compliant