

Planetary Gearbox - 62 mm Ø

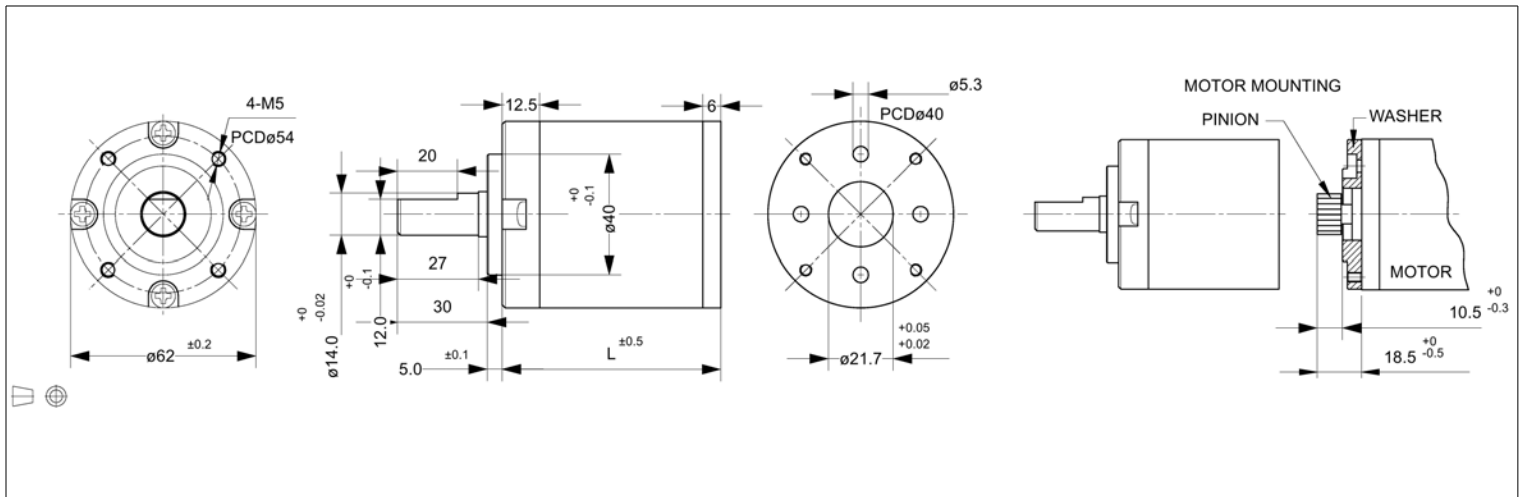

Global Motion Products

Value Series - Ball Bearings Standard



Not to Scale - Dimensions in millimeters (mm)

Ratio	Efficiency %	Continuous Torque mNm	Momentary Torque mNm	Length L mm	Mass grams	Direction of Rotation*	Order Part Number
3.50:1	80 %	1.47 Nm	4.41 Nm	43.60	670.0	Same	P620003AB00
4.33:1	80 %	1.47 Nm	4.41 Nm	43.60	670.0	Same	P620004AB00
12.25:1	70 %	4.90 Nm	14.71 Nm	59.10	940.0	Same	P620012AB00
15.17:1	70 %	4.90 Nm	14.71 Nm	59.10	940.0	Same	P620015AB00
18.88:1	70 %	4.90 Nm	14.71 Nm	59.10	940.0	Same	P620019AB00
42.88:1	60 %	9.81 Nm	29.42 Nm	74.60	1,220.0	Same	P620043AB00
53.08:1	60 %	9.81 Nm	29.42 Nm	74.60	1,220.0	Same	P620053AB00
65.72:1	60 %	9.81 Nm	29.42 Nm	74.60	1,220.0	Same	P620066AB00
81.37:1	60 %	9.81 Nm	29.42 Nm	74.60	1,220.0	Same	P620081AB00
100.29:1	60 %	9.81 Nm	29.42 Nm	74.60	1,220.0	Same	P620100AB00
112.67:1	60 %	9.81 Nm	29.42 Nm	74.60	1,220.0	Same	P620113AB00
150.06:1	50 %	9.81 Nm	29.42 Nm	90.10	1,500.0	Same	P620150AB00
230.03:1	50 %	9.81 Nm	29.42 Nm	90.10	1,500.0	Same	P620230AB00
284.80:1	50 %	9.81 Nm	29.42 Nm	90.10	1,500.0	Same	P620285AB00

Radial Load Rating ≤ 245.2 N
 Radial Load Distance 10 mm
 Axial Load ≤ 98.1 N
 Press Fit Force - Max ≤ 490.3 N

Radial Play ≤ 0.08 mm
 Axial Play ≤ 0.40 mm
 Backlash ≤ 3.0 °

Max Temperature Operating 60°C
 Min Temperature Operating -10°C
 Relative Humidity Operating 20% to 85%
 Bearing Ball

The P62 is available as a complete gearmotor with iron core, coreless, or brushless dc motors.

Options
 Lubrication, Gear Materials and Gear Heat Treatment. Coreless, Brushless and Iron Core DC Motors with encoder options. Client specified gear/pulley/sprocket mounting to gearbox output shaft.

GMP offers gearboxes and gearmotors from 6 mm diameter to 90 mm Plus.

* Rotational Sense of Gearbox Output Shaft to Motor Shaft

Global Motion Products
 Distributed by:
 Precision Motion Distributors: (925) 803-9565
 Technical Support: (760) 451-2723
<http://www.gmpwebsite.com> Email: info@gmpwebsite.com

Manufactured under a Certified ISO 9001:2008 Quality System and ISO 14001:2004 Environmental

RoHS Compliant

Planetary Gearbox - 62 mm Ø



Global Motion Products

Value Series - Ball Bearings Standard

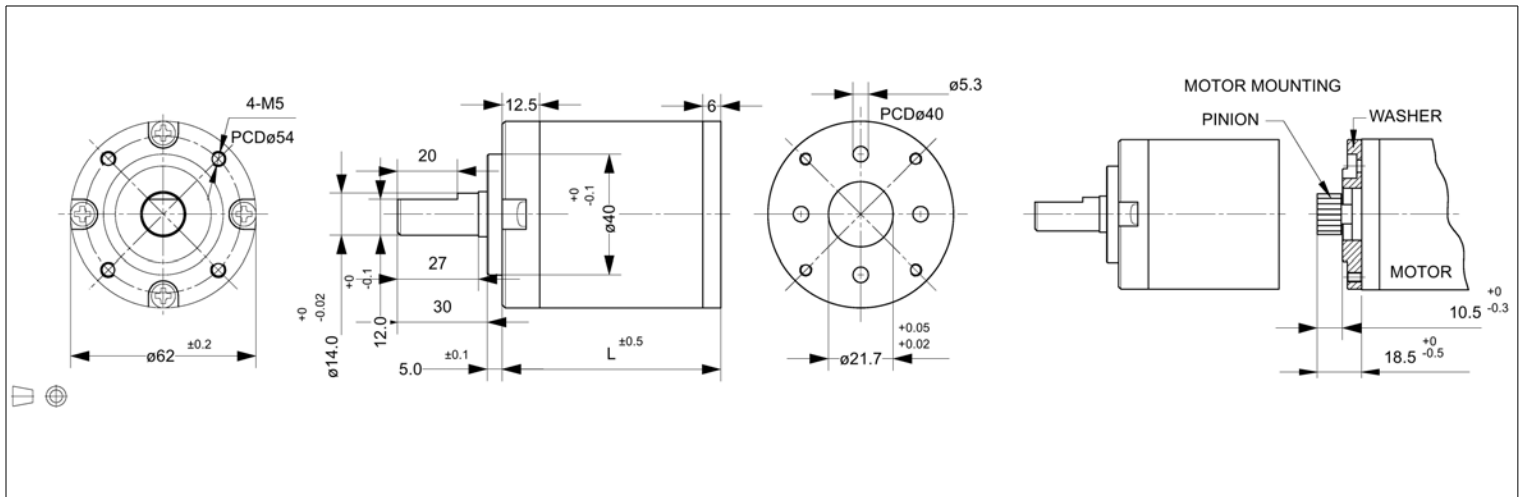

Not to Scale - Dimensions in millimeters (mm)

Ratio	Efficiency %	Continuous Torque mNm	Momentary Torque mNm	Length L mm	Mass grams	Direction of Rotation*	Order Part Number
352.60:1	50 %	9.81 Nm	29.42 Nm	90.10	1,500.0	Same	P620353AB00
488.22:1	50 %	9.81 Nm	29.42 Nm	90.10	1,500.0	Same	P620488AB00
546.00:1	50 %	9.81 Nm	29.42 Nm	90.10	1,500.0	Same	P620546AB00
676.00:1	50 %	9.81 Nm	29.42 Nm	90.10	1,500.0	Same	P620676AB00

Radial Load Rating	≤ 245.2 N	Radial Play	≤ 0.08 mm	Max Temperature Operating	60°C
Radial Load Distance	10 mm	Axial Play	≤ 0.40 mm	Min Temperature Operating	-10°C
Axial Load	≤ 98.1 N	Backlash	≤ 3.0 °	Relative Humidity Operating	20% to 85%
Press Fit Force - Max	≤ 490.3 N			Bearing	Ball

The P62 is available as a complete gearmotor with iron core, coreless, or brushless dc motors.

Options
 Lubrication, Gear Materials and Gear Heat Treatment. Coreless, Brushless and Iron Core DC Motors with encoder options. Client specified gear/pulley/sprocket mounting to gearbox output shaft.

GMP offers gearboxes and gearmotors from 6 mm diameter to 90 mm Plus.

* Rotational Sense of Gearbox Output Shaft to Motor Shaft

Global Motion Products
 Distributed by:
 Precision Motion Distributors: (925) 803-9565
 Technical Support: (760) 451-2723
<http://www.gmpwebsite.com> Email: info@gmpwebsite.com

Manufactured under a Certified ISO
 9001:2008 Quality System and ISO
 14001:2004 Environmental

RoHS Compliant